

RESOLUTION NO. 23-R-_____

A RESOLUTION OF THE BOARD OF COUNTY COMMISSIONERS OF MARION COUNTY, FLORIDA, TO SUPPORT THE SHORT WATER LINE EXTENSION PROGRAM; PROVIDING CERTAIN FINDINGS AND AUTHORITY; ESTABLISHING THE SHORT WATER LINE EXTENSION PROGRAM SERVICE AREA; ESTABLISHING ONE-TIME CAPITAL CONNECTION FEE FOR THE SERVICE AREA; AND PROVIDING AN EFFECTIVE DATE.

WHEREAS, on August 17, 2021, the Board of County Commissioners of Marion County, Florida (the “Board”) approved a list of proposed projects and expenditures from the ARPA funds, including \$5 million for the development and execution of a Short Water Line Extension Program (“the Program”) providing subsidies for qualified applicants seeking water line extensions on a first-come, first-served basis; and

WHEREAS, on October 18, 2022, the Board approved Ordinance No. 22-43, which among other things, established the basic requirements for the Program; and

WHEREAS, while the ARPA funds will provide the initial seed money for the Program, it is anticipated that lots not yet connected to the System will pay a one-time Capital Connection Fee to fund its portion of the water line extension and those monies will be reinvested into the Program to enable future connections; and

WHEREAS, a developed lot is considered to be occupied, have its final inspection or certificate of occupancy, and may be improved by the Program but not yet connected to the System, subject to the Capital Connection Fee; and

WHEREAS, the Program requires the Board to establish, by Resolution, a one-time Capital Connection Fee establishing a pro-rata share for parcels connecting single family residences participating in the Program and the payment terms and conditions applicable thereto, which may include differing fees for developed and undeveloped lots and differing fees based on the cost and distance of required extensions; and

WHEREAS, on October 18, 2022, during a public hearing, the Board provided direction to consider a cap to the Capital Connection Fee per property, subject to review and change through each Resolution; and

WHEREAS, property owner (“Owner”) qualifies for, and has submitted a completed application to support its participation in the Program, herein attached as **Exhibit A**; and

WHEREAS, the Capital Connection Fee will be reinvested in the Program to help pay costs of the water line extension program and it is anticipated that the Capital Connection Fee will be determined by apportioning the actual cost of the water line extension among all lots to be served by the water line extension on a pro rata basis; and

WHEREAS, the Board desires to establish discrete geographical area(s) of unincorporated Marion County designated by Board resolution as "Short Water Main Extension Program Service Areas," where funding is available to cover the water main extension cost; and

NOW, THEREFORE, BE IT RESOLVED by the Board of County Commissioners of Marion County, Florida:

SECTION 1. RECITALS. The above recitals are true and correct and are hereby incorporated herein by reference.

SECTION 2. AUTHORITY. This resolution is adopted pursuant to the provisions of Chapter 19 – Water and Sewers, Article III. – Water and Wastewater Facilities, Division 5. – Short Water Line Extension Program, of the Code of Ordinances of Marion County, Florida.

SECTION 3. ESTABLISH THE SHORT WATER LINE EXTENSION PROGRAM SERVICE AREA. Pursuant to Section 19-218, the Board hereby designates the following Short Water Line Extension Program Service Area:

Parcels **#8009-1205-42, 8009-1205-43, 8009-1205-44** and surrounding improved parcels of the water main extension herein attached as **Exhibit B**. Sketch is for reference purposes only and supports professionally engineered Issued for Construction (“IFC”) plans on file with County.

SECTION 4. ESTABLISHING ONE-TIME CAPITAL CONNECTION FEE.

(A) Pursuant to Section 19-217, the one-time Capital Connection Fee will be determined by apportioning the actual cost of this water line extension work using County’s bid pricing, herein attached as **Exhibit C** to be served by the water line extension designed

in Exhibit B. In no case shall the pro rata fee be more than five thousand (\$5,000.00) dollars per lot. It is further noted that additional fees may include:

1. Each qualifying applicant will additionally be responsible the cost of all On-site facilities as defined in Section 19-122.
2. The applicant must pay all applicable costs and fees for the requested short water line extension which may include, without limitation, tap fees and system development fees as required by the County. All costs and fees are due in accordance with Section 19-217(c) and the County's existing utility regulations.
3. The short water line extension is subject to all applicable federal, state, and local permits and requirements and any required encroachments

(B) The Capital Connection Fee for this Short Water Line Extension Program Service Area Project is \$4,313.68 per lot.

SECTION 4. EFFECTIVE DATE. This Resolution shall become effective immediately upon its adoption.

DULY ADOPTED in regular session this ____ day of _____, 2023.

**BOARD OF COUNTY
COMMISSIONERS
OF MARION COUNTY, FLORIDA**

Craig Curry, Chairman

ATTEST:

Gregory C. Harrell, Clerk

FOR THE USE AND RELIANCE OF
MARION COUNTY ONLY.
APPROVED AS TO FORM AND
LEGAL SUFFICIENCY:



Matthew Minter, County Attorney



Marion County Utilities ("MCU") Short Water Line Extension Program Application and Agreement

Parcel Owner Name Next Dimension Builders Phone 352 646-6475
Parcel ID 2023020943 Email Address info@nextdimensionbuilders.com

By submitting this Application and Agreement ("Application"), I affirm that I have read, understood and agree to be bound by all provisions of the Marion County Code of Ordinances ("County Code") and Land Development Code, portions of which are highlighted below, and I herein apply to participate in the Short Water Line Extension Program (the "Program") set forth in Chapter 19, Article III, Division 5 of the Marion County Code, all Codes being available to me at: https://library.municode.com/fl/marion_county. I understand that acceptance by the County of this Application is made by its adoption of a Resolution associated with the subject extension. Upon passage of the Resolution, this Application is considered a binding agreement upon me, and a breach is subject to the legal remedies provided by law, including the retention of fees paid as liquidated damages and/or a lien on the Parcel.

Parcels eligible for the Program must:

1. Be listed in the undersigned's name in the Marion County Property Appraiser's records and if the Parcel Owner is an entity, the entity must be in ACTIVE status with the Florida Department of Corporations; **AND**
2. Be at least 50' but not farther than 500' from a validated MCU water line; **AND**
3. Be within a service area designated in accordance with Section 19-218 of the Marion County Code; **AND**
4. Provide domestic water service to a Single Family Residence that:
 - a. Is onsite and served by a private well; **OR**
 - b. Is vacant and in an active building permit status issued outside the subdivision development process.

In accordance with the Program, I affirm:

1. That both the undersigned and the Parcel meet the conditions of the Program, including the water connection requirements under Land Development Code 6.14.2(B); **AND**
2. Under penalty of having my building permit placed on an inspection hold, I will submit the items below to MCU within 30 days of notification of the County's adoption of this extension's Resolution:
 - a. A new water utility account service agreement with an MCU Billing Specialist; **AND**
 - b. Payment of all applicable connection fees; **AND**
 - c. Payment of the Parcel's calculated capital connection charge based on MCU's design.

I understand: (a) the Program is available on a first-come, first-served basis to applicants with a complete application; (b) final-designed water line extension length is at MCU's sole discretion; (c) the Parcel must be accessible by a publicly maintained right-of-way to serve the water line extension installation; (d) all onsite costs are my responsibility; (e) MCU, in its sole discretion, may cancel the extension Application due to insufficient funds or other reasonable circumstances, and if cancelled, all unused costs paid by the undersigned for this Application will be refunded; and (f) each extension project's capital connection costs are determined on an individual basis; costs associated with this Application are not an indicator of costs for any other parcel(s).

ACCEPTED AND AGREED TO BY OWNER:

OWNER: [Signature] WITNESS: [Signature]
Printed: Blaine Villarreal Date 2-9-23 Printed: Talia Cutler Date 2-9-23

STATE OF Florida, COUNTY OF Marion
This document was acknowledged before me by means of physical presence or online notarization this 9 day of February, 2023 by Blaine Villarreal as President MCU for Next Dimension Builders, the party on whose behalf this Application is executed.

NOTARY SEAL

☒ personally known to me or who produced ID (type #)



JOSEPH TALLARICO
Commission # HH 199246
Expires January 23, 2026

[Signature]
Signature of Notary Public

COUNTY USE ONLY BELOW THIS LINE

existing SFR with well – OR – Active Building Permit # 2023020943
property appraiser validation ownership
sunbiz active status 0 (220' required extension per Code)
connection distance linear feet to closest corner

PROJECT ID# SWL-047 RECEIVED BY: Amanda Nicks DATE 2/9/2023

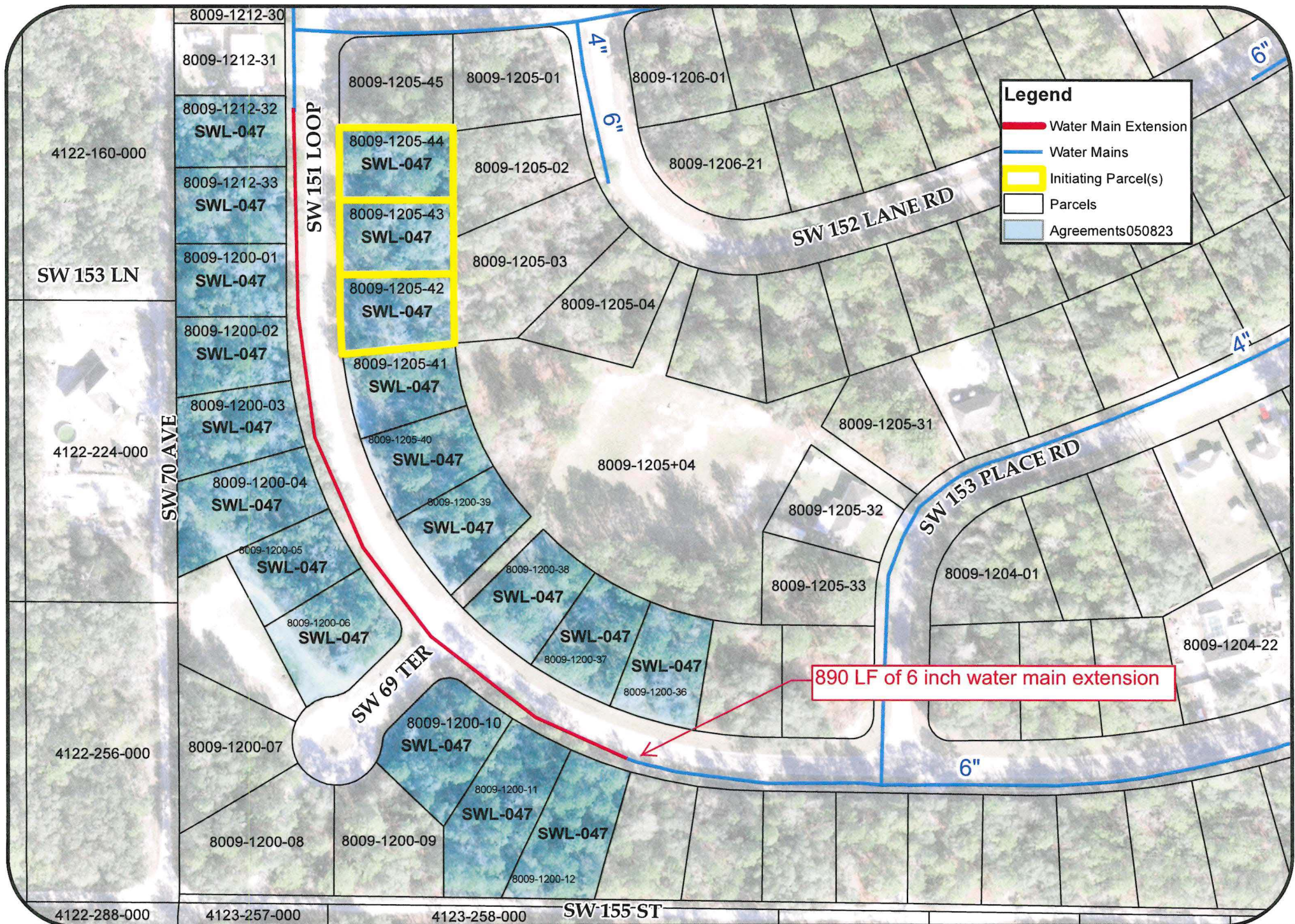

Legend

- Water Main Extension
- Water Mains
- Initiating Parcel(s)
- Parcels
- Agreements050823

890 LF of 6 inch water main extension

EXHIBIT C

PART 1 - LINE EXTENSION APPLICANT INFO

All bid pricing expires 9/30/27; for projects not accepted, new calculations will be required based on MCU's new bid pricing.

Line Extension #	SWL-047	3	Initiating number of parcels
Initiating Parcel#	8009-1205-42	17	Resulting benefitting lots
Applicant Name	Next Dimension Builders, LLC	^ REFER TO SITE MAP TAB TO VALIDATE	
Length of extension (ft)	890		
Diameter of main (in)	6		
		LOCATE:	

PART 2 - BID FORM

ITEM	DESCRIPTION	Final Cost		T&C	GWP	CIC
		QTY	UNIT	EXT	EXT	EXT
1.01	Mobilization and Demobilization	1	LS	\$ 2,700.00	\$ 8,523.00	\$ 10,000.00
2.01	Water Main Pressure Testing & Bac-T testing (2 Bac-T tests per project)	1	LS	\$ 1,800.00	\$ 2,200.00	\$ 1,500.00
3.09	6" PVC C900 DR 18 (201 ft and more)	810	LF	\$ 27,540.00	\$ 37,908.00	\$ 34,830.00
4.04	Directional Drill 6" PVC C900 DR 18 (61 ft or more)	80	LF	\$ 7,600.00	\$ 10,240.00	\$ 11,440.00
5.01	4" Gate Valve and Box	1	EA	\$ 1,850.00	\$ 1,393.00	\$ 2,096.00
6.01	Ductile Iron Fittings	56	LBS	\$ 784.00	\$ 39,200.00	\$ 4,760.00
8.01	Short Single Water Service Assembly	1	EA	\$ 1,400.00	\$ 886.00	\$ 1,682.00
8.02	Short Double Service Assembly	4	EA	\$ 8,000.00	\$ 6,208.00	\$ 8,520.00
8.04	Long Double Service Assembly	4	EA	\$ 12,800.00	\$ 10,000.00	\$ 17,312.00
11.01	Silt Fencing	810	LF	\$ 2,835.00	\$ 2,430.00	\$ 2,964.60
13.03	Sod (201 ft or more)	810	LF	\$ 8,910.00	\$ 23,490.00	\$ 4,147.20
21.02	6" Bell Restraint	8	EA	\$ 1,280.00	\$ 1,576.00	\$ 1,904.00
24.01	Fire Hydrant Assembly	1	LS	\$ 8,700.00	\$ 6,881.00	\$ 10,255.00
		Base Construction Costs		\$ 86,199.00	\$ 150,935.00	\$ 111,410.80
Right of Way Permitting Fee (\$30 + \$0.05/LF)		890		\$ 74.50	\$ 74.50	\$ 74.50
		Owner Cost		\$ 86,273.50	\$ 151,009.50	\$ 111,485.30
		Benefitting Parcel Cost (per lot)		\$ 4,313.68	\$ 7,550.48	\$ 5,574.27
		Initiator Parcel Cost (TOTAL)		\$ 12,941.03	\$ 22,651.43	\$ 16,722.80