

IRRIGATION NOTES

- This schematic irrigation plan serves primarily as a guide. The Contractor shall be entirely responsible for proper coverage and operation of the systems, including changes from the plan as necessary to adjust for actual site conditions.
- The Contractor shall be responsible for providing all labor, materials, and accessories required for complete irrigation systems meeting the performance requirements outlined herein.
- All work shall be installed in accordance with the regulations of the local, county, or other governing authorities. Fees for all permits, inspections, and impact fees required shall be included as work required.
- The water source shall be well water. Design data shall be verified by the Contractor prior to installation.
- A rain sensor device, Mini-Click II, or approved equal, shall be installed for each controller installed.
- All remote control valves, gate valves, ball valves, hose bibs and wire splices shall be installed in a suitable Ametek-type valve box of proper size as required for easy access to the valve. Valve boxes shall have a sump of 1" of gravel. Valve boxes shall be set flush and sloped with the surrounding grade.
- All PVC pipe in the system less than 2" O.D. except risers, shall be Class 160 PSI Polyvinyl Chloride solvent weld pipe conforming to the ASTM-D2466, Type 1, requirements, NSF approved.
- All PVC pipe in the system greater or equal to 2" O.D. and fittings shall be Schedule 40, Type 1, NSF approved conforming to the ASTM-D2466 requirements.
- All wiring, if required, shall be U.L. U.F. wiring. A separate power wire shall be installed from the controller to each individual valve. Wiring shall be installed with main lines where possible; when not, it shall be installed in conduit. Waterproof wire connectors shall be used for controller wiring. Provide pressure compensating devices as necessary to reduce misting.
- Verify the presence of all sleeving before commencing work. Where piping must pass under existing concrete or pavement, it shall be jacked or jetted where possible. Only if impossible to get in place without cutting pavement, permission will be given by the Owner to cut paving. If this is necessary, all cutting and replacing of the paving to match the existing shall be included under this section of the specifications.
- All PVC piping and wiring shall be installed in the trenches with a minimum of 12" of cover and a maximum depth of 24", except where specific permission is obtained from the Landscape Architect and/or Owner for less cover due to existing conditions. Where necessary because of landscaping, cover shall be as deep as required.
- All flex pipe shall be buried to a depth of at least 4" (or covered with 3" of mulch) except where the tubing daylight's over newly planted rootballs.
- All emitters and flood bubblers shall be installed at the rootball and be minimally visible above the mulch.
- The Contractor shall warrant the installation workmanship for a period of one year from date of job completion and retainage release. The Contractor shall further see to the fulfillment of all manufacturer's warranties and shall provide an Owner's Manuals. A reproducible as-built coded from the original showing all dimensional system components shall be required for final job acceptance.
- Irrigation System to include backflow device. Rainensor to be installed at controller.

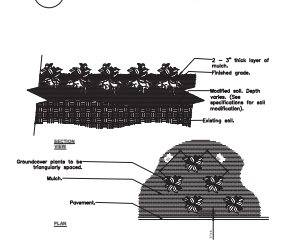
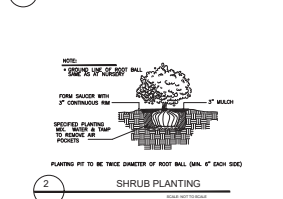
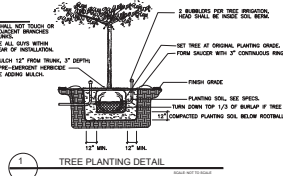

LANDSCAPE NOTES

- All plants shall be Florida No. 1 or better, as outlined under Grades and Standards for Nursery Plants, Division of Plant Industries, State of Florida, latest edition.
- All work shall be performed in accordance with standard and accepted nursery practices in a workmanlike manner.
- The Landscape Contractor shall be responsible for finish grading all areas of the site. Rough grade will be within 2" of finish grade. The Landscape Contractor shall be responsible for any grade disturbed by his work.
- The Landscape Contractor shall be responsible for the thorough removal of existing weeds and grass in the areas to be planted, including application(s) of appropriate herbicides before and after plant installation.
- Soil used for planting shall consist of two parts of the existing soil and one part domestic peat moss (or sandy fill in heavy soils), mixed with two lbs. fertilizer per cubic yard. Fertilizer shall be SLOW RELEASE for new plantings.
- Terra-Sorb, or approved equal, shall be incorporated into the planting soil of all trees in sandy soils only at the following rates:
 15 gallon containers = one (3 oz.) Handy Pac
 30 gallon containers = two (3 oz.) Handy Pacs
 Up to 3" caliper = one (3 oz.) Handy Pac
 4" to 5" caliper = two (3 oz.) Handy Pacs
 Broadcast 1/2 throughout the planting pit; mix 1/2 with backfill.
 All plant beds shall be top-dressed with 4" of pine bark nuggets.
- The Landscape Architect reserves the right to field locate or review flagged locations of any or all plant material.
- All balled and burlapped trees shall be hardened-off at the supplier's for a minimum of 30 days prior to shipping. All suppliers must be approved by the Landscape Architect prior to delivery and installation of the trees; any tree which shows signs of stress shall be replaced immediately at no charge to the Owner.
- All trees will be staked per detail sheet or by another method approved by the Landscape Architect. Mulched tree rings shall encompass guys.
- No substitutions shall be permitted without prior approval from the Landscape Architect.
- Maintain minimum 12 inches mulch clearance from trunk of trees.
- Guaranty (from time of job completion and retainage release):
 Trees and shrubs = 1 year

Old Pressure (psi)	New Pressure (psi)	Old Spacing (ft)	New Spacing (ft)
20	15	12	18
30	20	18	24
40	30	24	30
50	40	30	36
60	50	36	42

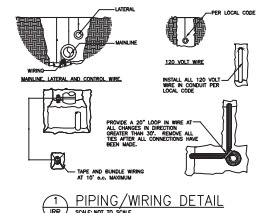
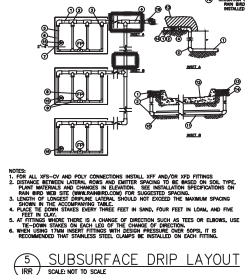
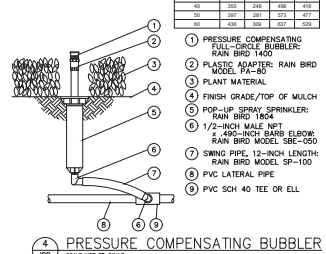

APPROVALS

ELIZABETH HOOK
 LANDSCAPE ARCHITECTURE, LLC
 11000 W. BAYHURST BLVD., SUITE 100
 DUBLIN, FLORIDA 32008-1000
 TEL: 407-277-1100
 FAX: 407-277-1101
 E: EHOOK@ELIZABETHHOOK.COM

ALIEN ENGINEERED PRODUCTS
 14524-14525-14526-14527-14528-14529-14530-14531-14532-14533-14534-14535-14536-14537-14538-14539-14540-14541-14542-14543-14544-14545-14546-14547-14548-14549-14550-14551-14552-14553-14554-14555-14556-14557-14558-14559-14560-14561-14562-14563-14564-14565-14566-14567-14568-14569-14570-14571-14572-14573-14574-14575-14576-14577-14578-14579-14580-14581-14582-14583-14584-14585-14586-14587-14588-14589-14590-14591-14592-14593-14594-14595-14596-14597-14598-14599-14600-14601-14602-14603-14604-14605-14606-14607-14608-14609-14610-14611-14612-14613-14614-14615-14616-14617-14618-14619-14620-14621-14622-14623-14624-14625-14626-14627-14628-14629-14630-14631-14632-14633-14634-14635-14636-14637-14638-14639-14640-14641-14642-14643-14644-14645-14646-14647-14648-14649-14650-14651-14652-14653-14654-14655-14656-14657-14658-14659-14660-14661-14662-14663-14664-14665-14666-14667-14668-14669-14670-14671-14672-14673-14674-14675-14676-14677-14678-14679-14680-14681-14682-14683-14684-14685-14686-14687-14688-14689-14690-14691-14692-14693-14694-14695-14696-14697-14698-14699-14700-14701-14702-14703-14704-14705-14706-14707-14708-14709-14710-14711-14712-14713-14714-14715-14716-14717-14718-14719-14720-14721-14722-14723-14724-14725-14726-14727-14728-14729-14730-14731-14732-14733-14734-14735-14736-14737-14738-14739-14740-14741-14742-14743-14744-14745-14746-14747-14748-14749-14750-14751-14752-14753-14754-14755-14756-14757-14758-14759-14760-14761-14762-14763-14764-14765-14766-14767-14768-14769-14770-14771-14772-14773-14774-14775-14776-14777-14778-14779-14780-14781-14782-14783-14784-14785-14786-14787-14788-14789-14790-14791-14792-14793-14794-14795-14796-14797-14798-14799-14800-14801-14802-14803-14804-14805-14806-14807-14808-14809-14810-14811-14812-14813-14814-14815-14816-14817-14818-14819-14820-14821-14822-14823-14824-14825-14826-14827-14828-14829-14830-14831-14832-14833-14834-14835-14836-14837-14838-14839-14840-14841-14842-14843-14844-14845-14846-14847-14848-14849-14850-14851-14852-14853-14854-14855-14856-14857-14858-14859-14860-14861-14862-14863-14864-14865-14866-14867-14868-14869-14870-14871-14872-14873-14874-14875-14876-14877-14878-14879-14880-14881-14882-14883-14884-14885-14886-14887-14888-14889-14890-14891-14892-14893-14894-14895-14896-14897-14898-14899-14900-14901-14902-14903-14904-14905-14906-14907-14908-14909-14910-14911-14912-14913-14914-14915-14916-14917-14918-14919-14920-14921-14922-14923-14924-14925-14926-14927-14928-14929-14930-14931-14932-14933-14934-14935-14936-14937-14938-14939-14940-14941-14942-14943-14944-14945-14946-14947-14948-14949-14950-14951-14952-14953-14954-14955-14956-14957-14958-14959-14960-14961-14962-14963-14964-14965-14966-14967-14968-14969-14970-14971-14972-14973-14974-14975-14976-14977-14978-14979-14980-14981-14982-14983-14984-14985-14986-14987-14988-14989-14990-14991-14992-14993-14994-14995-14996-14997-14998-14999-15000

DRAFT