

EXHIBIT/COMMISSION AFFIDAVIT FILED IN
OFFICIAL RECORD BOOK 1871, PAGE 0243
THIS 18 DAY OF JULY, 1980

EXHIBIT/COMMISSION AFFIDAVIT FILED IN
OFFICIAL RECORD BOOK 1871, PAGE 0243
THIS 18 DAY OF JULY, 1980

PLAT BOOK T PAGE 101

SHEET 1 OF 2 SHEETS

COUNTRYSIDE FARMS OF OCALA

A SUBDIVISION OF LANDS IN SECTIONS 19 AND 20, TOWNSHIP 16 SOUTH, RANGE 21 EAST

MARION COUNTY, FLORIDA

CONSENT OF MORTGAGEE

KNOW ALL MEN BY THESE PRESENTS THAT MARIAN OEHLERKING THE OWNER AND HOLDER OF THAT CERTAIN MORTGAGE DATED April 23, 1979, AND RECORDED IN OFFICIAL RECORDS BOOK 1033, AT PAGE 1880, OF THE PUBLIC RECORDS OF MARION COUNTY, FLORIDA, DOES HEREBY CONSENT TO THIS PLAT AND JOINS IN THE ABOVE DEDICATION.

IN WITNESS WHEREOF I HAVE CAUSED THESE PRESENTS TO BE SIGNED BY WAYNE OEHLERKING AS ATTORNEY-IN-FACT UNDER POWER VESTED IN HIM BY INSTRUMENT RECORDED IN OFFICIAL RECORD BOOK 1034, AT PAGE 76, OF THE PUBLIC RECORDS OF MARION COUNTY, FLORIDA.

WITNESS

By Wayne Oehlerking
WAYNE OEHLERKING
ATTORNEY-IN-FACT

NOTARY ACKNOWLEDGEMENT

STATE OF FLORIDA
COUNTY OF MARION

BEFORE ME THIS DAY PERSONALLY APPEARED WAYNE OEHLERKING TO ME WELL KNOWN TO BE THE PERSON DESCRIBED IN AND WHO EXECUTED THE FOREGOING INSTRUMENT AND WHO ACKNOWLEDGED THAT HE DID SO FREELY AND VOLUNTARILY FOR THE USES AND PURPOSES THEREIN EXPRESSED.

Wayne Oehlerking

DATE 9/16/80

STATE OF FLORIDA AT LARGE - MY COMMISSION EXPIRES 9/16/83

CONSENT OF MORTGAGEE

KNOW ALL MEN BY THESE PRESENTS THAT BARNETT BANK OF OCALA, N.A., A UNITED STATES BANKING CORPORATION, THE OWNER AND HOLDER OF THAT CERTAIN MORTGAGE DATED April 23, 1979, AND RECORDED IN OFFICIAL RECORD BOOK 766, AT PAGES 184, OF THE PUBLIC RECORDS OF MARION COUNTY, FLORIDA, ENCUMBERING THE PROPERTY DESCRIBED HEREON, DOES HEREBY CONSENT TO THIS PLAT AND JOINS IN THE ABOVE DEDICATION.

IN WITNESS WHEREOF, SAID CORPORATION HAS CAUSED THESE PRESENTS TO BE SIGNED IN ITS CORPORATE NAME, BY ITS VICE PRESIDENT AND ASSISTANT CASHIER, AND ITS CORPORATE SEAL TO BE HEREUNTO AFFIXED BY ITS VICE PRESIDENT AND CASHIER, ALL BY AND WITH THE AUTHORITY OF THE BOARD OF DIRECTORS OF SAID CORPORATION ON THIS 1st DAY OF OCT, 1980.

Richard Knight VICE-PRESIDENT
RICHARD KNIGHT

Ann Lemly ASSISTANT CASHIER
ANN LEMLY

NOTARY ACKNOWLEDGEMENT

STATE OF FLORIDA
COUNTY OF MARION

BEFORE ME THIS DAY PERSONALLY APPEARED RICHARD KNIGHT AND ANN LEMLY AS VICE-PRESIDENT AND ASSISTANT CASHIER RESPECTIVELY OF BARNETT BANK OF OCALA, N.A. TO ME WELL KNOWN TO BE THE PERSONS DESCRIBED IN AND WHO EXECUTED THE FOREGOING INSTRUMENT, AND WHO ACKNOWLEDGED THAT THEY DID SO AS OFFICERS OF SAID CORPORATION ALL BY AND WITH THE AUTHORITY OF THE BOARD OF DIRECTORS OF SAID CORPORATION.

Lawrence M. Smith

DATE October 1, 1980

NOTARY PUBLIC

STATE OF FLORIDA AT LARGE - MY COMMISSION EXPIRES 12-12-81

DESCRIPTION

THE WEST 1707.35' OF THE SW 1/4 OF SECTION 20, TWP 16 SOUTH, RGE 21 EAST, AND THAT PORTION OF SECTION 19, TWP 16 SOUTH, RGE 21 EAST LYING SOUTH AND EAST OF STATE ROAD 200 DESCRIBED AS THE SE 1/4 OF THE NW 1/4, THE SE 1/4, THE S 1/2 OF THE NE 1/4, AND THAT PART OF THE SW 1/4 OF THE NW 1/4 DESCRIBED AS BEGINNING AT THE SE CORNER OF THE SW 1/4 OF SECTION 19, THENCE N09°04'43"E, 706.25' TO A POINT ON A NON-TANGENT CURVE CONCAVE TO THE NORTH HAVING AS ITS ELEMENTS A RADIUS OF 530.00' AND A CENTRAL ANGLE OF 0°50'08" AND A CHORD BEARING OF NORTH 9°50'49" WEST, THENCE ALONG THE ARC OF SAID CURVE 63.39' TO THE POINT OF TANGENCY, THENCE NORTH 48°25'12" WEST, 49.86', THENCE NORTH 71°59'53" WEST, 50.00', THENCE NORTH 48°25'12" WEST, 150.00' TO THE POINT OF CURVATURE OF A CURVE CONCAVE TO THE SOUTH HAVING AS ITS ELEMENTS THE RADIUS OF 25' AND A CENTRAL ANGLE OF 90°, THENCE SOUTHWESTERLY ALONG THE ARC OF SAID CURVE 39.27' TO A POINT ON THE RIGHT-OF-WAY OF STATE ROAD 200, SAID POINT BEING 50.00' SOUTHEASTERLY AS MEASURED AT RIGHT ANGLES TO THE EXISTING CENTERLINE OF THE PAVING OF SAID STATE ROAD 200, THENCE NORTH 41°34'48" EAST, 426.20' TO THE EAST LINE OF THE SW 1/4 OF THE NW 1/4 OF SAID SECTION 19, THENCE SOUTH 00°04'43" WEST, 120.18' TO THE POINT OF BEGINNING AND THE SE CORNER OF THE SW 1/4 OF THE NW 1/4 OF SECTION 19, TWP 16 SOUTH, RGE 21 EAST, ALL OF THE ABOVE LANDS LYING, BEING AND SITUATED IN MARION COUNTY, FLORIDA.

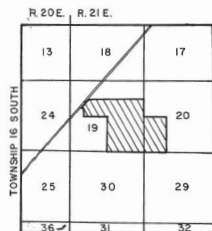

LOCATION MAP
SCALE: 1" = 4000'
GRAPHIC SCALE IN FEET - 1" = 4000'

NOTES

1. U.E. INDICATES UTILITY EASEMENT. UTILITY EASEMENTS ARE SHOWN BY DASHED LINES ON THE ATTACHED PLAT. ALL UTILITY COMPANIES SERVING THE PUBLIC ARE GRANTED THE RIGHT TO INSTALL AND MAINTAIN UTILITIES AND DRAIN-FACILITIES IN THE EASEMENTS.
2. BEARINGS ARE BASED ON AN ASSUMED MERIDIAN.
3. ● - INDICATES PERMANENT REFERENCE MONUMENTS.
4. ○ - INDICATES PERMANENT CONTROL POINTS.
5. NO LOT OR TRACT AS SHOWN ON THIS PLAT SHALL BE DIVIDED OR RE-SUBDIVIDED UNLESS PORTIONS THEREOF ARE USED TO INCREASE THE SIZE OF ADJACENT LOTS AS PLATTED.
6. ALL RADI ARE 25 FEET UNLESS OTHERWISE SHOWN.
7. D.R.A. INDICATES DRAINAGE RETENTION AREA.
8. D.R.O.W. INDICATES DRAINAGE RIGHT-OF-WAY.
9. APPLICATIONS FOR SEPTIC TANK SYSTEMS SHALL BE CONSIDERED ON A LOT BY LOT BASIS EACH DEPENDENT UPON ITS OWN MERITS. INSTALLATION SHALL BE SUBJECT TO REGULATIONS IN EFFECT AT THE TIME OF INSTALLATION.
10. SEE ADDITIONAL NOTES ON SHEET 2

APPROVAL OF OFFICIALS

By William R. Kerver DIRECTOR OF PUBLIC WORKS
By Walt Smith ZONING DIRECTOR
By Al Olson COUNTY SANITARIAN
By Ronald H. Miller COUNTY PLANNER

I HEREBY CERTIFY THAT THE ATTACHED PLAT CONFORMS WITH THE PROVISIONS OF CHAPTER 177, FLORIDA STATUTES, AND THAT SAID PLAT WAS FILED FOR RECORD IN PLAT BOOK T, AT PAGES 101-102, OF THE PUBLIC RECORDS OF MARION COUNTY, FLORIDA, AT 2:32 P.M. ON November 5th, 1980.

By Frances E. Thigpin
FRANCES E. THIGPIN
CLERK OF THE CIRCUIT COURT

DEVELOPERS ACKNOWLEDGEMENT AND DEDICATION

KNOW ALL MEN BY THESE PRESENTS THAT WILLIAM R. KERVER, TRUSTEE, AND OEHLERKING CONSTRUCTION, INC., A FLORIDA CORPORATION HAVE CAUSED TO BE MADE THE ATTACHED PLAT OF COUNTRYSIDE FARMS OF OCALA THE SAME BEING A SUBDIVISION OF THE LANDS HEREON DESCRIBED AND THAT THE OWNERS OF EVERY LOT WITHIN THIS SUBDIVISION AND THEIR HEIRS, SUCCESSORS AND ASSIGNS FOREVER ARE HEREBY GRANTED A PERPETUAL RIGHT OF EASEMENT FOR INGRESS AND EGRESS PURPOSES ON AND ACROSS TRACT 'E' AS SHOWN ON THE ATTACHED PLAT AND THAT S.W. 100TH ST. (40 FEET WIDE MEASURED AT RIGHT ANGLES FROM THE SOUTH LINES OF THE SOUTHEAST 1/4 OF SECTION 19, AND THE WEST 1707.35' OF THE SOUTHWEST 1/4 OF SECTION 20, TOWNSHIP 16 SOUTH, RANGE 21 EAST) IS DEDICATED TO THE PUBLIC FOR PUBLIC PURPOSES. TRACTS 'B', 'C', 'D', 'G', 'H', 'I', 'J', AND 'K' ARE GRANTED FOR DRAINAGE PURPOSES AND THAT THE EASEMENTS AS SHOWN ARE GRANTED FOR THE PURPOSES AS SHOWN HEREON. IN WITNESS WHEREOF WILLIAM R. KERVER, TRUSTEE HAVE CAUSED THESE PRESENTS TO BE SIGNED ON THIS 17TH DAY OF JULY, 1980, AND SAID OEHLERKING CONSTRUCTION, INC. HAS LIKEWISE CAUSED THESE PRESENTS TO BE SIGNED IN ITS CORPORATE NAME BY ITS PRESIDENT AND SECRETARY AND ITS CORPORATE SEAL TO BE HEREUNTO AFFIXED BY ITS SECRETARY, ALL BY AND WITH THE AUTHORITY OF THE BOARD OF DIRECTORS OF SAID CORPORATION.

WITNESS AS TO ALL

By William R. Kerver
WILLIAM R. KERVER, TRUSTEE

By Wayne Oehlerking
OEHLERKING CONSTRUCTION, INC.
WAYNE OEHLERKING
PRESIDENT AND SECRETARY

NOTARY ACKNOWLEDGEMENT STATE OF FLORIDA COUNTY OF MARION

BEFORE ME THIS DAY PERSONALLY APPEARED WILLIAM R. KERVER TRUSTEE TO ME WELL KNOWN TO BE THE PERSON DESCRIBED IN AND WHO EXECUTED THE FOREGOING INSTRUMENT AND WHO ACKNOWLEDGED THAT HE DID SO FREELY AND VOLUNTARILY FOR THE USES AND PURPOSES THEREIN EXPRESSED.

DATE 7-17-80

STATE OF FLORIDA
COUNTY OF MARION

BEFORE ME THIS DAY PERSONALLY APPEARED WAYNE OEHLERKING AS PRESIDENT AND SECRETARY OF OEHLERKING CONSTRUCTION, INC. TO ME WELL KNOWN TO BE THE PERSON DESCRIBED IN AND WHO EXECUTED THE FOREGOING INSTRUMENT, AND WHO ACKNOWLEDGED THAT HE DID SO AS OFFICERS OF SAID CORPORATION ALL BY AND WITH THE AUTHORITY OF THE BOARD OF DIRECTORS OF SAID CORPORATION.

DATE 11-9-80

By Thomas R. Barber
NOTARY PUBLIC
STATE OF FLORIDA AT LARGE
MY COMMISSION EXPIRES 3-26-84
By Thomas R. Barber
NOTARY PUBLIC
STATE OF FLORIDA AT LARGE
MY COMMISSION EXPIRES 3-26-84

THE BOARD OF COUNTY COMMISSIONERS OF MARION COUNTY, FLORIDA, AS A CONDITION PRECEDENT TO THE ACCEPTANCE OF THIS PLAT FOR RECORDING IN THE PUBLIC RECORDS, DOES HEREBY NOTIFY ALL PRESENT AND FUTURE OWNERS OF PROPERTY SHOWN ON THIS PLAT THAT THE LANDS INCLUDED IN THIS PLAT ARE SUBJECT TO SPECIAL ASSESSMENTS AS MAY BE PERMITTED BY LAW TO FINANCE COSTS INCURRED IN CONNECTION WITH THE MAINTENANCE, OPERATION, AND CONSTRUCTION OF A CENTRAL WATER SYSTEM AND SEWER SYSTEM WHEN, IN THE OPINION OF SAID BOARD OR OTHER GOVERNING BODY HAVING JURISDICTION, SUCH FACILITIES BECOME NECESSARY IN ORDER TO PROTECT THE ENVIRONMENT AND THE HEALTH, SAFETY, AND WELFARE OF THE GENERAL PUBLIC.

By Thomas R. Barber
THOMAS BARBER SR.
CHAIRMAN OF THE BOARD

SURVEYORS CERTIFICATE

I HEREBY CERTIFY THAT THIS PLAT OF COUNTRYSIDE FARMS OF OCALA IS A TRUE AND CORRECT REPRESENTATION OF THE LAND AS RECENTLY SURVEYED AND PLATTED UNDER MY DIRECTION; THAT THE PERMANENT REFERENCE MONUMENTS AS SHOWN THEREON WERE IN PLACE ON THE 2nd DAY OF SEPT, 1980, AND THAT THIS PLAT COMPLIES WITH THE REQUIREMENTS OF CHAPTER 177, FLORIDA STATUTES.

By Alvin T. Gloor
ALVIN T. GLOOR
REGISTERED SURVEYOR NO. 2352
STATE OF FLORIDA

THE BOARD OF COUNTY COMMISSIONERS OF MARION COUNTY, FLORIDA, DOES HEREBY APPROVE THIS PLAT FOR RECORDING IN THE PUBLIC RECORDS OF MARION COUNTY, FLORIDA, AND ACCEPTS THE FOREGOING DEDICATION.

By Frances E. Thigpin
FRANCES E. THIGPIN
CLERK OF THE CIRCUIT COURT

By Thomas R. Barber
THOMAS BARBER SR.
CHAIRMAN OF THE BOARD

NOTICE: There may be additional
recorders that are not recorded
on this plat that may be found in
the public records of this County.

THIRD EDITION SURVEY FIELD
INSTRUCTIONS FOR THE SURVEYOR
PAGE 24-2, THIS 12 DAY OF
JULY 1978

ERROR / OMISSION AFFIDAVIT FILED IN
OFFICIAL RECORD BOOK 16.77 PAGE 623
THIS 18 DAY OF JULY 1992

PLAT BOOK T PAGE 102

SHEET 2 OF 2 SHEETS

NOTICE: There may be additional
restrictions that are not recorded
on this plat that may be found in
the public records of this County.

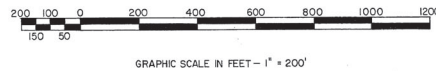

COUNTRYSIDE FARMS OF OCALA

NOTE

1. TRACT "E" AS SHOWN ON THIS PLAT IS NOT SUBJECT TO IMPROVEMENT OR MAINTENANCE BY MARION COUNTY OR ANY OTHER PUBLIC BODY.
2. THE OWNERS OF EACH LOT FRONTING ON TRACT "E" AND THEIR HEIRS, SUCCESSORS AND ASSIGNS FOREVER, HOLD A 1/94 UNDIVIDED INTEREST IN SAID TRACT "E".
3. SW ST, RD, AVE, TERR. INDICATES SOUTHWEST, STREET, ROAD, AVENUE, TERRACE RESPECTIVELY.

PREPARED BY
Alvin Gloer LAND SURVEYOR
POST OFFICE BOX 1362
OCALA, FLORIDA 32670-629-6677

FOUND
COUNTY MONUMENT
S 1/4 COR. OF SEC.
19, T16S, R21E.

NO.	CENT. ANGLE	RADIUS	ARC	TANGENT	CHORD
1-C	41° 43' 19"	500.00'	364.09'	190.54'	356.10'
2	90° 14' 32"	448.11'	705.78'	450.01'	635.06'
3	89° 59' 49"	500.00'	785.37'	499.97'	707.09'
4	90° 00' 11"	500.00'	785.37'	500.03'	707.13'
5	89° 59' 49"	500.00'	785.37'	499.97'	707.09'
6	89° 59' 49"	500.00'	785.37'	499.97'	707.09'
7	90° 10' 08"	500.00'	786.87'	501.48'	708.15'
8	19° 16' 14"	2733.91'	919.51'	464.14'	915.18'
9	19° 16' 14"	953.40'	319.44'	161.23'	317.94'
10	89° 59' 49"	500.00'	785.37'	499.97'	707.09'
11-P	89° 59' 49"	25.00'	39.27'	25.00'	35.36'
12	90° 00' 11"	25.00'	39.27'	25.00'	35.36'
13	89° 49' 52"	25.00'	39.19'	24.93'	35.30'
14	91° 04' 51"	25.00'	39.74'	25.48'	35.69'
15	90° 00' 00"	25.00'	39.27'	25.00'	35.36'
16	90° 00' 00"	25.00'	39.27'	25.00'	35.36'
17	06° 51' 08"	530.00'	63.39'	31.73'	63.35'

1" = 200'