



SUBMITTAL SUMMARY REPORT 33206

PLAN NAME: SW HWY 484 SUPER CENTER

LOCATION:

APPLICATION DATE: 08/15/2025

PARCEL: 41200-056-03

DESCRIPTION:

CONTACTS	NAME	COMPANY
Applicant	Hunter Johnson	CPH Consulting, LLC
Applicant	Kayla Sheffield	CPH Consulting, LLC
Applicant	Kayla Sheffield	CPH Consulting, LLC
Engineer of Record	Hunter Johnson	CPH Consulting, LLC
Engineer of Record	Kayla Sheffield	CPH Consulting, LLC

SUBMITTAL	STARTED	DUE	COMPLETE	STATUS
OCE: Plan Review (DR) v.4	04/29/2026	05/06/2026	05/07/2026	Approved
OCE: Plan Review (DR) v.3	04/10/2026	04/17/2026	04/22/2026	Requires Re-submit
OCE: Plan Review (DR) v.2	02/09/2026	02/16/2026	02/25/2026	Requires Re-submit
OCE: Plan Review (DR) v.1	08/19/2025	09/02/2025	11/13/2025	Requires Re-submit

SUBMITTAL DETAILS

OCE: Plan Review (DR) v.4

ITEM REVIEW NAME (DEPARTMENT)	ASSIGNED TO	DUE	COMPLETE	STATUS
911 Management (DR) (911 Management)	Kristie Wright	05/06/2026	05/05/2026	Approved
Environmental Health (Plans) (Environmental Health)	Evan Searcy	05/06/2026	05/07/2026	Approved
Fire Marshal (Plans) (Fire)	Jonathan Kenning	05/06/2026	04/29/2026	Approved
Growth Services Planning & Zoning (DR) (GS Planning and Zoning)	Erik Kramer	05/06/2026	04/29/2026	Pending Assignment

- Corrections* 2.12.5/1.8.2.F - Concurrency Deferral Statement (Resolved) - 2.12.5/1.8.2.F - Concurrency Deferral Statement: Please provide a concurrency statement on the cover sheet according to LDC Sec. 1.8.2 (F) - Concurrency Deferral. An owner may elect to defer required concurrency review and approval for a development application identified in Section 1.8.2.A to a subsequent development application review stage by executing the following "Concurrency Deferral Statement" on the development application plan, or in a separate sworn and notarized affidavit, a copy of which shall be provided to Growth Services and the original shall be recorded in Marion County's Public Records, as applicable: "This project has not been granted concurrency approval and/or granted and/or reserved any public facility capacities. Future rights to develop the resulting property(ies) are subject to a deferred concurrency determination, and final approval to develop the property has not been obtained. The completion of concurrency review and/or approval has been deferred to later development review stages, such as, but not limited to, [list subsequent applications expected pursuant to Section 1.8.2.C as applicable]."
- Corrections* 2.1.3 - Order of plan approval and consistency (Not Resolved) - 2.1.3 - Order of plan approval and consistency: The plans shall be consistent with approved PUD/Master Plan/Final Plat. Plans listed below may be reviewed concurrently, but must be approved in the order listed below, when applicable and when the proper land use and zoning are in place: A.Master Plan. B.Preliminary Plat. C.Improvement Plan. D.Final Plat. E.Major Site Plan. However, a Major Site Plan can be substituted for the Improvement Plan and can be approved before approval of the Final Plat in cases when the infrastructure improvements supporting the plat are proposed as part of the Major Site Plan application.
- Corrections* 2.12.19 - Dimension & location of site improvement (Resolved) - 2.12.19 - Dimension & location of site improvement: Provide dimensions and location of all existing site improvements; dimensions and location for all proposed site improvements.
- Corrections* 2.12 - Waivers (Requested & Approved) (Not Resolved) - 2.12 - Waivers (Requested & Approved): List of all requested and approved waivers, conditions, and the date of approval.
- Corrections* 4.4 - Show proposed signs to meet LDC Sec 4.4 (Resolved) - Proposed sign counts as "monument signage - subdivision entrance" as approved under master plan AR 27373. At permitting stage, design will need to conform to the detail and dimensions for "Monument Sign" provided on AR 27373.
- Corrections* 2.12.24 - Landscape requirements/6.8.6 - Buffering (Not Resolved) - 2.12.24 - Landscape requirements/6.8.6 - Buffering: Show buffer types, locations, and dimensions of required buffering on plan. Show buffer descriptions and illustrations of each proposed buffer (including longitudinal and transverse cross-sections).
- Corrections* 2.12.4/6.11.8 - Parking (Resolved) - 2.12.4/6.11.8 - Parking: Provide number and calculation of required and proposed parking spaces in table format, per LDC Sec. 6.11.8. - Parking requirements.
- Corrections* 2.12 - Owner and applicant name (Resolved) - 2.12 - Owner and applicant name: Show name, address, phone number, and signature of the owner and applicant on the cover sheet.

SUBMITTAL SUMMARY REPORT (33206)

ITEM REVIEW NAME (DEPARTMENT)	ASSIGNED TO	DUE	COMPLETE	STATUS
Landscape (Plans) (Parks and Recreation)	Susan Heyen	05/06/2026	05/01/2026	Approved
OCE Design (Plans) (Office of the County Engineer)	Gerald Koch	05/06/2026	04/30/2026	Approved
OCE Property Management (Plans) (Office of the County Engineer)	Delenie Roman	05/06/2026	04/30/2026	Informational

Comments

Sunbiz and map checked.
 IF APPLICABLE:
 Sec. 2.18.1.I - Show connections to other phases.
 Sec.2.19.2.H – Legal Documents
 Legal documents such as Declaration of Covenants and Restrictions, By-Laws, Articles of Incorporation, ordinances, resolutions, etc.
 Sec. 6.3.1.B.1 – Required Right of Way Dedication (select as appropriate)
 For Public Streets. "[All streets and rights-of-way shown on this plat or name specifically if less than all] are hereby dedicated for the use and benefit of the public."
 Sec. 6.3.1.B.2 – Required Right of Way Dedication
 For Non-Public Streets. "[All streets and rights-of-way shown on this plat or name specifically if less than all] are hereby dedicated privately to the [entity name]. All public authorities and their personnel providing services to the subdivision are granted an easement for access. The Board of County Commissioners of Marion County, Florida, shall have no responsibility, duty, or liability whatsoever regarding such streets. Marion County is granted an easement for emergency maintenance in the event of a local, state, or federal state of emergency wherein the declaration includes this subdivision or an emergency wherein the health, safety, or welfare of the public is deemed to be at risk."
 Sec. 6.3.1.D.3 - Cross Access Easements
 For Cross Access Easements. "All parallel access easements shown on this plat are hereby dedicated for the use and benefit of the public, and maintenance of said easements is the responsibility of [entity name]."
 Sec. 6.3.1.C.1 - Utility Easements (select as appropriate)
 "[All utility easements shown or noted or name specifically if less than all] are dedicated [private or to the public] for the construction, installation, maintenance, and operation of utilities by any utility provider."
 Sec. 6.3.1.C.2 – Utility Easements
 "[All utility tracts or identify each tract as appropriate] as shown are dedicated [private or to the public] for the construction and maintenance of such facilities."
 Sec.6.3.1.D(c)(1)(2)(3) - Stormwater easements and facilities, select as appropriate:
 1. "[All stormwater and drainage easements as shown or noted or name specifically if less than all] are dedicated [private or to the public] for the construction and maintenance of such facilities."
 2. "[All stormwater management tracts or identify each tract as appropriate] as shown are dedicated [private or to the public] for the construction and maintenance of such facilities."
 3. When any stormwater easement and/or management tract is not dedicated to the public or Marion County directly, the following statement shall be added to the dedication language: "Marion County is granted the right to perform emergency maintenance on the [stormwater easement and/or management tract, complete accordingly] in the event of a local, state, or federal state of emergency wherein the declaration includes this subdivision or an emergency wherein the health, safety, or welfare of the public is deemed to be at risk."
 Sec.6.3.1.D(f) –
 If a Conservation Easement is required the following shall be provided: "A conservation easement [as shown or on tract and identify the tract, complete accordingly] is dedicated to [the Board of County Commissioners of Marion County, Florida or entity name, if not Marion County] for the purpose of preservation of [listed species, habitat, Karst feature and/or native vegetation, complete accordingly]."
 DR 4/30/26

OCE Stormwater (Permits & Plans) (Office of the County Engineer)	Alexander Turnipseed	05/06/2026	04/29/2026	Approved
--	----------------------	------------	------------	----------

Corrections

6.13.6.C - Best Management Practices (Resolved) - 6.13.6.C - Best Management Practices: Provide a sinkhole repair detail and note stating "a minimum of three feet of unconsolidated soil material shall be provided between the surface of any limestone bedrock and the bottom and sides of any stormwater facility". Oil/water separator is required if the proposed use falls under the following: car wash, auto or marine paint and body shop, service or repair shop, automotive fleet operations, gas stations, etc. Retention and/or detention facilities shall have a maximum depth of ten feet, as measured between the design high water elevation and the pond bottom for dry facilities, and between the design high water elevation and the normal control water elevation for wet ponds.

Corrections

Additional Stormwater comments (Resolved) - Additional Stormwater comments

Corrections

6.13.2.B(5) - Hydraulic Analysis (Resolved) - 6.13.2.B(5) - Hydraulic Analysis: Hydraulic stormwater model analysis including all input parameters, supporting calculations, assumptions, documentation for design and results. Provide a sub-basin map for each sub-basin; label each sub-basin and provide total area as well as area of impervious coverage within each sub-basin.

Corrections

6.13.8 - Stormwater Conveyance Criteria (Resolved) - 6.13.8 - Stormwater Conveyance Criteria: Conveyance systems shall be sized to accommodate the 25-year 24-hour storm event. The tailwater elevation utilized shall be based on the tailwater elevation of the receiving water body plus 6 inches at the peak discharge time of the design storm. Alternatively, the tailwater elevation utilized can be the design high water elevation of the 25-year 24-hour design storm. All retention/detention areas within subdivision developments shall have direct access to a right-of-way. A drainage right-of-way may be necessary to establish this access. Drainage rights-of-way shall be a minimum of 30 feet in width. All drainage swales to facilities or underground stormwater conveyance systems shall be within drainage easements, except where rights-of-way are provided. Drainage easements shall be a minimum of 20 feet in width.

Corrections

6.13.12 - Operation and Maintenance (Resolved) - 6.13.12 - Operation and Maintenance: Provide an O&M manual detailing the steps for operating and maintaining the proposed private system of DRAs, pipes, inlets, swales, etc. Manual shall be signed by Owner and owner's certification statement shall be on the manual. Owner's certification statement: "I hereby certify that I, my successors, and assigns shall perpetually operate and maintain the stormwater management and associated elements in accordance with the specifications shown herein and on the approved plan".

Corrections

Final signed and sealed hard copy signature page (Resolved) - Final signed and sealed hard copy signature page: A hard copy of the final signed and sealed drainage report cover or complete drainage report shall be submitted to the Office of the County Engineer.

Recommendations

2.12.20 ☐ Stormwater Infrastructure Supports Phasing - Stormwater improvements must be in place to support each phase of development at time of phase completion.

SUBMITTAL SUMMARY REPORT (33206)

ITEM REVIEW NAME (DEPARTMENT)	ASSIGNED TO	DUE	COMPLETE	STATUS
OCE Stormwater (Permits & Plans) (Office of the County Engineer)	Alexander Turnipseed	05/06/2026	04/29/2026	Approved
<i>Recommendations</i>	Copy of District Permit (County Interest) - Please provide a copy of the District permit prior to construction.			
<i>Recommendations</i>	6.13.9 <input type="checkbox"/> Grading Criteria - CPH responsible for coordinating connection point grading with engineer designing AR 33171.			
<i>Recommendations</i>	2.12.9/10 <input type="checkbox"/> Proposed Drainage Right-of-Way/Easements - Appropriate drainage easements/ROW shall be included on the final plat.			
<i>Recommendations</i>	If you have questions or would like to discuss the stormwater review comments, please contact Kevin Vickers, PE at 352-671-8695 or kevin.vickers@marionfl.org.			
<i>Recommendations</i>	6.13.10.B <input type="checkbox"/> Copy of NPDES Permit or NOI - Please provide a copy of the NPDES permit or NOI prior to construction.			
<i>Recommendations</i>	2.12.22 - Stormwater Tract/Right-of-Way - Appropriate drainage tracts/ROW shall be included on the final plat.			
<i>Recommendations</i>	6.13.2.B(8) <input type="checkbox"/> Calculation & Plan Consistency - This criteria to be reviewed with resubmittal.			
OCE Survey (Plans) (Office of the County Engineer)	Theresa Smail	05/06/2026	05/04/2026	Approved
OCE Traffic (Permits & Plans) (Office of the County Engineer)	Chris Zeigler	05/06/2026	04/30/2026	Approved
Utilities (OCE Plans) (Utilities)	Heather Proctor	05/06/2026	05/04/2026	Approved
<i>Comments</i>	Project is within the Marion County Utility (MCU) service area and will provide water and wastewater services.			
	Marion County Utilities requires a pre-construction meeting to be held at least 48 hours prior to the start of any utility work. Please contact the Utilities Development Review Officer to schedule. Heather.Proctor@Marionfl.org or (352) 438-2846			
<i>Corrections</i>	6.15.7 - Cross Connection Control/Backflow (Resolved) - 6.15.7 - Cross Connection Control/Backflow:			
<i>Corrections</i>	6.14.5.A(1) - Existing water & sewer mains shown (Resolved) - 6.14.5.A(1) - Existing water & sewer mains shown:			
<i>Corrections</i>	6.14.2.C(2) - Industrial Pretreatment/FOG (Resolved) - 6.14.2.C(2) - Industrial Pretreatment/FOG:			
<i>Corrections</i>	6.14.5.B - Submit permits to MCU (DOT, ROW etc) (Resolved) - 6.14.5.B - Submit permits to MCU (DOT, ROW etc): A copy of any permit issued to the contractor shall also be submitted to MCU's Construction Manager, or designee.			
<i>Corrections</i>	6.15.3 - Fire Protection/Fire Flow Capacity (Resolved) - 6.15.3 - Fire Protection/Fire Flow Capacity: Water service will be provided by Marion County Utilities. Please consult with Marion County Fire Rescue for any additional comments or requirements related to fire protection.			
<i>Corrections</i>	6.15.6.A - Potable Water Metering - loc/bank/size (Resolved) - 6.15.6.A - Potable Water Metering - loc/bank/size:			
<i>Corrections</i>	6.14.4 - Capacity charges - irrigation (Resolved) - 6.14.4 - Capacity charges - irrigation:			
<i>Corrections</i>	6.14.5.C - Hydraulic Analysis (Resolved) - 6.14.5.C - Hydraulic Analysis: The hydraulic analysis is required to analyze the water or wastewater pressures in this area.			
<i>Corrections</i>	MCU Contact Info on Project Cover Sheet (Resolved) - MCU Contact Info on Project Cover Sheet: Marion County Utilities, 11800 S US Hwy 441, Belleview FL 34420 - Customer Service 24/7/365 352-307-6000			
<i>Corrections</i>	6.14.9.B - Transfer of Assets to MCU - PLAN NOTE: (Resolved) - 6.14.9.B - Transfer of Assets to MCU - PLAN NOTE:			
<i>Corrections</i>	6.14.6 - Utilities design to be owned by MCU (Resolved) - 6.14.6 - Utilities design to be owned by MCU:			
<i>Corrections</i>	6.14.5.B - FDEP PWS and/or WW permits (Resolved) - 6.14.5.B - FDEP PWS and/or WW permits: FDEP permits will be signed out by MCU AFTER this plan is stamped APPROVED by Development Review. DEP permits shall be signed by Owner & EOR before sent to MCU; MCU signs last. Leave all plant data blank; MCU will complete.			
<i>Corrections</i>	6.14.5.A(6) - MH locations, rim & invert elevation (Resolved) - 6.14.5.A(6) - MH locations, rim & invert elevation:			
<i>Corrections</i>	7.1.3 - UT DETAILS - current LDC version (Resolved) - 7.1.3 - UT DETAILS - current LDC version: UT details shall be current version based on latest edition of approved LDC			
<i>Corrections</i>	6.15.6.G & H - Meters up to 2" and over 2" (Resolved) - 6.15.6.G & H - Meters up to 2" and over 2": Meters up to 2" shall be paid for by the developer and will be installed by MCU through its inventory. Meters over 2" shall be purchased by the developer, and provided to MCU for installation.			
<i>Corrections</i>	6.15.6.B - Irrigation Water Metering - size (Resolved) - 6.15.6.B - Irrigation Water Metering - size:			
<i>Corrections</i>	Additional Utilities Comments (Resolved) - Additional Utilities Comments			
<i>Corrections</i>	6.14.8.A - Completion & Closeout - PLAN NOTE: (Resolved) - 6.14.8.A - Completion & Closeout - PLAN NOTE:			
<i>Corrections</i>	6.14.5.A(8) - Connection to existing sanitary (Resolved) - 6.14.5.A(8) - Connection to existing sanitary:			
<i>Corrections</i>	6.14.5.A(2) - Proposed mains & connections shown (Resolved) - 6.14.5.A(2) - Proposed mains & connections shown: Proposed mains shall be marked as private or public (MCU); points of demarcation shall be called out as necessary to identify changes in ownership. Shall include profile views unless otherwise noted.			
<i>Corrections</i>	6.14.4 - Capacity charges - domestic water/sewer (Resolved) - 6.14.4 - Capacity charges - domestic water/sewer: Capacity charges to be invoiced and collected by MCU Permitting at time of building permit review - Cap Fee Worksheet and interior floor plan may be required.			
<i>Corrections</i>	6.15.5 - Water Service & Connection (Resolved) - 6.15.5 - Water Service & Connection :			
<i>Corrections</i>	Parcel numbers match project area (Resolved) - Parcel numbers match project area: The parcels(s) shown on the application and/or site plan must match the project area			
<i>Corrections</i>	6.14.7 - Construction Inspection - PLAN NOTE: (Resolved) - 6.14.7 - Construction Inspection - PLAN NOTE::			
<i>Corrections</i>	6.14.2 - Connection Requirements (Resolved) - 6.14.2 - Connection Requirements:			
<i>Corrections</i>	6.16.4 - Wastewater Collection Systems (Resolved) - 6.16.4 - Wastewater Collection Systems:			
<i>Recommendations</i>	Resubmission Review Fee \$130.00			

GENERAL NOTES

- A. PROJECT OFFICE WALL SWPPP POSTINGS.**
THE FOLLOWING ITEMS MUST BE POSTED TOGETHER IN A SINGLE, ORGANIZED LOCATION ON A WALL, INSIDE THE PROJECT OFFICE: 1) SWPPP SITE MAPS (ALL PHASES); 2) SWPPP DETAIL SHEETS; 3) MAP SHOWING LOCATION OF OFFSITE IMPORT OR EXPORT FACILITIES; 4) REVISIONS TO DETAILS; 5) SITE MAPS, OR SWPPP-RELATED RFIS; 6) SITE SWPPP BINDER; 7) SWCT PLACARD; 8) CURRENT OWNER STORMWATER COMPLIANCE TRAINING CERTIFICATES FOR SUPERINTENDENTS AND COMPLIANCE OFFICERS; AND 9) CERTIFICATIONS AND/OR TRAINING CERTIFICATES REQUIRED TO PERFORM INSPECTIONS BY THE APPLICABLE CONSTRUCTION GENERAL PERMIT OR AUTHORITY HAVING JURISDICTION.
- B. PERMITTED PROJECT AREA:**
FOR PURPOSES OF THIS SWPPP AND ASSOCIATED STORMWATER PERMIT, PERMITTED PROJECT AREA IS DEFINED AS ANY AND ALL AREAS WITHIN THE PROJECT LIMITS OF DISTURBANCE, AS SHOWN ON THE SWPPP SITE MAPS AND IDENTIFIED IN THE NOTICE OF INTENT TO THE AGENCY. ALL GROUND-DISTURBING AND CONSTRUCTION-RELATED ACTIVITIES (MATERIAL STORAGE, DUMPSTERS, PARKING AREAS, PROJECT OFFICE TRAILER, ETC.) MUST BE INCLUDED WITHIN THE PERMITTED PROJECT AREA LIMITS OF DISTURBANCE.

OFFSITE AREAS) TO BE DISTURBED AS PART OF THIS PROJECT (NOT ON OWNER PROPERTY); 0.00 AC

ALL AREAS OUTSIDE THE PERMITTED PROJECT AREA (I.E. LIMITS OF DISTURBANCE) ACQUIRED FOR USE BY THE GC OR A SUBCONTRACTOR OF THE GC (BORROW SOURCES, DISPOSAL AREAS, ETC.) MUST BE MANAGED IN ACCORDANCE WITH APPENDIX E - TAB 21 OF THE 02370 SPECIFICATION. THE CONTRACTOR IS REQUIRED TO LOCATE OFFICE TRAILERS AND MATERIAL STORAGE AREAS FOR THE PROJECT WITHIN THE LIMITS OF DISTURBANCE. THE CONTRACTOR MAY REQUEST USE OF OFF-SITE LOCATIONS FOR OFFICE TRAILERS OR NON-ERODIBLE MATERIAL STORAGE; HOWEVER, APPROVAL MUST BE OBTAINED FROM THE CONSTRUCTION MANAGER, THE CEC AND THE SWCT PRIOR TO THEIR USE. REQUESTS WILL BE REVIEWED ON A CASE BY CASE BASIS AND IF APPROVED, LIMITATIONS ON USE WILL BE PROVIDED BY THE CEC.

C. SPECIAL PROJECT VERIFY:
THERE ARE NO SPECIAL PROJECTS, LOCATED BEYOND THE OWNER PERMITTED PROJECT AREA, REQUIRING INSPECTION AND MAINTENANCE ASSOCIATED WITH THIS CONSTRUCTION PROJECT.

D.1. NON-STORMWATER DISCHARGES:
THE GENERAL PERMIT FOR STORMWATER DISCHARGES ASSOCIATED WITH CONSTRUCTION ACTIVITIES PROHIBITS MOST NON-STORMWATER DISCHARGES DURING THE CONSTRUCTION PHASE. ALLOWABLE NON-STORMWATER DISCHARGES THAT OCCUR DURING CONSTRUCTION ON THIS PROJECT, WHICH ARE INCLUDED IN PART 3.2 OF THE GENERIC PERMIT AND INCLUDE THE FOLLOWING, PROVIDED THAT THE NON-STORMWATER COMPONENT OF THE DISCHARGE IS IN COMPLIANCE WITH PART 1.5 OF THE GENERIC PERMIT:

1. DISCHARGES FROM FIREFIGHTING ACTIVITIES.
2. FIRE HYDRANT FLUSHINGS.
3. WATERS WITHOUT DETERGENTS USED TO SPRAY OFF LOOSE SOLIDS FROM VEHICLES.
4. WATERS USED TO CONTROL DUST.
5. POTABLE WATER SOURCES SUCH AS WATERLINE FLUSHINGS.
6. LANDSCAPE IRRIGATION WATER AND DRAINAGE.
7. ROUTINE EXTERNAL BUILDING WASHDOWN PROVIDED NO DETERGENTS ARE USED.
8. PAVEMENT WASHWATERS THAT DO NOT CONTAIN DETERGENTS, LEAKS, SPILLS OF 100% OR HAZARDOUS MATERIALS.
9. AIR CONDITIONING CONDENSATE.
10. SPRING WATER.
11. FOUNDATION OR FOOTING DRAIN FLOWS THAT ARE NOT CONTAMINATED WITH PROCESS MATERIAL SUCH AS SOLVENTS.
12. NONCONTAMINATED GROUND WATER ASSOCIATED WITH DETERGENT ACTIVITIES AS DESCRIBED IN PART 3.4.

BEST MANAGEMENT PRACTICES (BMPs) MUST BE IMPLEMENTED FOR THE GENERAL PERMIT ALLOWABLE DISCHARGES FOR THE DURATION OF THE PERMIT. THE TECHNIQUES DESCRIBED IN THIS SWPPP FOCUS ON PROVIDING CONTROL OF POLLUTANT DISCHARGES WITH PRACTICAL APPROACHES THAT UTILIZE READILY AVAILABLE EXPERTISE, MATERIAL, AND EQUIPMENT.

NON-STORMWATER COMPONENTS OF SITE DISCHARGES MUST BE UNCONTAMINATED NON-TURBID WATER. ALL NON-STORMWATER DISCHARGES MUST BE ROUTED TO A STORMWATER CONTROL PRIOR TO DISCHARGE. WATER USED FOR CONSTRUCTION WHICH DISCHARGES FROM THE SITE MUST ORIGINATE FROM A PUBLIC WATER SUPPLY OR PRIVATE WELL APPROVED BY THE STATE HEALTH DEPARTMENT. WATER USED FOR CONSTRUCTION THAT DOES NOT ORIGINATE FROM AN APPROVED PUBLIC SUPPLY MUST NOT DISCHARGE FROM THE SITE. IT CAN BE RETAINED IN RETENTION PONDS UNTIL IT INFILTRATES OR EVAPORATES. WHEN NON-STORMWATER IS DISCHARGED FROM THE SITE, IT MUST BE DONE IN A MANNER SUCH THAT IT DOES NOT CAUSE EROSION OF THE SOIL DURING DISCHARGE.

D.2. POWER WASHING:
PROCESS WATER SUCH AS POWER WASHING WATER AND CONCRETE CUTTING EFFLUENT, AMONG OTHERS, MUST BE COLLECTED FOR TREATMENT AND DISPOSAL. IT MUST NOT BE FLUSHED INTO THE SITE STORM DRAIN SYSTEM OR DISCHARGED OFF-SITE.

13. DISCHARGE POINTS:
ALL DISCHARGE POINTS MUST BE INSPECTED TO DETERMINE WHETHER EROSION AND SEDIMENTATION CONTROL MEASURES ARE EFFECTIVE IN PREVENTING DISCHARGE OF SEDIMENT FROM THE SITE AND/OR IMPACTS TO RECEIVING WATERS. SEDIMENT ACCUMULATION DOWNGRADIENT OF DISCHARGE LOCATIONS SHALL BE REPORTED AS A SEDIMENT DISCHARGE (SEE APPENDIX E - TAB 14, SEDIMENT RELEASES, OF THE 02370 SPECIFICATION) AND THE POTENTIAL UPSTREAM CAUSE SHALL BE INVESTIGATED TO PREVENT FUTURE OCCURRENCE. CONTACT THE CM, CEC AND SWCT TO DETERMINE APPROPRIATE ACTION FOR CLEANUP OR DISCHARGE REMEDIATION THAT MAY BE OUTSIDE OF THE LIMITS OF DISTURBANCE. SEE SAMPLING AND MONITORING OF EFFLUENT PLAN (IF APPLICABLE).

EROSION AND SEDIMENT CONTROL NOTES

- A. CONTRACTOR SHALL IMPLEMENT BEST MANAGEMENT PRACTICES AS REQUIRED BY THIS STORM WATER POLLUTION PREVENTION PLAN. ADDITIONAL BEST MANAGEMENT PRACTICES SHALL BE IMPLEMENTED AS DICTATED BY CONDITIONS AT NO ADDITIONAL COST OF OWNER THROUGHOUT ALL PHASES OF CONSTRUCTION.**
- B. BEST MANAGEMENT PRACTICES (BMPs) AND CONTROLS SHALL CONFORM TO FEDERAL, STATE, OR LOCAL REQUIREMENTS OR MANUAL OF PRACTICE AS APPLICABLE. CONTRACTOR SHALL IMPLEMENT ADDITIONAL CONTROLS AS DIRECTED BY PERMITTING AGENCY OR OWNER.**
- C. SITE MAP MUST CLEARLY DELINEATE ALL STATE WATERS. PERMITS FOR ANY CONSTRUCTION ACTIVITY IMPACTING STATE WATERS OR REGULATED WETLANDS MUST BE MAINTAINED ON SITE AT ALL TIMES.**
- D. CONTRACTOR TO LIMIT DISTURBANCE OF SITE IN STRICT ACCORDANCE WITH SWPPP IMPLEMENTATION SEQUENCE, OR AS REQUIRED BY THE APPLICABLE GENERAL PERMIT, NO UNNECESSARY OR IMPROPERLY SEQUENCED CLEARING AND/OR GRADING SHALL BE PERMITTED.**
- E. ALL DEMOLISHED AREAS THAT WILL BE INACTIVE FOR 7 DAYS OR MORE MUST BE STABILIZED IMMEDIATELY UPON COMPLETION OF MOST RECENT GRADING ACTIVITY, WITH THE USE OF: FAST-GERMINATING ANNUAL GRASS/GRASS MIXTURES, STRAWHAY MULCH, WOOD CELLULOSE FIBERS, TACKIFIERS, NETTING AND/OR BLANKETS. COMPLETION MUST BE ACHIEVED WITHIN 7 DAYS.**
- F. DISTURBED PORTIONS OF THE SITE WHERE CONSTRUCTION ACTIVITY HAS PERMANENTLY STOPPED SHALL BE PERMANENTLY STABILIZED AS SHOWN ON THE PLANS. THESE AREAS SHALL BE SEEDED, SOODED, AND/OR VEGETATED IMMEDIATELY, AND COMPLETED NO LATER THAN 7 DAYS AFTER THE LAST CONSTRUCTION ACTIVITY OCCURRING IN THESE AREAS. REFER TO THE GRADING PLAN AND/OR LANDSCAPE PLAN.**
- G. SLOPES SHALL BE LEFT IN A ROUGHENED CONDITION DURING THE GRADING PHASE TO REDUCE RUNOFF VELOCITIES AND EROSION. TEMPORARY AND/OR PERMANENT STABILIZATION SHALL BE APPLIED PER REQUIREMENTS IN THESE EAS CONTROL NOTES.**
- H. DUE TO THE GRADE CHANGES DURING THE DEVELOPMENT OF THE PROJECT, THE CONTRACTOR SHALL BE RESPONSIBLE FOR ADJUSTING THE EROSION AND SEDIMENT CONTROL MEASURES (SILT FENCES, ETC.) TO PREVENT EROSION AND POLLUTANT DISCHARGE OFF-SITE.**
- I. ALL MEASURES STATED ON THIS SITE MAP, AND IN THE STORM WATER POLLUTION PREVENTION PLAN, SHALL BE MAINTAINED IN FULLY FUNCTIONAL CONDITION UNTIL NO LONGER REQUIRED FOR A COMPLETED PHASE OF WORK OR FINAL STABILIZATION OF THE SITE. ALL EROSION AND SEDIMENTATION CONTROL MEASURES SHALL BE CHECKED BY A QUALIFIED PERSON IN ACCORDANCE WITH THE CONTRACT DOCUMENTS OR THE APPLICABLE PERMIT, WHICHEVER IS MORE STRINGENT, AND REPAIRED IN ACCORDANCE WITH THE SITE PLANS.**
- J. STORM WATER POLLUTANT CONTROL MEASURES INSTALLED DURING CONSTRUCTION, THAT WILL ALSO PROVIDE STORM WATER MANAGEMENT AFTER CONSTRUCTION, ARE INCLUDED IN THE CONTRACT DOCUMENTS. THE SITE-SPECIFIC POST CONSTRUCTION STORM WATER OPERATION AND MAINTENANCE (O&M) MANUAL IS INCLUDED IN THE CONTRACT DOCUMENTS.**
- K. ALL PERMANENT CONTROLS AND SYSTEMS MUST BE INSTALLED AND FUNCTIONING AS DESIGNED AND FREE OF ACCUMULATED SEDIMENT AND DEBRIS DURING FINAL PROJECT INSPECTION AND APPROVAL.**
- L. ALL SOIL STOCKPILES SHALL BE PROTECTED AGAINST DUST AND EROSION.**
- M. AT ALL TIMES DURING AND AFTER DEVELOPMENT, CLEARED AREAS SHALL BE STABILIZED. FINAL STABILIZATION MEASURES SHALL BE IN PLACE WITHIN FOURTEEN (14) DAYS OF GRADING.**
- N. ALL CONTROL MEASURES SHALL COMPLY WITH THE MANAGEMENT PRACTICES CONTAINED IN THE FLORIDA DEPARTMENT OF ENVIRONMENTAL PROTECTION'S EROSION & SEDIMENT CONTROL DESIGNER AND REVIEWERS MANUAL, LATEST EDITION.**
- O. ANY SEDIMENT OR DEBRIS THAT LEAVES THE DEVELOPMENT SITE SHALL BE PROPERLY RECOVERED BY THE BUILDING PERMIT HOLDER.**
- P. CONTRACTOR IS TO MINIMIZE THE EXTENT OF THE AREA EXPOSED AT ONE TIME, THE DISTURBANCE OF STEEP SLOPES, AND THE DURATION OF EXPOSURE DURING CONSTRUCTION. THIS INCLUDES AVOIDING CLEARING, GRUBBING, AND GRADING THE ENTIRETY OF THE SITE AT ONCE. THE PERMITTEE SHALL SUBMIT A PHASED CONSTRUCTION SCHEDULE PRIOR TO THE START OF CONSTRUCTION WHICH INCLUDES A DESCRIPTION OF CONSTRUCTION TECHNIQUES, SCHEDULING, AND EQUIPMENT. PLEASE REFER TO SUBSECTION 111.2 OF ERP APPLICANTS HANDBOOK VOLUME I AND PART 3 OF SECTION E OF THE ERP APPLICATION FORM 62-330.060(1) FOR MORE INFORMATION.**
- Q. IT IS THE CONTRACTOR'S RESPONSIBILITY TO MANAGE ALL SEDIMENT AND EROSION CONTROL MEASURES AS REQUIRED BY REGULATORY AGENCIES.**
- R. NO CLEARING, GRADING, EXCAVATING, FILLING, OR OTHER DISTURBANCE OF THE NATURAL TERRAINS SHALL OCCUR UNTIL EROSION AND SEDIMENTATION CONTROL MEASURES HAVE BEEN INSTALLED, EXCEPT THOSE OPERATIONS NEEDED TO IMPLEMENT THESE MEASURES.**
- S. THE CONTRACTOR SHALL PROVIDE THE COUNTY ENGINEER WITH A COPY OF THE NPDES PERMIT PRIOR TO COMMENCING CONSTRUCTION ACTIVITIES AS REQUIRED BY DEPS'S NPDES PROGRAM.**

HAZARDOUS MATERIAL MANAGEMENT & SPILL REPORTING

ANY HAZARDOUS OR POTENTIALLY HAZARDOUS MATERIAL THAT IS BROUGHT ONTO THE CONSTRUCTION SITE SHALL BE HANDLED PROPERLY TO REDUCE THE POTENTIAL FOR STORMWATER POLLUTION. ALL MATERIALS USED ON THIS CONSTRUCTION SITE SHALL BE PROPERLY STORED, HANDLED, DISPENSED AND DISPOSED OF FOLLOWING ALL APPLICABLE LABEL DIRECTIONS. FLAMMABLE AND COMBUSTIBLE LIQUIDS SHALL BE STORED AND HANDLED ACCORDING TO APPLICABLE REGULATIONS, AND, AT A MINIMUM, ACCORDING TO 29 CFR 1926.152. ONLY APPROVED CONTAINERS AND PORTABLE TANKS SHALL BE USED FOR STORAGE AND HANDLING OF FLAMMABLE AND COMBUSTIBLE LIQUIDS.

MATERIAL SAFETY DATA SHEETS (MSDS) INFORMATION SHALL BE KEPT ON SITE FOR ANY AND ALL APPLICABLE MATERIALS. HOWEVER, MSDS MAY ALSO BE ACCESSED VIA TELEPHONE OR OTHER ELECTRONIC MEANS OR APPARATUS.

IN THE EVENT OF AN ACCIDENTAL SPILL, IMMEDIATE ACTION SHALL BE TAKEN BY THE GC TO CONTAIN AND REMOVE THE SPILLED MATERIAL. THE SPILL SHALL BE REPORTED TO THE APPROPRIATE AGENCIES IN THE REQUIRED TIME FRAMES, AS REQUIRED UNDER THE PROVISIONS OF THE CLEAN WATER ACT. ANY SPILL OR DISCHARGE ENTERING WATERS OF THE UNITED STATES SHALL BE PROPERLY REPORTED.

ALL HAZARDOUS MATERIALS, INCLUDING CONTAMINATED SOIL AND LIQUID CONCRETE WASTE, SHALL BE DISPOSED OF BY THE CONTRACTOR IN THE MANNER SPECIFIED BY FEDERAL, STATE AND LOCAL REGULATIONS AND BY THE MANUFACTURER OF SUCH PRODUCTS.

THE GC SHALL PREPARE A WRITTEN RECORD OF ANY SPILL AND ASSOCIATED CLEAN-UP ACTIVITIES OF PETROLEUM PRODUCTS OR HAZARDOUS MATERIALS IN EXCESS OF 1 GALLON OR REPORTABLE QUANTITIES, WHICHEVER IS LESS, ON THE DAY OF THE SPILL. THE GC SHALL PROVIDE NOTICE TO OWNER, VIA THE ONLINE CRITICAL INCIDENT REPORT, IMMEDIATELY UPON IDENTIFICATION OF ANY SPILL. SPILL REPORT FORMS ARE AVAILABLE IN THE ONLINE SWPPP REPORTING SYSTEM PROVIDED BY THE OWNER. COPIES OF SPILL CRITICAL INCIDENT REPORTS SHALL BE PRINTED AND MAINTAINED IN THE JOBSITE BINDER.

ANY SPILLS OF PETROLEUM PRODUCTS OR HAZARDOUS MATERIALS IN EXCESS OF REPORTABLE QUANTITIES AS DEFINED BY THE STATE OR LOCAL AGENCY REGULATIONS, SHALL BE IMMEDIATELY REPORTED TO THE EPA NATIONAL RESPONSE CENTER (1-800-424-8802) AND FLORIDA DEPARTMENT OF ENVIRONMENTAL PROTECTION (1-800-302-6919, HTTP://DEP.STATE.FL.US/REPORTABLE_INCIDENT.HTM).

THE STATE REPORTABLE QUANTITY FOR PETROLEUM PRODUCTS IS 25 GALLONS OR ANY QUANTITY THAT COMES INTO CONTACT WITH STATE WATERS PER F.A.C. 62-780.210

DISCHARGES OF PETROLEUM OR PETROLEUM PRODUCTS OF LESS THAN 25 GALLONS THAT ARE NOT ADDRESSED PURSUANT TO SUBSECTION 62-780.560(1), F.A.C., SHALL BE REPORTED WITHIN ONE WEEK OF DISCOVERY. DISCHARGES OF PETROLEUM OR PETROLEUM PRODUCTS EQUAL TO OR EXCEEDING 25 GALLONS ONTO PERVIOUS SURFACES OR ANY DISCHARGE TO SURFACE WATERS SHALL BE REPORTED TO THE STATE WATER OFFICE OR FDEP OFFICE OF EMERGENCY RESPONSE AS SOON AS POSSIBLE, BUT NO LATER THAN 24 HOURS AFTER OCCURRENCE. THE REPORTABLE QUANTITY FOR HAZARDOUS MATERIALS CAN BE FOUND IN 40 CFR 302 AND THE EPA LISTS AT HTTP://WWW2.EPA.GOV/EPCEACONSOLIDATED-LIST-STS.

TO MINIMIZE THE POTENTIAL FOR A SPILL OF PETROLEUM PRODUCT OR HAZARDOUS MATERIALS TO COME IN CONTACT WITH STORMWATER, THE FOLLOWING STEPS SHALL BE IMPLEMENTED:

- 1) ALL MATERIALS WITH HAZARDOUS PROPERTIES, SUCH AS PESTICIDES, PETROLEUM PRODUCTS, FERTILIZERS, SOAPS, DETERGENTS, CONSTRUCTION CHEMICALS, ACIDS, BASES, PAINTS, PAINT SOLVENTS, ADDITIVES FOR SOIL STABILIZATION, CONCRETE, CURING COMPOUNDS AND ADDITIVES, ETC., SHALL BE STORED IN A SECURE LOCATION, UNDER COVER AND IN APPROPRIATE, TIGHTLY SEALED CONTAINERS WHEN NOT IN USE.
- 2) THE MINIMUM PRACTICAL QUANTITY OF ALL SUCH MATERIALS SHALL BE KEPT ON THE JOB SITE AND SCHEDULED FOR DELIVERY AS CLOSE TO TIME OF USE AS PRACTICAL.
- 3) A SPILL CONTROL AND CONTAINMENT KIT (CONTAINING FOR EXAMPLE, ABSORBENT MATERIAL SUCH AS KITTY LITTER OR SAVIOUST, ACID, BASE, NEUTRALIZING AGENT, BROOMS, DUST PANS, MOPS, RAGS, GLOVES, GOGGLES, PLASTIC AND METAL TRASH CONTAINERS, ETC.) SHALL BE PROVIDED AT THE CONSTRUCTION SITE AND ITS LOCATIONS SHALL BE IDENTIFIED WITH LEGIBLE SIGNAGE AND SHOWN ON SITE MAPS.
 - a. THE SPILL CONTROL AND CONTAINMENT KIT SUPPLIES SHALL BE OF SUFFICIENT QUANTITIES AND APPROPRIATE CONTENT TO CONTAIN A SPILL FROM THE LARGEST ANTICIPATED PIECE OF EQUIPMENT AND FROM THE LARGEST ANTICIPATED QUANTITIES OF PRODUCTS STORED ON THE SITE AT ANY GIVEN TIME.
 - b. CONTENTS SHALL BE INSPECTED DAILY DURING THE DAILY STORMWATER INSPECTION.
- 4) ALL PRODUCTS SHALL BE STORED IN AND USED FROM THE ORIGINAL CONTAINER WITH THE ORIGINAL PRODUCT LABEL. CONTAINERS MUST BE STORED IN A MANNER TO PROTECT THEM FROM THE ELEMENTS AND INCIDENTAL DAMAGE.
- 5) ALL PRODUCTS SHALL BE USED IN STRICT COMPLIANCE WITH INSTRUCTIONS ON THE PRODUCT LABEL.
- 6) THE DISPOSAL OF EXCESS OR USED PRODUCTS SHALL BE IN STRICT COMPLIANCE WITH INSTRUCTIONS ON THE PRODUCT LABEL AND REGULATIONS.

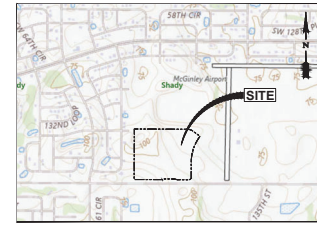

USGS QUADRANGLE MAP
NTS



SITE LOCATION MAP
NTS



Building Better Communities Together

5200 Beech Rd STE 220 Jacksonville, FL 32209
PH: 904.333.0389

Plans Prepared By:
CPh Consulting, LLC
A Full Service A & E Firm



This plan has been digitally signed and sealed by N. A. Skelton, P.E. on the date adjacent to the seal. Printed copies of this document are not considered signed and sealed and the signature must be verified on any electronic copies.

No.	Date	Revision	REVISED COUNTY COMMENTS
1	01/09/20		

Designed: H. JOHNSON
Drawn: P. SHEFFIELD
Checked: N. SKELTON
Job No.: W131528
Date: 1/23/20

SWPPP NOTES
MAJOR SITE PLAN - C - STORE
MARION OAKS FLORIDA

Always call 811 two full business days before you dig

Sunshine811.com

www.sunshine811.com

THIS SHEET NOT VALID FOR CONSTRUCTION WITHOUT COMPLETE SET OF PLANS.

Sheet No.
SW.1

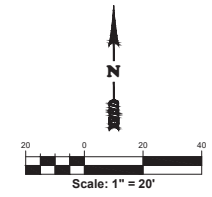
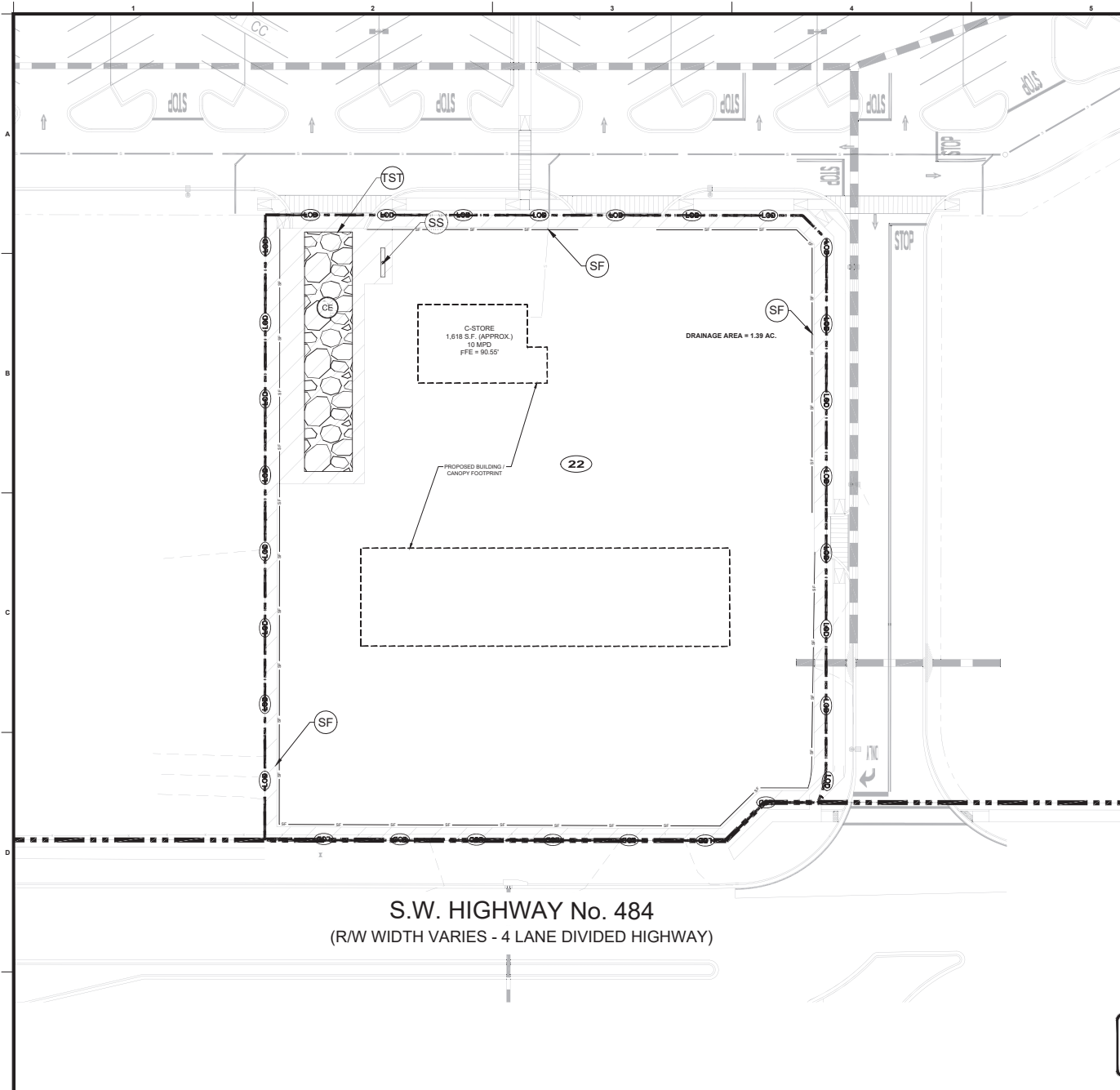

TEMPORARY BENCHMARK
 B.M. NAIL AND DISK IN ASPHALT
 ELEVATION = 156.79 (NAVD 83)
 REFERENCE AT LANSPLS LAND TITLE SURVEY SHEET 2 OF 3.

SWPPP UPDATES AND AMENDMENTS
 THE GC MUST UPDATE THE SWPPP, INCLUDING THE JOBSITE BINDER AND SITE MAPS, TO REFLECT THE PROGRESS OF CONSTRUCTION ACTIVITIES AND GENERAL CHANGES TO THE PROJECT SITE. UPDATES SHALL BE MADE DAILY TO TRACK PROGRESS. WHEN ANY OF THE FOLLOWING ACTIVITIES OCCUR: BMP INSTALLATION, MODIFICATION OR REMOVAL, CONSTRUCTION ACTIVITIES (E.G., PAVING, STORM SEWER INSTALLATION, FOOTING INSTALLATION, ETC.), CLEARING, GRUBBING OR GRADING, OR TEMPORARY OR PERMANENT STABILIZATION.

IMPORTANT:
 THE GENERAL CONTRACTOR MUST SUBMIT A REQUEST FOR INFORMATION (RFI) TO THE CEC AND OBTAIN WRITTEN CEC APPROVAL, BEFORE DOING ANY OF THE FOLLOWING:

1. MODIFYING EROSION OR SEDIMENT CONTROL BMPs (SUBSTITUTIONS ARE TYPICALLY ONLY APPROVED IF SPECIFIED MATERIALS ARE NOT AVAILABLE OR THERE IS A VALID REASON THE SPECIFIED BMP WILL NOT WORK)
2. ADDING/LETTING EROSION OR SEDIMENT CONTROL BMPs
3. MODIFYING THE SWPPP IMPLEMENTATION SEQUENCE OR
4. PERFORMING ANY ACTIONS OR IN ANY MANNER THAT IS CONTRARY TO THE SWPPP.

THE CONTRACTOR MAY MODIFY OR ADD ADDITIONAL BMPs, WITHOUT CEC APPROVAL, IN AN EMERGENCY SITUATION TO PREVENT SEDIMENT DISCHARGE OR PROTECT WATER QUALITY; HOWEVER, GC MUST NOTIFY THE CEC AS SOON AS PRACTICAL AS TO THEIR ACTIONS TO DISCUSS THE NEED FOR ADDITIONAL OR SUPPLEMENTAL MEASURES AND TO OBTAIN THE REQUIRED APPROVALS. THE CONTRACTOR IS ULTIMATELY RESPONSIBLE TO ENSURE COMPLIANCE WITH THE PERMIT AND PROTECTION OF DOWNSTREAM WATER QUALITY.

AMENDING THE SWPPP DOES NOT MEAN THAT IT HAS TO BE REPRINTED. IT IS ACCEPTABLE TO ADD ADDENDA, SKETCHES, NEW SECTIONS, DETAILS, AND/OR REVISED DRAWINGS THAT HAVE THE CEC NAME IN PRINT, ARE STAMPED, SIGNED, DATED, AND ARE ACCOMPANIED BY WRITTEN COPY OF THE ASSOCIATED RFI AND ITS RESPONSE FROM CEC. ENGINEERED ITEMS MUST BE SIGNED AND STAMPED BY THE CEC OF RECORD FOR THE PROJECT.

- LEGEND**
- SITE FEATURES:**
- PROPERTY LINE
 - RIGHT OF WAY LINE
 - LIMITS OF DISTURBANCE
 - EXISTING CONTOUR
 - EXISTING STORM PIPE
 - DIRECTION OF OVERLAND FLOW
- EROSION DETAILS:**
- TEMPORARY CONSTRUCTION EXIT (CE)
 - SEDIMENTATION SILT FENCE WITH WIRE BACKING (SF)
 - TEMPORARY SEDIMENT TRAP (TST)
 - SWPPP INFORMATION SIGN (SS)
- EROSION NOTES:**
- SOIL TYPE: CANDLER SAND (22)



DEWATERING NOTE:
 WHEN PERFORMING GRADING OPERATIONS DURING PERIODS OF WET WEATHER, PROVIDE ADEQUATE DEWATERING, DRAINAGE AND GROUND WATER MANAGEMENT TO CONTROL MOISTURE OF SOILS. REFER TO MASTER SITE SPECIFICATIONS.

NOTE TO GENERAL CONTRACTOR:
 PRIOR TO CONSTRUCTION, GC MUST CLEARLY DELINEATE AND MARK OFF AREAS IDENTIFIED IN THE SWPPP ON THE FIELD. TO BE PROTECTED (SUCH AS, NATURAL BUFFERS, TREES, HABITATS OF ENDANGERED/THREATENED SPECIES, HISTORIC PROPERTIES, ETC.).

cph
 www.cphcorp.com
Building Better Communities Together
 5200 Butler Rd STE 200
 Jacksonville, FL 32256
 Ph: (904) 333-0899

Plans Prepared By:
 CPH Consulting, LLC
 A Full Service A & E Firm

FLORIDA PROFESSIONAL ENGINEER
 No. 92781
 P. SHEFFIELD

This form has been digitally signed and sealed by P. SHEFFIELD, P.E. on the date adjacent to the seal. Printed copies of this document are not considered signed and sealed and the signature must be verified on any electronic copies.

No.	Date	REV/REV. COUNTY COMMENTS	Revision
1	01/03/20		

Designed: H. JOHNSON
 Drawn: P. SHEFFIELD
 Checked: N. SKELTON
 Job No.: W131528
 Date: 1/23/26 © 2026

PHASE 1 EROSION AND SEDIMENTATION CONTROL PLAN
 MAJOR SITE PLAN - C - STORE
 MARION OAKS FLORIDA

THIS SHEET NOT VALID FOR CONSTRUCTION WITHOUT COMPLETE SET OF PLANS.

Sheet No.
SW.3

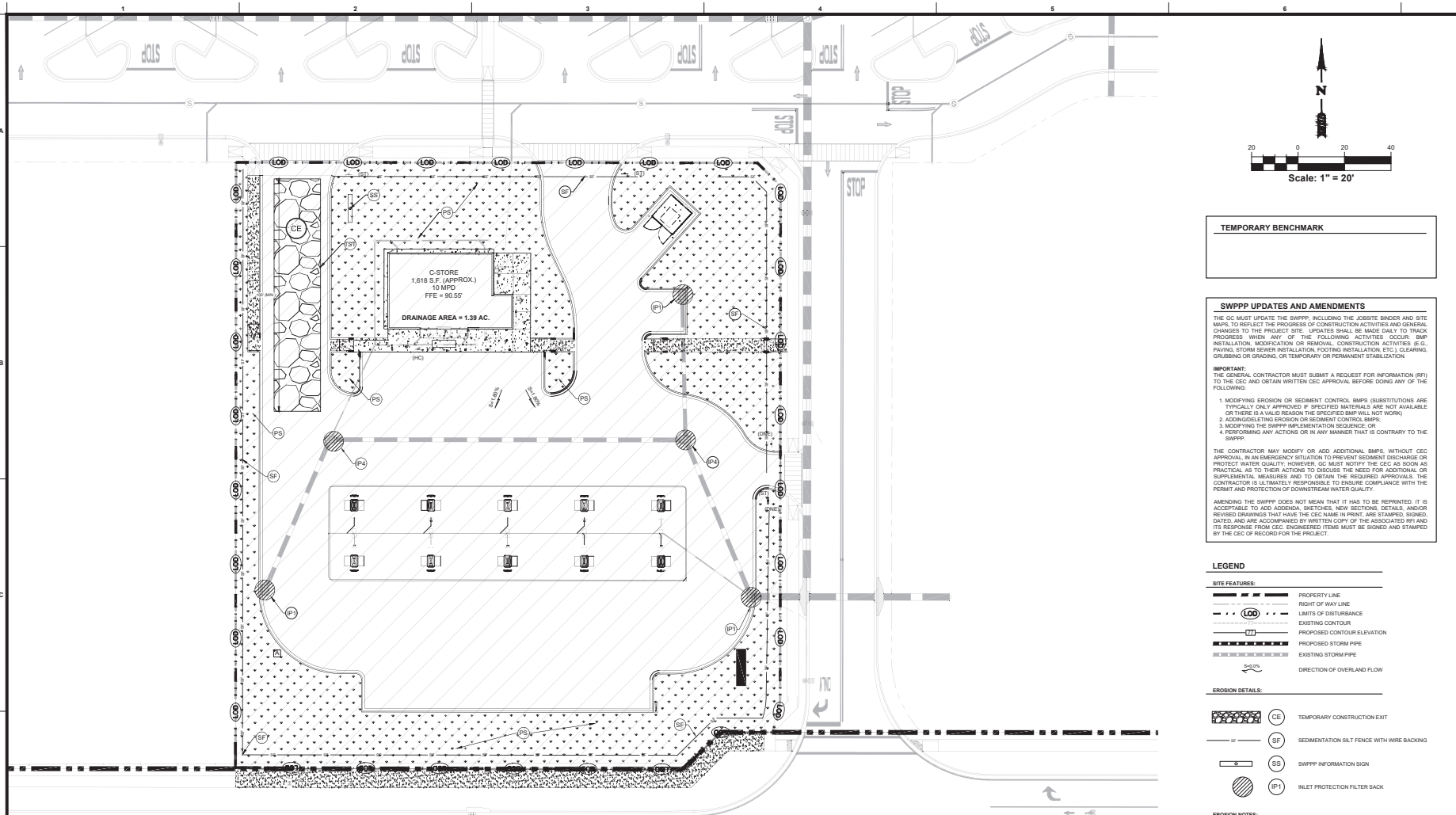

S.W. HIGHWAY No. 484
(R/W WIDTH VARIES - 4 LANE DIVIDED HIGHWAY)

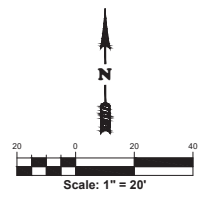

TEMPORARY BENCHMARK

SWPPP UPDATES AND AMENDMENTS

THE GC MUST UPDATE THE SWPPP, INCLUDING THE JOB SITE BINDER AND SITE MAPS, TO REFLECT THE PROGRESS OF CONSTRUCTION ACTIVITIES AND GENERAL CHANGES TO THE PROJECT SITE. UPDATES SHALL BE MADE DAILY TO TRACK PROGRESS WHEN ANY OF THE FOLLOWING ACTIVITIES OCCUR: BMP INSTALLATION, MODIFICATION OR REMOVAL, CONSTRUCTION ACTIVITIES (E.G. PAVING, STORM SEWER INSTALLATION, FOOTING INSTALLATION, ETC.), CLEARING, GRUBBING OR GRADING, OR TEMPORARY OR PERMANENT STABILIZATION.

IMPORTANT:
THE GENERAL CONTRACTOR MUST SUBMIT A REQUEST FOR INFORMATION (RFI) TO THE CEC AND OBTAIN WRITTEN CEC APPROVAL, BEFORE DOING ANY OF THE FOLLOWING:

1. MODIFYING EROSION OR SEDIMENT CONTROL BMPs (SUBSTITUTIONS ARE TYPICALLY ONLY APPROVED IF SPECIFIED MATERIALS ARE NOT AVAILABLE OR THERE IS A VALID REASON THE SPECIFIED BMP WILL NOT WORK)
2. ADDING/DELETING EROSION OR SEDIMENT CONTROL BMPs
3. MODIFYING THE SWPPP IMPLEMENTATION SEQUENCE, OR
4. PERFORMING ANY ACTIONS OR IN ANY MANNER THAT IS CONTRARY TO THE SWPPP.

THE CONTRACTOR MAY MODIFY OR ADD ADDITIONAL BMPs, WITHOUT CEC APPROVAL, IN AN EMERGENCY SITUATION TO PREVENT SEDIMENT DISCHARGE OR PROTECT WATER QUALITY. HOWEVER, GC MUST NOTIFY THE CEC AS SOON AS PRACTICAL AS TO THEIR ACTIONS TO DISCUSS THE NEED FOR ADDITIONAL OR SUPPLEMENTAL MEASURES AND TO OBTAIN THE REQUIRED APPROVALS. THE CONTRACTOR IS ULTIMATELY RESPONSIBLE TO ENSURE COMPLIANCE WITH THE PERMIT AND PROTECTION OF DOWNSTREAM WATER QUALITY.

AMENDING THE SWPPP DOES NOT MEAN THAT IT HAS TO BE REPRINTED. IT IS ACCEPTABLE TO ADD ADDENDA, SHEETS, NEW SECTIONS, DETAILS, AND/OR REVISED DRAWINGS THAT HAVE THE CEC NAME IN PRINT, ARE STAMPED, SIGNED, DATED, AND ARE ACCOMPANIED BY WRITTEN COPY OF THE ASSOCIATED RFI AND ITS RESPONSE FROM CEC. ENGINEERED ITEMS MUST BE SIGNED AND STAMPED BY THE CEC OF RECORD FOR THE PROJECT.

LEGEND

- SITE FEATURES:**
- PROPERTY LINE
 - RIGHT OF WAY LINE
 - LIMITS OF DISTURBANCE
 - EXISTING CONTOUR
 - PROPOSED CONTOUR ELEVATION
 - PROPOSED STORM PIPE
 - EXISTING STORM PIPE
 - DIRECTION OF OVERLAND FLOW
- EROSION DETAILS:**
- TEMPORARY CONSTRUCTION EXIT
 - SEDIMENTATION SILT FENCE WITH WIRE BACKING
 - SWPPP INFORMATION SIGN
 - INLET PROTECTION FILTER BASK
- EROSION NOTES:**
- PERMANENT SEEDING, SOIL OR MULCHING (SEE LANDSCAPE PLANS)
 - PROPOSED FDOT TYPE B BARRIERS PER FOOT INDEX NO 102469 WITH ROAD CLOSURE SIGNS

cph
www.cphcorp.com
Building Better Communities Together

5200 Beecher Rd STE 220
Jacksonville, FL 32256
Ph: 904.733.0399

Plans Prepared By:
CPH Consulting, LLC
A Full Service A & E Firm

Professional Engineer
No. 92781
STATE OF FLORIDA
Professional Engineer
KAYLA SHEFFIELD
92781 FL

This item has been digitally signed and sealed by KAYLA G. SHEFFIELD, P.E. on the date adjacent to the seal. Printed copies of this document are not considered signed and sealed and the signature must be verified on any electronic copies.

No.	Date	REV/PRE/ COUNTY COMMENTS	Revision
1			
2			
3			
4			
5			
6			
7			
8			
9			
10			

Designed: H. JOHNSON
Drawn: P. SHEFFIELD
Checked: N. SKELTON
Job No.: W131528
Date: 1/23/26 © 2026

PHASE 2 EROSION AND SEDIMENTATION CONTROL PLAN - C - STORE
MAJOR SITE PLAN - C - STORE
MARION OAKS FLORIDA

Always call 811 two full business days before you dig

Sunshine811.com

www.sunshine811.com

DEWATERING NOTE:
WHEN PERFORMING GRADING OPERATIONS DURING PERIODS OF WET WEATHER, PROVIDE ADEQUATE SEWATERING, DRAINAGE AND GROUND WATER MANAGEMENT TO CONTROL MOISTURE OF SOILS. REFER TO MASTER SITE SPECIFICATIONS.

NOTE TO GENERAL CONTRACTOR:
PRIOR TO CONSTRUCTION, GC MUST CLEARLY DELINEATE AND MARK ALL AREAS IDENTIFIED IN THE SWPPP OR IN THE FIELD TO BE PROTECTED (SUCH AS NATURAL BUFFERS, TREES, HABITATS OF ENDANGERED/THREATENED SPECIES, HISTORIC PROPERTIES, ETC.).

THIS SHEET NOT VALID FOR CONSTRUCTION WITHOUT COMPLETE SET OF PLANS.

Sheet No.
SW.4

SOIL EROSION/SEDIMENTATION CONTROL OPERATION TIME SCHEDULE

NOTE: GENERAL CONTRACTOR TO COMPLETE TABLE WITH THEIR ESTIMATED PROJECT SCHEDULE

CONSTRUCTION SEQUENCE	AUG	SEP	OCT	NOV	DEC	JAN	FEB	MAR	APR	MAY	JUN	JUL	AUG	SEP	OCT	NOV	DEC	JAN	FEB	MAR	APR	MAY	JUN	JUL	
TEMPORARY CONSTRUCTION EXITS																									
TEMPORARY CONTROL MEASURES																									
SEDIMENT CONTROL BASINS/TRAP(S)																									
STRIP & STOCKPILE TOPSOIL																									
ROUGH GRADING																									
STORM FACILITIES																									
SITE CONSTRUCTION																									
FINISH GRADING																									
PERIMENT CONTROL STRUCTURES																									
FOUNDATION / BUILDING CONSTRUCTION																									
LANDSCAPING/SEED/FINAL STABILIZATION																									

1) CONTRACTOR MUST COMPLETE TABLE WITH ESTIMATED DATES OF PROJECT ACTIVITIES PRIOR TO BMP CERTIFICATION.
2) TIME SCHEDULE MUST CONCLUDE WITH THE SWPPP IMPLEMENTATION SEQUENCE.

LAST REVISED:
APRIL 30, 2011

ACREAGE SUMMARY (IN ACRES)

1	PROPERTY AREA	1.40
2	PERMITTED AREA WITHIN PROPERTY	1.40
3	PERMITTED AREA OUTSIDE OF PROPERTY	0.00
4	TOTAL PERMITTED PROJECT AREA (MUST MATCH NO2)	1.40
5	IMPERVIOUS AREA BEFORE PROJECT	0.00
6	IMPERVIOUS AREA AT COMPLETION	0.85
7	PERVIOUS AREA AT COMPLETION	0.55

LAST REVISED:
JUNE 2013

RUNOFF COEFFICIENT SUMMARY

PRE-CONSTRUCTION RUNOFF COEFFICIENT [OR SCS TR-55 CURVE NUMBER]:	CN = 80.00
POST-CONSTRUCTION RUNOFF COEFFICIENT [OR SCS TR-55 CURVE NUMBER]:	CN = 92.60

LAST REVISED:
JUNE 2012

SITE LOCATION SUMMARY

ADDRESS:	HIGHWAY 484 AND SW 57TH AVE
CENTER OF SITE:	
LATITUDE:	29°01'36.58"N - (30.3846)
LONGITUDE:	82°13'02.96"W - (87.0849)
ADJACENT SURROUNDING PROPERTIES:	PROPERTY IS LOCATED ON THE CORNER OF SW HIGHWAY 484 AND SW 57TH AVENUE. TO THE WEST AND NORTH IS COMMERCIAL.

LAST REVISED:
JUNE 2012

SITE TOPOGRAPHY SUMMARY

LOWEST ELEVATION OF PROJECT SITE:	86.38' (NAVD 88)
HIGHEST ELEVATION OF PROJECT SITE:	91.00' (NAVD 88)
PERCENT SLOPE VARIATION:	PROPERTY IS ROUGH GRADED TO ELEVATION 83' - 84' (NAVD 88) SEE GRADING PLAN FOR FINAL GRADES
TOPOGRAPHY CHANGES:	0-3' ON AVERAGE BUT WILL MAINTAIN GENERAL SLOPE OF LAND.
VEGETATION:	THE EXISTING SITE HAS BEEN CLEARED.
AVERAGE SLOPE:	THE PROPERTY SLOPES 0.5 - 1% FROM THE NORTH SIDE OF THE PARCEL TO THE SOUTH SIDE OF THE PARCEL NEAR ROW.

LAST REVISED:
JUNE 2013

SITE SOILS SUMMARY

SOIL TYPE AND TEXTURE:	COMBINATION OF BONIFAY LOAMY SAND AND TROUP LOAMY SAND PER WEB SOIL SURVEY.
AVERAGE DEPTH OF TOPSOIL:	2'-4" DEPTH WERE OBSERVED ON THE SITE BASED ON GEOTECHNICAL FINDINGS.
AVERAGE DEPTH TO GROUNDWATER:	GROUND WATER HAS NOT ENCOUNTERED/ APPARENT IN THE BORINGS AT THE TIME OF FIELD EXPLORATION. SEASONAL HIGH GROUNDWATER TABLE IS ESTIMATED TO BE GREATER THAN DEPTHS OF 30 FEET.

NOTE: THE ABOVE SOILS INFORMATION IS FOR INFORMATION ONLY AND SHOULD NOT BE USED FOR BIDDING PURPOSES, CONSTRUCTION COSTS OR ESTIMATING.

LAST REVISED:
JUNE 2012

SITE RAINFALL SUMMARY

	JAN	FEB	MAR	APR	MAY	JUN	JUL	AUG	SEP	OCT	NOV	DEC
AVERAGE RAINFALL IN INCHES	4.84"	4.68"	4.88"	4.96"	4.27"	6.50"	7.57"	7.32"	6.02"	4.15"	3.90"	5.25"

THE TOTAL AVERAGE ANNUAL RAINFALL FOR THE PROJECT AREA IS: 5.35 INCHES

THE DESIGN RAIN EVENT FOR THE PROJECT IS: 26YR-24HR

LAST REVISED:
JUNE 2012



www.cphcorp.com
Building Better Communities Together

5200 Butler Rd STE 220
Jacksonville, FL 32216
Tel: 904.333.0999

Plans Prepared By:
Cph Consulting, LLC
A Full Service A & E Firm

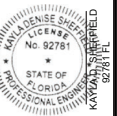

This form has been digitally signed and sealed by H.A.L.G. SHEFFIELD, P.E. on the date adjacent to the seal. Printed copies of this document are not considered signed and sealed and the signature must be verified on any electronic copies.

No.	Date	Revision
1	01/09/08	REV/PREP COUNTY COMMENTS

Designed: H. JOHNSON
Drawn: P. SHEFFIELD
Checked: N. SKELTON
Job No.: W131528
Date: 1/23/08 © 2008

SWPPP DETAILS
MAJOR SITE PLAN - C - STORE
MARION OAKS FLORIDA

THIS SHEET NOT VALID FOR CONSTRUCTION WITHOUT COMPLETE SET OF PLANS.

Sheet No.
SW.5

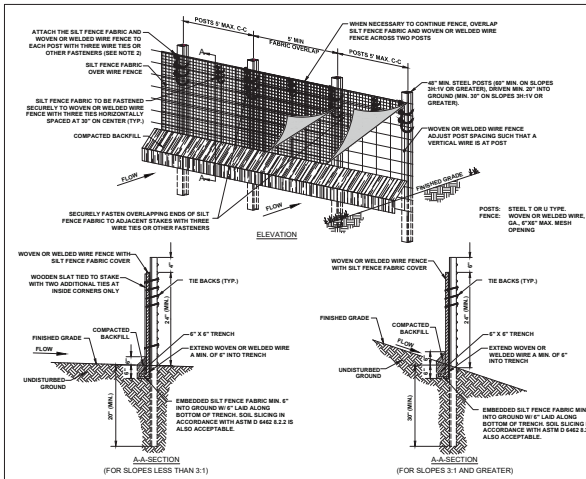

SILT FENCE SECTION	TYPE (WIRE BACK OR SLICED)	SECTION LENGTH (FT)	DRAINAGE AREA (ACRES)	AVERAGE SLOPE OF AREA
N. PROP. LINE BEHIND BLDG.	WIRE	80 LF	0.42	2%
E. & S. SIDE ADJ. TO EASTERN PARCELS	WIRE	1,081 LF	2.82 AC	1.8%
S. PROP. LINE ADJ. TO US 98 & W. SIDE ADJ. TO IMPACTED WETLANDS	WIRE	1,066 LF	2.82 AC	0.7%
W. SIDE ADJ. TO W. POND AREA	WIRE	1,314 LF	4.42 AC	33.3%
N. SIDE OF CONNECTOR RD. TO I.C. DRAIN BLDG. S.E. OF EAST POND	WIRE	1,382 LF	6.27 AC	33.3%

TABLE 1 Temporary Silt Fence Material Property Requirements

Test Method	Units	Specified ¹ Silt Fence	Unspecified ² Silt Fence	Type of Value
Peak Strength	lb/ft ² (kPa)	400 (28)	300 (21)	Minimum
Residual Strength	lb/ft ² (kPa)	400 (28)	300 (21)	Minimum
Permeability ³	in./min.	0.01	0.01	Maximum
Equivalent Opening Size ⁴	mm	100	100	Maximum
Equivalent Density	lb/ft ³ (kg/m ³)	100 (1600)	100 (1600)	Typical

¹ All fences supported head-on and of 14 gage steel mesh with a mesh spacing of 100 mm (4 in.) or perforated polymer mesh of equivalent strength.
² This is typical strength of a typical commercial grade with a mesh spacing of 100 mm (4 in.) or perforated polymer mesh of equivalent strength.
³ Equivalently specified permeability limits are 0.01 in./min. for 100 mm (4 in.) mesh and 0.01 in./min. for 100 mm (4 in.) mesh.
⁴ An equivalent permeability value has not been specified.

SMALL BUSINESS SET-ASIDE NOTICE

LAST REVISED: JUNE 2012

SEDMIMENTATION/SILT FENCE WITH WIRE BACKING

SPECIFICATIONS FOR SILT FENCE INSTALLATION

- MATERIALS AND INSTALLATION SHALL COMPLY WITH ASTM D 6482 LATEST EDITION.
- INSTALL SILT FENCE AT A FAIRLY LEVEL GRADE ALONG THE CONTOUR WITH THE END CURVED UPSTREAM TO PROVIDE SUFFICIENT UPSTREAM STORAGE VOLUME FOR THE ANTICIPATED RUNOFF.
- ATTACH THE SILT FENCE OR FABRIC TO THE WOVEN OR WELDED WIRE FENCE WITH THREE WIRE TIES OR OTHER FASTENERS BONDING ALL SPACES EVERY 20". ALL SPACES WITHIN THE TOP 4" OF THE FABRIC ATTACH EACH TO OCCASIONALLY OR REGULARLY THROUGH THE FABRIC WITH EACH FASTENER AT LEAST 1" VERTICALLY APART. AT EACH POST ATTACH THE SILT FENCE OR FABRIC TO THE WOVEN OR WELDED WIRE FENCE TO THE POST AS PREVIOUSLY STATED. IN ADDITION, EACH END PLACEMENT POST SHOULD BE FASTENED TO WARE OR A POST NIPPLE WHICH IS FASTENED TO PREVENT SLIDING.
- WHEN TWO SECTIONS OF SILT FENCE FABRIC ADJOIN EACH OTHER, THEY SHALL BE OVERLAPPED A MINIMUM OF 4" ACROSS TWO POSTS, AS SHOWN.
- ALL SILT FENCE SHALL INCLUDE WIRE SUPPORT UNLESS THE STATIC SLICING EQUIPMENT IS UTILIZED TO INITIAL THE FENCE FOR DETAIL. DETAIL FENCE INSTALLATION SLICING METHOD.
- WEAP APPROXIMATELY 4" OF FABRIC AROUND THE END POSTS AND SECURE WITH TIES.
- COMPACT THE SOIL IMMEDIATELY NEAR TO THE SILT FENCE FABRIC WITH THE FRONT WHEEL OF THE TRACTOR, SKID STEER, OR ROLLER EXERTING AT LEAST 400 LBS PER SQ. YD. COMPACT THE UPSTREAM SIDE FIRST. COMPACT EACH SIDE TWICE FOR A TOTAL OF FOUR TIPS. END POST CAPS AS NEEDED BASED ON SITE CONDITIONS AND APPLICABLE AGENCY REQUIREMENTS.

MAINTENANCE SITES

- SILT FENCES SHALL BE INSPECTED ALONG ITS ENTIRETY AND MUST BE CLEANED WHEN SEDIMENT HAS ACCUMULATED TO ONE-THIRD THE HEIGHT OF THE SILT FENCE. MAINTENANCE CLEAROUT MUST BE CONDUCTED REGULARLY TO PREVENT ACCUMULATED SEDIMENTS FROM REACHING OR BEHIND THE HEIGHT OF THE SILT FENCE.
- ALL MATERIAL ELICITATED FROM BEHIND SILT FENCE SHALL BE STOCKPILED ON AN UP-LAND PORTION OF THE SITE IS SUITABLE FOR REUSE.
- SPECIAL ATTENTION SHOULD BE PAID TO INSURE THAT NO UNDERMINING OF SILT FENCE HAS OCCURRED AND THAT NO BYPASS IS OCCURRING AT SPECIAL JOINTS.
- IF EXCESS SEDIMENT IS ACCUMULATING IN ANY SECTION OF SILT FENCE, THE CONTRACTOR SHOULD IMPLEMENT ADDITIONAL UPSTREAM STABILIZATION MEASURES OR ADDITIONAL BARRS PENDING CEC APPROVAL TO PREVENT EXCESSIVE EROSION ON SILT FENCE.
- SILT FENCES SHALL BE REPAIRED TO THEIR ORIGINAL CONDITIONS IF DAMAGED.

LAST REVISED: JUNE 2012

NOTES:

- CONSIDERATION MUST BE GIVEN TO ANTICIPATE CLIMATE AND SEASONAL CONDITIONS WHEN PLANTING SEED.
- SEED SHALL BE FREE OF WEEDY SPECIES AND APPROPRIATE FOR SITE SOILS AND RESIDUAL CLIMATE. SEED AND MULCH PER THE CONSTRUCTION DRAWINGS AND THE 2000 PLANTING SPECIFICATION IMMEDIATELY AFTER TOPSOIL IS APPLIED AND FINAL GRADE IS REACHED.
- THE SITE HAS ACHIEVED FINAL STABILIZATION ONCE ALL AREAS ARE COVERED WITH BUILDING FOUNDATION OR PAVEMENT. SITE OR TEMPORARILY CEASED ON ANY PORTION OF THE SITE AND WILL NOT LATELY REQUIRE FOR A PERIOD EXCEEDING 14 CALENDAR DAYS.
- VEGETATED AREAS MUST BE WATERED, FERTILIZED, AND RESEED AS NEEDED TO ACHIEVE THIS REQUIREMENT.
- THE VEGETATION DENSITY MUST BE MAINTAINED THROUGHOUT PROJECT COMPLETION TO BE CONSIDERED STABILIZED. AREAS PROTECTED BY EROSION CONTROL, SLURRY WALLS, AND PERMANENTLY STABILIZED UNITS, THE APPLICABLE GENERAL CONTRACTIVE SPECIFICATIONS SHALL APPLY.
- RIP-RAP, MULCH, GRAVEL, DECOMPOSED GRANITE OR OTHER EQUIVALENT PERMANENT STABILIZATION MEASURES MAY BE EMPLOYED IN LIEU OF VEGETATION BASED ON SITE-SPECIFIC CONDITIONS, DESIGN AND GOVERNING AUTHORITY APPROVAL.
- ALL VEGETATED AREAS SHALL BE INSPECTED REGULARLY TO CONFIRM THAT A HEALTHY STAND OF GRASS IS MAINTAINED.

SEEDING/VEGETATION REQUIREMENTS

LAST REVISED: JUNE 2012

NOTES:

- THE GC IS REQUIRED TO, AT A MINIMUM, WITH THE SILT STABILIZATION MEASURES IMMEDIATELY FOLLOWING ANY CLEARING, GRADING, EXCAVATING OR OTHER EARTH DISTURBING ACTIVITIES HAVE PERMANENTLY CEASED ON ANY PORTION OF THE SITE OR TEMPORARILY CEASED ON ANY PORTION OF THE SITE AND WILL NOT LATELY REQUIRE FOR A PERIOD EXCEEDING 14 CALENDAR DAYS.
- THE GC HAS 7 DAYS FROM INITIATION OF STABILIZATION TO COMPLETE SOIL PREPARATION, SEEDING, MULCHING, AND ANY OTHER REQUIRED ACTIVITIES RELATED TO THE PLANTING AND ESTABLISHMENT OF VEGETATION. THE GC ALSO HAS 7 DAYS FROM INITIATION OF STABILIZATION TO COMPLETE INITIAL NON-VEGETATED AREAS, IF UTILIZED.
- ALL DISTURBED AREAS MUST BE STABILIZED TEMPORARILY WITH THE USE OF FAST-GROWING ANNUAL GRASS OR ANNUAL GRASSES APPROPRIATE FOR SITE SOIL AND CLIMATE CONDITIONS. MULCH IS REQUIRED FOR ALL SEEDING APPLICATIONS, AND ALL MULCH APPLICATIONS MUST INCLUDE A SUITABLE FORM OF MULCH ANCHORING TO MINIMIZE MOVEMENT OF MULCH BY WIND OR WATER.
- ALTERNATIVE STABILIZATION MEASURES TO SEEDING, SUCH AS ANCHORED MULCH APPLICATION (WITHOUT SEEDING), MAY BE UTILIZED DURING PERIODS WHEN VEGETATIVE GROWTH IS SLOW (E.G. WINTER MONTHS).
- IT IS NOT ACCEPTABLE TO ALLOW BARE SOIL TO REMAIN EXPOSED AT ANY TIME DURING THE YEAR, REGARDLESS OF WEATHER-INDUCED EROSION CONDITIONS.
- ALTERNATIVE STABILIZATION MEASURES INCLUDE, BUT ARE NOT LIMITED TO: ANCHORED STRAWHAY MULCH, WOOD CELLULOSE FIBER MULCH, SPRAK-ON SOIL GLUE/STABILIZERS, AND ROLLED EROSION CONTROL PRODUCTS.
- ALL ROLLED EROSION CONTROL PRODUCTS SHALL HAVE CURRENT QUALITY STATUS ISSUED BY THE EROSION CONTROL TECHNOLOGY COUNCIL (ETC) PLUS ANY STATE OR AGENCY-SPECIFIC REQUIREMENTS. EVIDENCE OF QUALITY APPROVAL SHALL ACCOMPANY THE PRODUCT SHIPPED TO THE JOBSITE FOR READY IDENTIFICATION BY THE CONTRACTOR OR AGENCY INSPECTOR.
- ROLLED EROSION CONTROL PRODUCTS (NETS, BLANKETS, REEF REINFORCED MATES, AND VEGETATED AREAS NOT INCLUDING VEGETATION) ARE NOT PERMITTED FOR FINAL STABILIZATION. FINAL STABILIZATION MUST BE COMPLETED DAILY. MULCH, SEEDING AND OTHER TYPES OF EROSION CONTROL. THE SPECIFIC EROSION CONTROL DEVICE IS NOT FUNCTIONING OR INSTALLED IMPROPERLY AND/OR ADDITIONAL EROSION CONTROL DEVICES ARE WARRANTED.

TEMPORARY SEEDING OR STABILIZATION

LAST REVISED: JUNE 2012

NOTES:

- PERMANENT STABILIZATION SHALL BE ACCOMPLISHED IN ALL DISTURBED AREAS BY COVERING THE SOIL WITH PAVEMENT, BUILDING STRUCTURE, VEGETATION, OR OTHER FORMS OF SOIL STABILIZATION.
- THE GC IS REQUIRED TO INITIATE PERMANENT SOIL STABILIZATION MEASURES IMMEDIATELY UPON REACHING FINAL GRADE. FOR THOSE AREAS NOT AT FINAL GRADE THAT WILL NOT BE DISTURBED FOR GREATER THAN 14 DAYS, THE CONTRACTOR SHOULD INITIATE TEMPORARY STABILIZATION PER THE TEMPORARY SEEDING OR STABILIZATION DETAIL.
- THE GC HAS 7 DAYS FROM INITIATION OF STABILIZATION TO COMPLETE SOIL PREPARATION, SEEDING, MULCHING, AND ANY OTHER REQUIRED ACTIVITIES RELATED TO THE PLANTING AND ESTABLISHMENT OF VEGETATION. THE GC ALSO HAS 7 DAYS FROM INITIATION OF STABILIZATION TO COMPLETE INITIAL NON-VEGETATED AREAS, IF UTILIZED.
- SOILS MUST BE PREPARED BEFORE INSTALLATION OF SOIL SEED. SEE CEC99 SPECIFICATION FOR INSTRUCTION ON PROPER SOIL PREPARATION.
- AT THE COMPLETION OF EROSION DISTURBING ACTIVITIES, THE ENTIRE SITE MUST HAVE PERMANENT VEGETATIVE COVER MEETING VEGETATION DENSITY REQUIREMENTS IN THE GENERAL PERMIT, OR MULCH FOR LANDSCAPE PLAN, IN ALL AREAS NOT COVERED BY SLURRY WALLS, PAVEMENT, BUILDINGS, ETC.
- SEEDING AREAS SHALL BE PROTECTED WITH STRAW MULCH, HYDRALIC MULCH OR A ROLLED EROSION CONTROL PRODUCT. STRAW MULCH MUST BE TACKLED OR CHIPPED BY DISC OR OTHER MACHINERY, AND ROLLED EROSION CONTROL PRODUCTS MUST BE INSTALLED PER MANUFACTURER RECOMMENDATIONS. ONE ROLLED EROSION CONTROL PRODUCT ARE PERMITTED TO BE USED IN FLOW CONVEYANCES.
- ALL AREAS TO BE SEEDING MUST MEET TOPSOIL, SPFH, PH AND ORGANIC CONTENT REQUIREMENTS.
- FINAL SITE STABILIZATION IS ACHIEVED WHEN PERMANENT VEGETATIVE COVER PROVIDES PERMANENT STABILIZATION WITH A UNIFORM DENSITY GREATER THAN 20% PRESENT OVER THE ENTIRE AREA TO BE STABILIZED BY VEGETATIVE COVER. THIS AREA IS EXCLUSIVE OF AREAS THAT ARE COVERED WITH ROCK, COVERED GRANITE, GRAVEL, ETC. OR LANDSCAPE MULCH, PAVED OR HAVE A BUILDING OR OTHER PERMANENT STRUCTURE ON THEM.

PERMANENT SEEDING, SOD OR MULCHING

LAST REVISED: JUNE 2012



www.cphcorp.com

Building Better Communities Together
 5200 Bethel Rd STE 200
 Jacksonville, FL 32256
 Tel: 904.323.0889

Plans Prepared By:
 CPH Consulting, LLC
 A Full Service A & E Firm

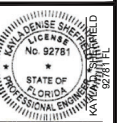

This form has been digitally signed and sealed by Kevin J. Sheffield, P.E. on the date adjacent to the seal. Printed copies of this document are not considered signed and sealed and the signature must be verified on any electronic copies.

No.	Date	REVISED COUNTY COMMENTS	Revision
1	07/02/09		

Designed: H. JOHNSON
 Drawn: P. SHEFFIELD
 Job No.: W131528

Date: 1/23/26 © 2026

SWPPP DETAILS
 MAJOR SITE PLAN - C - STORE
 MARION OAKS FLORIDA

This sheet NOT VALID FOR CONSTRUCTION WITHOUT COMPLETE SET OF PLANS.
 Sheet No. SW.7

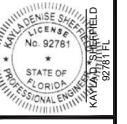

This form has been digitally signed and sealed by N. P. Skelton, P.E. on the date adjacent to the seal. Printed copies of this document are not considered signed and sealed and the signature must be verified on any electronic copies.

No.	Date	Revision	REV. PREP. COUNTY COMMENTS
1	01/02/08		

Designed: H. JOHNSON
 Drawn: P. SHEFFIELD
 Checked: N. SKELTON
 Job No.: W131528
 Date: 1/23/08 © 2008

SWPPP DETAILS
 MAJOR SITE PLAN - C - STORE
 MARION OAKS FLORIDA

THIS SHEET NOT VALID FOR CONSTRUCTION WITHOUT COMPLETE SET OF PLANS.

Sheet No.
SW.8

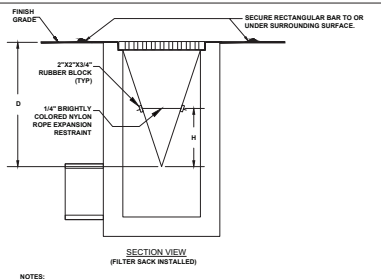
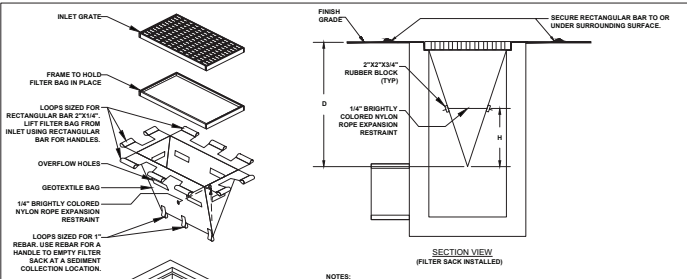

- NOTES:**
- GEOTEXTILE SHALL BE A WOVEN POLYPROPYLENE FABRIC THAT MEETS OR EXCEEDS REQUIREMENTS IN THE SPECIFICATIONS TABLE.
 - PLACE AN OIL ABSORBENT PAD OR FLOW OVER INLET GRATE WHEN OIL SPILLS ARE A CONCERN.
 - THE WIDTH "W" OF THE FILTER SACK SHALL MATCH THE INSIDE WIDTH OF THE GRATED INLET BOX.
 - THE DEPTH "D" OF THE FILTER SACK SHALL BE BETWEEN 18 INCHES AND 30 INCHES.
 - THE LENGTH "L" OF THE FILTER SACK SHALL MATCH THE INSIDE LENGTH OF THE GRATED INLET BOX.
- MAINTENANCE NOTES:**
- INLET PROTECTION DEVICES MUST BE INSPECTED FOR SEDIMENT ACCUMULATION WITHIN THE CATCH BASIN. REMOVE TRAPPED SEDIMENT WHEN BRIGHTLY COLORED EXPANSION RESTRAINT CAN NO LONGER BE SEEN.
 - REMOVAL OF SEDIMENT ACCUMULATED IN OR ADJACENT TO A STORM DRAIN INLET MUST BEGAIN IMMEDIATELY UPON DISCOVERY, WITH COMPLETION OF THE ACTIVITY OCCURRING NO LATER THAN THE END OF THE FOLLOWING BUSINESS DAY.
 - INLET PROTECTION DEVICES SHALL BE INSPECTED FOR UNINTENDED BYPASS OR IMPROPER FLOW-RATES THAT MAY CAUSE DOWNSTREAM FLOODING.
 - CONTACT THE CEC FOR ALTERNATE INLET PROTECTION IF THE DESIGNED PROTECTION MAY IMPACT DOWNSTREAM BMPs, ADJACENT SLOPES, ETC. DUE TO PONDING ISSUES. ENSURE THAT NO UNDERMINING OF INLET PROTECTION DEVICES HAS OCCURRED.
 - INLET PROTECTION DEVICES AND BARRIERS SHALL BE REPAIRED OR REPLACED IF THEY SHOW SIGNS OF UNDERMINING OR DETRIORATION.

LOW TO MODERATE FLOW GEOTEXTILE FABRIC SPECIFICATION TABLE			MODERATE TO HIGH FLOW GEOTEXTILE FABRIC SPECIFICATION TABLE		
PROPERTIES	TEST METHOD	UNITS	PROPERTIES	TEST METHOD	UNITS
GRAB TENSILE STRENGTH	ASTM D-4832	300 LBS	GRAB TENSILE STRENGTH	ASTM D-4832	265 LBS
GRAB TENSILE ELONGATION	ASTM D-4832	20 %	GRAB TENSILE ELONGATION	ASTM D-4832	20 %
PUNCTURE	ASTM D-4833	120 LBS	PUNCTURE	ASTM D-4833	135 LBS
MULLIN BURST	ASTM D-3786	165 PSF	MULLIN BURST	ASTM D-3786	420 PSF
TRAPEZOID TEAR	ASTM D-4833	120 LBS	TRAPEZOID TEAR	ASTM D-4833	45 LBS
UV RESISTANCE	ASTM D-4355	95 %	UV RESISTANCE	ASTM D-4355	95 %
APPARENT OPENING SIZE	ASTM D-4751	40 US SIEVE	APPARENT OPENING SIZE	ASTM D-4751	20 US SIEVE
FLOW RATE	ASTM D-4491	40 GAL/MIN/100 FT	FLOW RATE	ASTM D-4491	200 GAL/MIN/100 FT
PERMITTIVITY	ASTM D-4491	0.85 SEC-1	PERMITTIVITY	ASTM D-4491	1.5 SEC-1

IP1 INLET PROTECTION FILTER SACK
 N.P.S.
 FOR USE ONLY IN PAVED AREAS WHERE SEDIMENT LOADS ARE EXPECTED TO BE VERY LOW. FILTER SACK MUST HAVE OVERFLOW HOLES TO PREVENT PONDING.

LAST REVISED:
 APRIL 30, 2011

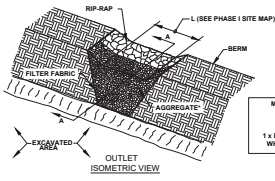
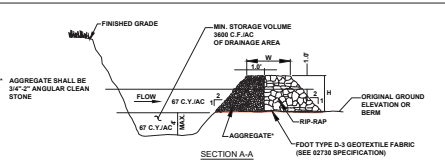

SEDIMENT TRAPS								
TRAP NAME	L	W	H	DRAINAGE AREA (ACRES)	DESIGN VOLUME (CU.FT.)	DESIGNED RETENTION TIME (HRS)	PERMANENT (Y OR N)	EMERGENCY OUTLET TYPE

- MAINTENANCE NOTES:**
- SEDIMENT TRAPS MUST BE INSPECTED AND MUST BE CLEANED WHEN THE ORIGINAL CAPACITY HAS BEEN REDUCED BY 50 PERCENT OR LESS AS REQUIRED BY THE GOVERNING AGENCY.
 - ALL MATERIAL EXCAVATED FROM BEHIND SEDIMENT BARRIERS OR FROM TRAPS SHALL BE INCORPORATED INTO ON-SITE SOILS OR SPREAD OUT ON AN UPLAND PORTION OF THE SITE AND STABILIZED.
 - VERIFY THAT NO EROSION IS OCCURRING AT DISCHARGE POINTS TO AND FROM IMPOUNDMENTS AND VERIFY THAT TRAP SIDE SLOPES ARE STABILIZED AND SHOW NO SIGNS OF EROSION.

TEMPORARY SEDIMENT TRAP
 N.P.S.

LAST REVISED:
 JUNE 2012

- EDITOR NOTES:**
- COMPLETE THE SEDIMENT TRAP TABLE TO PROVIDE DIMENSIONS, DRAINAGE AREAS AND VOLUME CALCULATIONS FOR EACH AND EVERY SEDIMENT TRAP SHOWN ON THE SITE MAPS, AS STIPULATED IN THE CONSTRUCTION GENERIC PERMIT, AGENCY REQUIREMENTS, OR STANDARD ENGINEERING PRACTICE. DEMONSTRATE ADEQUATE VOLUME TO RETAIN RUNOFF AND ALLOW SETTLEMENT OF SUSPENDED SOILS BEFORE DISCHARGING DOWNSTREAM OR BEFORE DEWATERING.
 - STATE THE TRAPS, IF ANY, WHICH WILL BE CONVERTED TO A PERMANENT STORMWATER BMP AT THE COMPLETION OF THE CONSTRUCTION PROJECT.

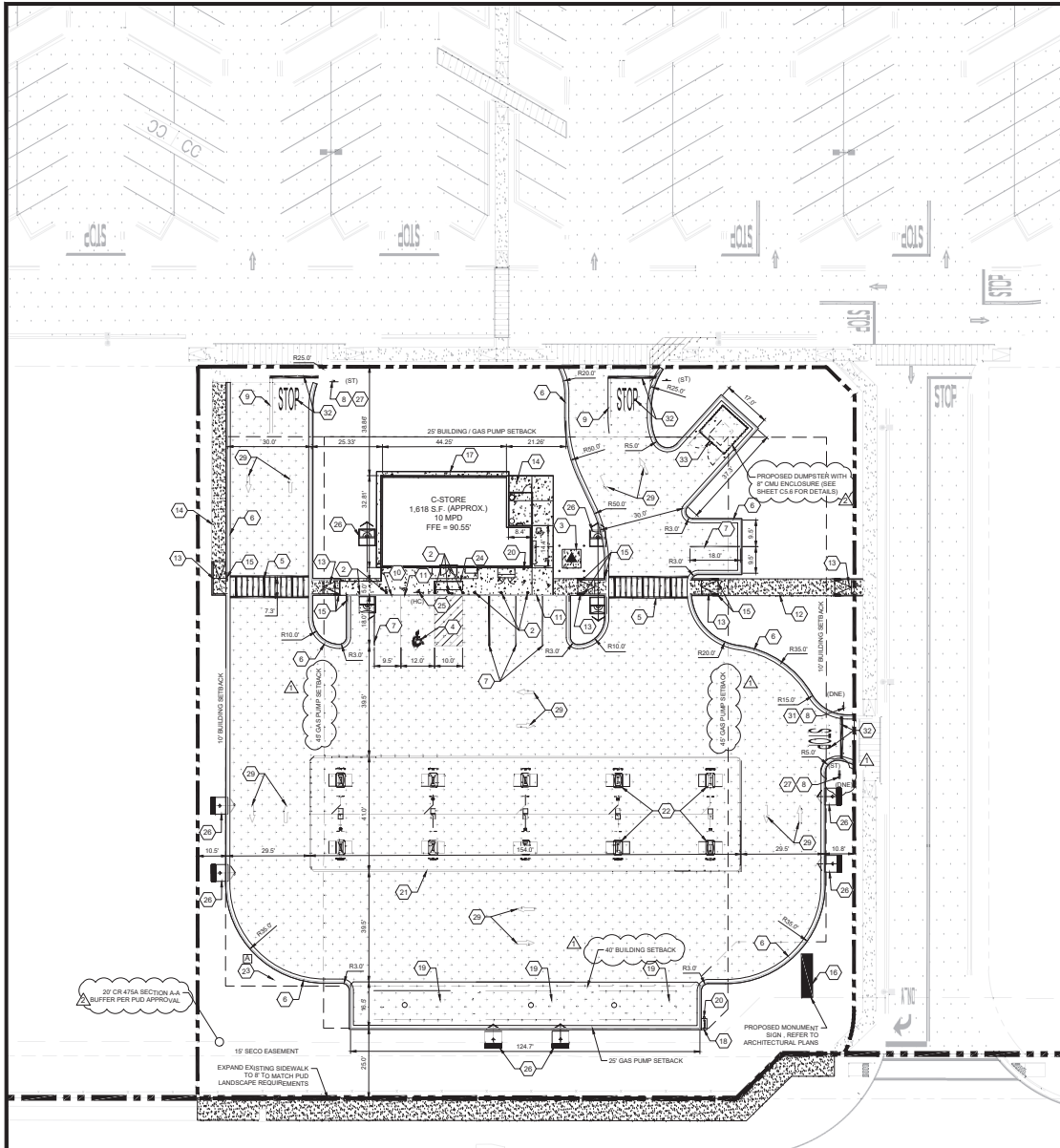

S.W. HIGHWAY No. 484
(R/W WIDTH VARIES - 4 LANE DIVIDED HIGHWAY)

SIGN LEGEND

- (PC) ACCESSIBLE PARKING (FTP-21-06 & FTP-22-06)
- (ST) STOP (R1-1)
- (PE) STOP HERE FOR PEDESTRIANS (SEE DETAIL SHEET)

PROPOSED PAVEMENT LEGEND

- SIDEWALK: PER DETAIL SHEET
- ARCH. CONCRETE: PER ARCH. PLAN
- HEAVY DUTY CONCRETE PAVEMENT: PER DETAIL SHEET
- PARKING SPACE CURB
- SITE LIGHTING, REF. PHOTOMETRIC PLANS
- TRANSFORMER

PROPOSED LEGEND

- PROPERTY LINE
- PROPOSED BUFFER LINE
- LANDSCAPE BUFFER LINE
- BUILDING SETBACK LINE

PAINTING STRIPING LEGEND

- SW/L SINGLE WHITE SOLID LINE
- DYSL DOUBLE YELLOW SOLID LINE

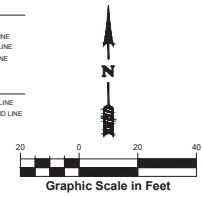

SITE LEGEND

- 1 BUILDING SETBACK LINE PER ZONING RESOLUTION.
- 2 PIPE BOLLARD, REF. ARCH. PLANS.
- 3 CONCRETE TRANSFORMER PAD. CONTRACTOR TO COORDINATE WITH UTILITY PROVIDER FOR DETAILS.
- 4 ACCESSIBLE PARKING SPACE PER FDOT INDEX NO. 711-001 AND SIGNAGE PER FOOT INDEX NO. 700-102 TYPICAL. SEE DETAIL SHEET CS.4 & CS.5
- 5 PEDESTRIAN CROSSWALK. SEE PLAN FOR WIDTH. SEE DETAIL SHEET CS.4 BY OTHERS.
- 6 18" CONCRETE CURB AND GUTTER TYPICAL. SEE DETAIL SHEET CS.2.
- 7 PROPOSED SW/L 4".
- 8 NEW SIGN MOUNTING AND BASE WITH BREAK AWAY POST.
- 9 PROPOSED DYSL 4" (LINES) TO BE EXTENDED FROM THE STOP BAR (CROSSWALK). REFER TO DETAIL SHEET CS.3.
- 10 FLUSH PAVEMENT AND SIDEWALK AREA.
- 11 COORDINATE WITH DEVELOPER'S CONTRACTOR TO CONSTRUCT SMOOTH TRANSITION TO EXISTING CURB AND PAVEMENT.
- 12 PROPOSED CONCRETE SIDEWALK. 3% MAX. LONGITUDINAL SLOPE. 2% MAX. CROSS SLOPE.
- 13 PROPOSED ACCESSIBLE CURB RAMP. 1:12 MAX. SLOPE WITH 2" DEEP DETECTABLE WARNING. PER FOOT INDEX 522.002.
- 14 CONCRETE SIDEWALK. REFER ARCH. PLAN FOR SPECIFICATION AND DETAILS.
- 15 NOSE DOWN CURB. REFER TO DETAIL SHEET C-5.2
- 16 PROPOSED SINGLE TENANT MONUMENT SIGN. REFER TO ARCHITECTURAL PLANS FOR DETAILS.
- 17 PROPOSED CONCRETE RODENT BARRIER. REFER ARCH. PLANS FOR DETAILS.
- 18 PROPOSED TANK VENT SYSTEM. REF. FUEL PLANS FOR DETAILS.
- 19 PROPOSED UNDERGROUND FUEL STORAGE TANKS. REF. FUEL PLANS FOR DETAILS.
- 20 PROPOSED E-STOP. REFER ARCH. PLANS FOR DETAILS.
- 21 PROPOSED GAS CANOPY. REFER ARCH. PLANS FOR DETAILS.
- 22 PROPOSED FUEL DISPENSER (TYP.). REFER FUEL PLANS FOR DETAILS.
- 23 PROPOSED AIR STATION. REFER ARCH. PLANS FOR DETAILS.
- 24 PROPOSED TACTILE WARNING. REFER ARCH. PLANS.
- 25 NEW SIGN MOUNTING AND BASE WITH BOLLARD. SEE DETAIL PAGE CS.5
- 26 PROPOSED SITE LIGHTING POLE (TYP.). REF. PHOTOMETRIC PLANS.
- 27 PROPOSED "STOP" SIGN.
- 28 PROPOSED STOP TEXT AND STOP BAR USING THERMOPLASTIC PAINT.
- 29 PROPOSED OPEN ARROW PAVEMENT MARKINGS USING THERMOPLASTIC PAINT.
- 30 PROPOSED "YIELD" SIGN.
- 31 PROPOSED "DO NOT ENTER" SIGN.
- 32 STOP BAR AND STOP TEXT. REFER TO DETAIL SHEET CS.3.
- 33 PROPOSED DUMPSTER WITH 6" CMU ENCLOSURE. REFER TO ARCH. PLANS FOR DUMPSTER DETAIL.

SITE DATA INFORMATION:

SITE PARCEL NUMBERS:

PARCEL NO. 4129-000-01
T.R.D. SW HIGHWAY 484
ADDRESS: 80.32 S.F. (1.83 AC.)

ON-SITE LAND INFORMATION:

CURRENT LAND USE: VACANT LAND
PROPOSED LAND USE: FUEL STATION

CURRENT ZONING: PLANNED UTL DEVELOPMENT (PUD)
PROPOSED ZONING: PUD CASE NUMBER 1911072C

AREA OF PROPOSED IMPROVEMENTS: 60,972 S.F. (1.39 AC.)
DEVELOPMENT TYPE: COMMERCIAL

ADJACENT LAND INFORMATION:

	NORTH	EAST	SOUTH	WEST
EXISTING LAND USE:	VACANT.	VACANT.	ROW	MR
FUTURE LAND USE:	EC	EC	ROW	MR
EXISTING ZONING:	PLD	PLD	ROW	R-1
PROPOSED ZONING:	PLD	PLD	ROW	R-1

FLOOD ZONE INFORMATION:

HAVING CONSULTED THE NATIONAL FLOOD INSURANCE PROGRAM, FLOOD INSURANCE RATE MAP (FIRM) NUMBER 1208320715D, COMMUNITY PANEL NO. 120160, MARION COUNTY UNINCORPORATED AREAS, EFFECTIVE DATE AUGUST 28, 2009, THE SUBJECT PROPERTY APPEARS TO LIE IN ZONE X, THE FLOOD ZONE WITH A 0.2% ANNUAL CHANCE FLOOD HAZARD. AREAS WITH A 1% ANNUAL CHANCE FLOOD W/ AVERAGE DEPTH LESS THAN 1 FOOT - MINIMAL FLOOD HAZARD

BUILDING INFORMATION:

BUILDING AREA: 1,618 S.F.
BUILDING USE: FUEL STATION
MAXIMUM BUILDING HEIGHT (COUNTY CODE): 50'-0"
ACTUAL BUILDING HEIGHT (ONE STORY): 19'-0"
CANOPY HEIGHT: 17'-8"
MAXIMUM FLOOR AREA RATIO (FAR) (COUNTY CODE): 1.0
MAXIMUM FLOOR AREA RATIO (FAR) PROVIDED: 3.23%

PERVIOUS / IMPERVIOUS AREAS:

	PRE DEVELOPMENT:	PERVIOUS AREA:	IMPERVIOUS AREA:	TOTAL SITE AREA:
	60,972 S.F. (1.39 AC.) (100.00%)	0 S.F. (0.00 AC.) (0.00%)	0 S.F. (0.00 AC.) (0.00%)	60,972 S.F. (1.39 AC.) (100.00%)
	21,312 S.F. (0.49 AC.) (35.00%)	39,262 S.F. (0.90 AC.) (65.00%)	80,272 S.F. (1.39 AC.) (100.00%)	

PARKING INFORMATION:

PARKING REQUIRED:
USE TYPE: GAS STATION
4 SPACES PER 1,000 SQFT GLA
1,618 SF / 1,000 SF = 6.4 SPACES REQUIRED
PARKING SPACES PROVIDED = 9 (INC. 1 ADA SPACE)

BLDG. SETBACKS AND LANDSCAPE BUFFERS:

BLDG. SETBACKS:	NORTH	SOUTH	EAST	WEST
REQUIRED:	25'	40'	10'	0'
PROVIDED:	39'	189'	65'	115'
LANDSCAPE BUFFERS:	NORTH	SOUTH	EAST	WEST
REQUIRED:	0'	15'	20'	0'
PROVIDED:	0'	20'	0'	0'
ACCESSORY STRUCTURE (GAS PUMP) SETBACK:	NORTH	SOUTH	EAST	WEST
REQUIRED:	25'	25'	45'	45'
PROVIDED:	139'	81'	50'	49'

NOTES:

- ITEMS SHOWN SCREENED REPRESENT EXISTING CONDITIONS. ITEMS SHOWN BOLD REPRESENT PROPOSED CONDITIONS.
- GAS PUMP CANOPY MAY INTRUDE UP TO 10 FT. INTO REQUIRED SETBACK.

cph
www.cphcorp.com
Building Better Communities Together
5200 Butler Rd STE 200
Jacksonville, FL 32216
Tel: (904) 323-0399

Plans Prepared By:
CPH Consulting, LLC
A Full Service A & E Firm

FLORIDA PROFESSIONAL ENGINEER
No. 92781
KAYLA D. SHEFFIELD
92781 FL

This item has been digitally signed and sealed by KAYLA D. SHEFFIELD, P.E. in the case assigned to the seal. The seal is not considered signed and sealed and the signature must be verified on any electronic copies.

No.	Date	Revision
1	03/02/26	REV PRELIM ROUND OF COUNTY COMMENTS
2	07/01/26	REV PRELIM COUNTY COMMENTS

Designed: H. JOHNSON
Drawn: P. SHEFFIELD
Checked: N. SKELTON
Job No.: W131528

Date: 1/23/26

© 2026

SITE DIMENSION PLAN
 MAJOR SITE PLAN - C - STORE
 MARION OAKS FLORIDA

THIS SHEET NOT VALID FOR CONSTRUCTION WITHOUT COMPLETE SET OF PLANS.
Sheet No. C1.2

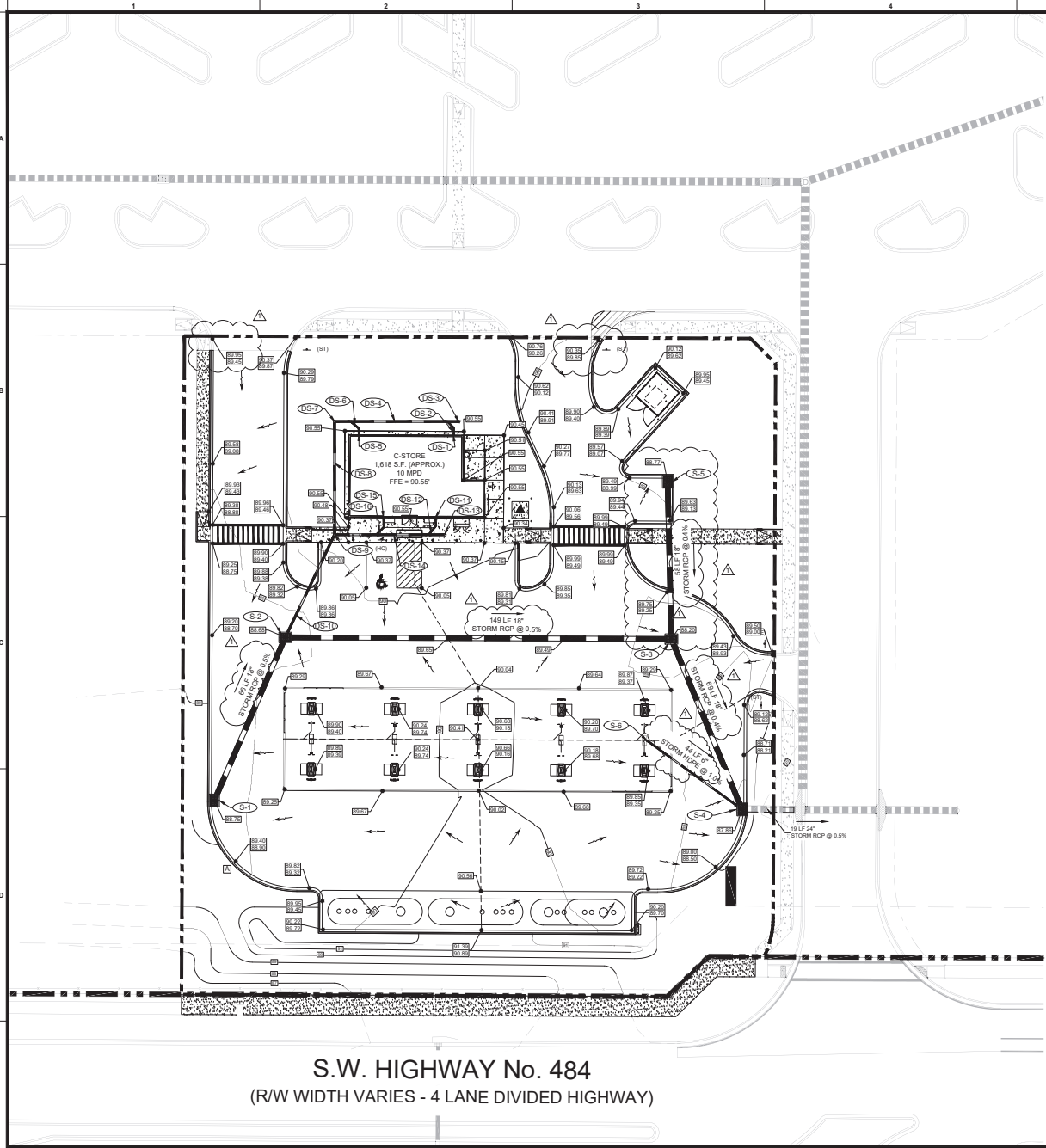

S.W. HIGHWAY No. 484
(R/W WIDTH VARIES - 4 LANE DIVIDED HIGHWAY)

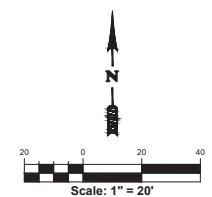

LEGEND

	PROPERTY LINE
	CONTOUR ELEVATION
	HIGH POINT
	STORM PIPE
	TOP OF CURB ELEV.
	PAVEMENT ELEV.
	DIRECTION OF FLOW
	SLOPE OF FLOW
	HANDICAP RAMP 1:12 SLOPE (MAX)
	DITCH BOTTOM INLET

STORM STRUCTURE SCHEDULE			
STRUCTURE NUMBER	STRUCTURE TYPE	TOP ELEVATION	INVERTS
S-1	TYPE 'C' INLET PER FOOT INDEX NO.425-010	88.75	NE. F.L. = 83.17
S-2	TYPE 'C' INLET PER FOOT INDEX NO.425-010	88.68	SW. F.L. = 82.82 NE. F.L. = 88.18 E. F.L. = 82.82
S-3	TYPE 'C' INLET PER FOOT INDEX NO.425-010	89.20	W. F.L. = 82.05 SE. F.L. = 82.05 E. F.L. = 82.05 NW. F.L. = 83.02
S-4	CONTOUR CORNER-SIC	87.88	E. F.L. = 81.68 NW. F.L. = 83.02
S-5	TYPE 'C' INLET PER FOOT INDEX NO.425-010	88.77	S. F.L. = 82.05
S-6	CONNECT TO CANOPY DRAINAGE	N/A	SE. F.L. = 82.44

STORM DOWNSPOUT SCHEDULE			
STRUCTURE NUMBER	STRUCTURE TYPE	TOP ELEVATION	INVERTS
DS-1	CONNECT TO BUILDING DOWNSPOUT RE. ARCHMEP PLANS	N/A	88.94
DS-2	7' L.F. 6" ROOF DRAIN CONNECTION @ 1.50%	N/A	84.84
DS-3	8" WYE W/ CLEANOUT	90.57	84.91
DS-4	40' L.F. 8" HDPE STORMPIPE @ 1.50%	N/A	N/A
DS-5	CONNECT TO BUILDING DOWNSPOUT RE. ARCHMEP PLANS	N/A	84.36
DS-6	7' L.F. 6" ROOF DRAIN CONNECTION @ 1.50%	N/A	84.26
DS-7	8" WYE W/ CLEANOUT	90.50	84.17
DS-8	45' L.F. 8" HDPE STORMPIPE @ 1.50%	N/A	N/A
DS-9	8" WYE W/ CLEANOUT	90.35	83.50
DS-10	47' L.F. 8" HDPE STORMPIPE @ 1.50%	N/A	N/A
DS-11	CONNECT TO BUILDING DOWNSPOUT RE. ARCHMEP PLANS	N/A	84.14
DS-12	7' L.F. 6" ROOF DRAIN CONNECTION @ 1.50%	N/A	84.06
DS-13	8" WYE W/ CLEANOUT	90.43	84.16
DS-14	44' L.F. 8" HDPE STORMPIPE @ 1.50%	N/A	N/A
DS-15	CONNECT TO BUILDING DOWNSPOUT RE. ARCHMEP PLANS	N/A	83.83
DS-16	7' L.F. 6" ROOF DRAIN CONNECTION @ 1.50%	N/A	83.75

Always call 811 two full business days before you dig

www.sunshine811.com

cph
www.cphcorp.com
Building Better Communities Together

5200 Butler Rd STE 220
Jacksonville, FL 32216
Tel: 904.323.0999

Plans Prepared By:
CPH Consulting, LLC
A Full Service A & E Firm

PROFESSIONAL ENGINEER
KAYLA D. SHEFFIELD
No. 92781
STATE OF FLORIDA
92781

This item has been digitally signed and sealed by KAYLA D. SHEFFIELD, P.E. on the data adjacent to the seal. Printed copies of this document are not considered signed and sealed and the signature must be verified on any electronic copies.

No.	Date	Revision
1	11/01/20	REV PREL 2ND ROUND OF COUNTY COMMENTS
2	03/27/21	REV PREL 2ND ROUND OF COUNTY COMMENTS

Designed: H. JOHNSON
Drawn: P. SHEFFIELD
Checked: N. SKELTON
Job No.: W131528
Date: 1/23/26

SITE GRADING PLAN
MAJOR SITE PLAN - C - STORE
MARION OAKS FLORIDA

THIS SHEET NOT VALID FOR CONSTRUCTION WITHOUT COMPLETE SET OF PLANS.

Sheet No.
C1.3

MAJOR SITE PLAN - C - STORE
MARION OAKS FLORIDA

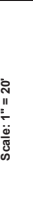
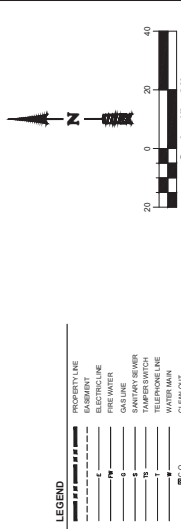

NOTE: ALL WORK SHALL BE PERFORMED IN ACCORDANCE WITH THE MARION COUNTY STANDARD SPECIFICATIONS FOR ROAD AND UTILITY CONSTRUCTION. THE CONTRACTOR SHALL BE RESPONSIBLE FOR OBTAINING ALL NECESSARY PERMITS FROM THE MARION COUNTY ENGINEERING DEPARTMENT. THE CONTRACTOR SHALL BE RESPONSIBLE FOR OBTAINING ALL NECESSARY PERMITS FROM THE MARION COUNTY ENGINEERING DEPARTMENT. THE CONTRACTOR SHALL BE RESPONSIBLE FOR OBTAINING ALL NECESSARY PERMITS FROM THE MARION COUNTY ENGINEERING DEPARTMENT.

WATER LEGEND
1 REMOVE CMP AND CONNECT TO EXISTING STUB OUT (PROVIDER BY OTHER)
2 PROPOSED 2" WATER METER, SEE MARION COUNTY STANDARD DETAIL, SEE SHEET NO. C1.1
3 PROPOSED 4" PVC SANITARY SEWER, 18" DEPTH TO TOP OF PIPE
4 PROPOSED 4" PVC SANITARY SEWER, 18" DEPTH TO TOP OF PIPE

SANITARY SEWER LEGEND
1 CONNECT TO PROPOSED BUILDING BOTTOM W/VERT = 86.55
2 4" PVC CO
3 4" PVC SANITARY SEWER (RHR)R
4 CONNECT TO PROPOSED STUB OUT BY OTHERS WITH E. CO. & CHIMNEY CONNECTIONS PROPERTY OF OTHERS, SEE SHEET NO. C1.1 FOR DETAILS OF 4" PVC SANITARY SEWER
5 PROPOSED 4" PVC SANITARY SEWER USE BY OTHERS

UTILITY NOTES:
1. ALL UTILITIES SHALL BE PROTECTED AND MAINTAINED AT ALL TIMES. THE CONTRACTOR SHALL BE RESPONSIBLE FOR OBTAINING ALL NECESSARY PERMITS FROM THE MARION COUNTY ENGINEERING DEPARTMENT. THE CONTRACTOR SHALL BE RESPONSIBLE FOR OBTAINING ALL NECESSARY PERMITS FROM THE MARION COUNTY ENGINEERING DEPARTMENT. THE CONTRACTOR SHALL BE RESPONSIBLE FOR OBTAINING ALL NECESSARY PERMITS FROM THE MARION COUNTY ENGINEERING DEPARTMENT.

CONTRACTOR IS RESPONSIBLE FOR ADJUSTMENT OF EXISTING UTILITIES IF PROPOSED IMPROVEMENTS IMPACT EXISTING UTILITIES.
1. CONTRACTOR SHALL BE RESPONSIBLE FOR OBTAINING ALL NECESSARY PERMITS FROM THE MARION COUNTY ENGINEERING DEPARTMENT. THE CONTRACTOR SHALL BE RESPONSIBLE FOR OBTAINING ALL NECESSARY PERMITS FROM THE MARION COUNTY ENGINEERING DEPARTMENT. THE CONTRACTOR SHALL BE RESPONSIBLE FOR OBTAINING ALL NECESSARY PERMITS FROM THE MARION COUNTY ENGINEERING DEPARTMENT.

PHYSICAL HYDRANT - THE CONTRACTOR SHALL PROVIDE A HYDRANT AT THE LOCATION INDICATED BY THE UTILITY PLAN. THE CONTRACTOR SHALL BE RESPONSIBLE FOR OBTAINING ALL NECESSARY PERMITS FROM THE MARION COUNTY ENGINEERING DEPARTMENT. THE CONTRACTOR SHALL BE RESPONSIBLE FOR OBTAINING ALL NECESSARY PERMITS FROM THE MARION COUNTY ENGINEERING DEPARTMENT. THE CONTRACTOR SHALL BE RESPONSIBLE FOR OBTAINING ALL NECESSARY PERMITS FROM THE MARION COUNTY ENGINEERING DEPARTMENT.

End of County Maintenance is at the red lines. MCI does not own the easements.

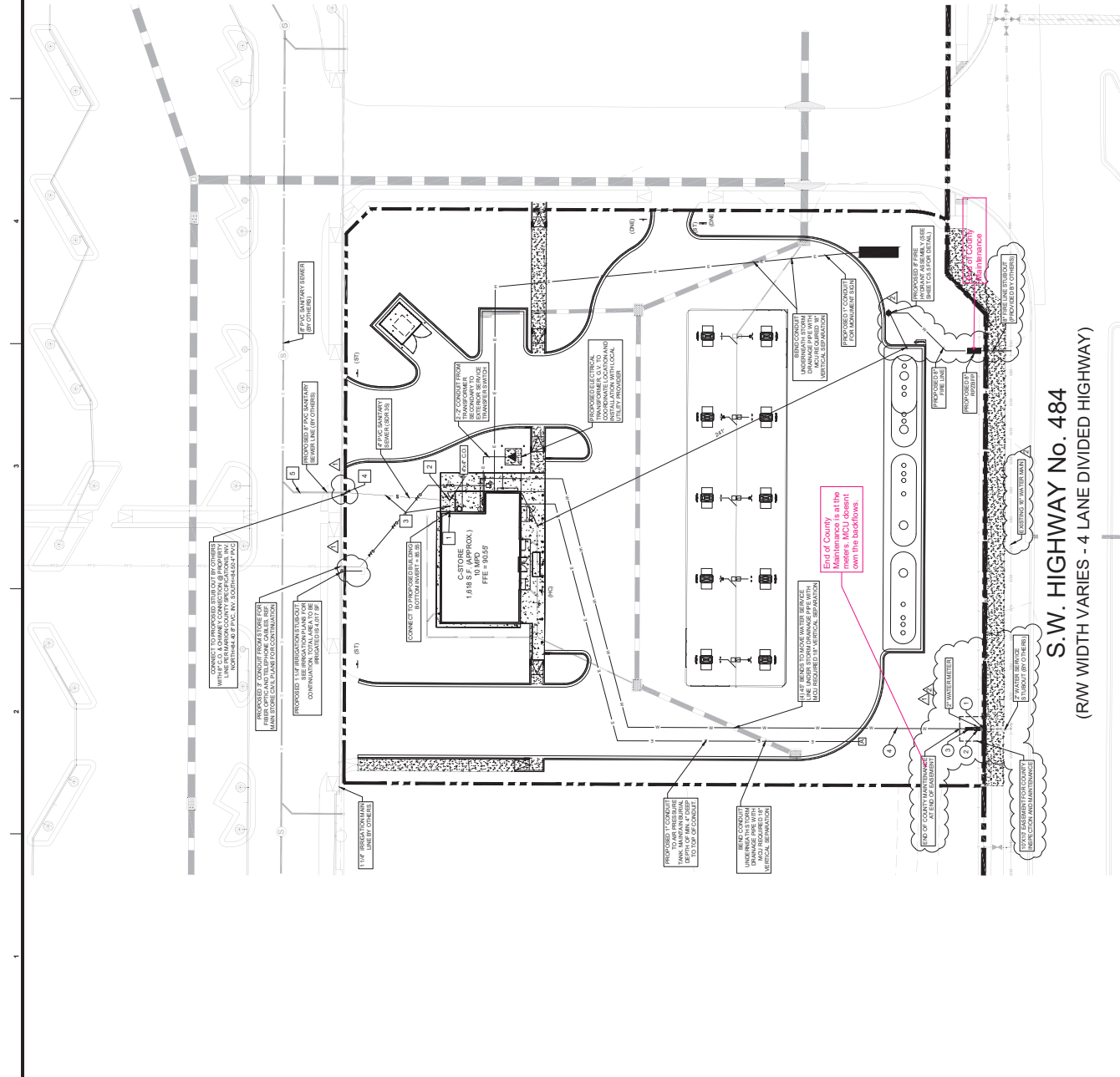

S.W. HIGHWAY No. 484
(RW WIDTH VARIES - 4 LANE DIVIDED HIGHWAY)

No.	Date	Revision
1	1/23/20	Issue

Checked: N. SHELTON
Drawn: P. SHEFFIELD
Date: 1/23/20

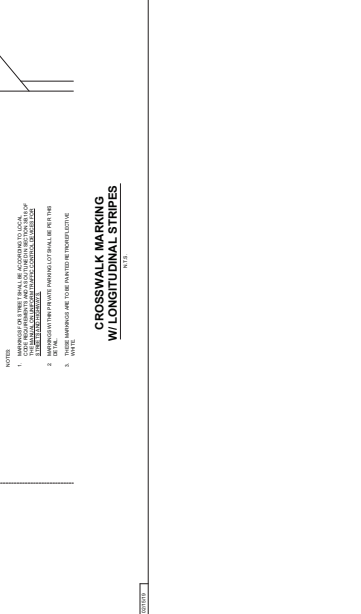
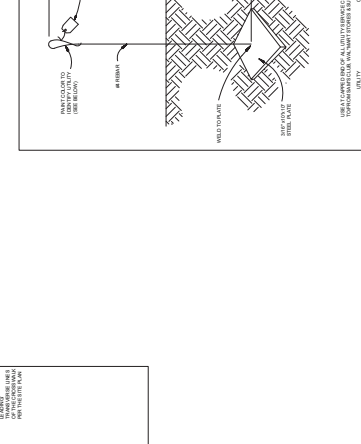
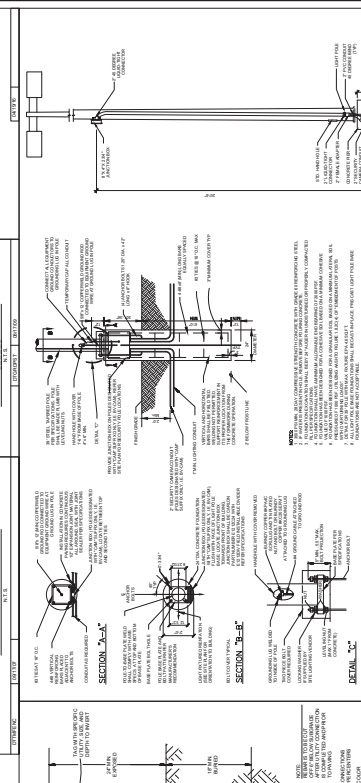
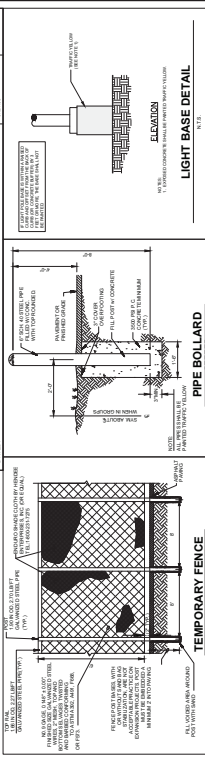
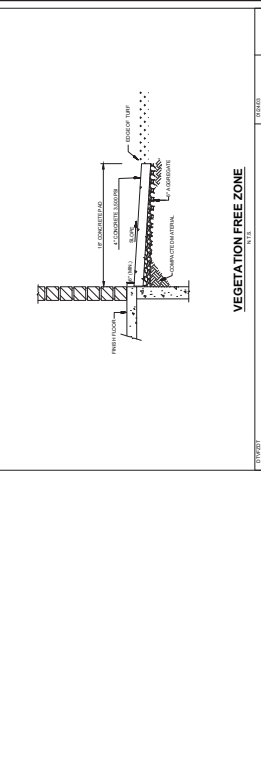
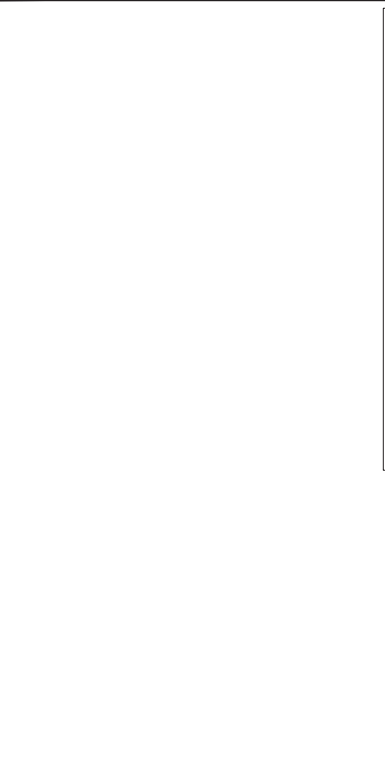
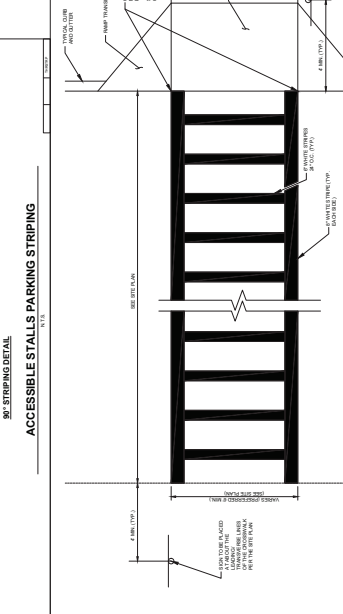
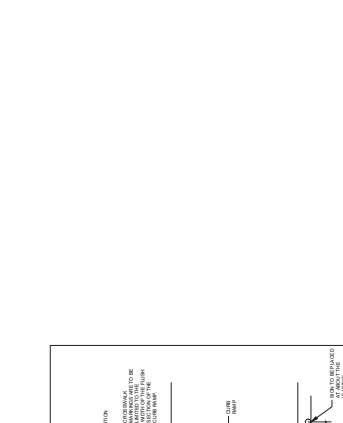
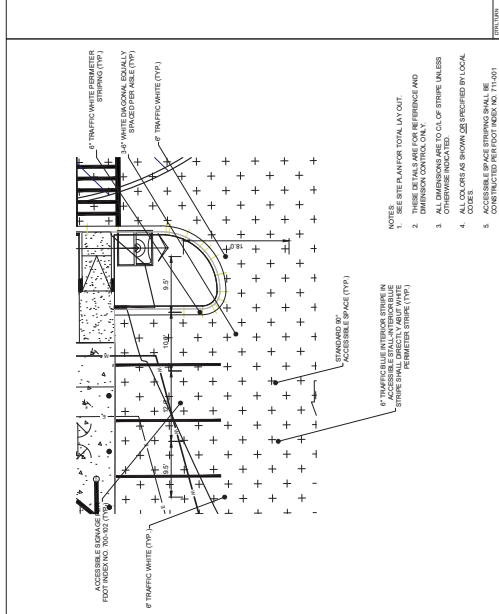
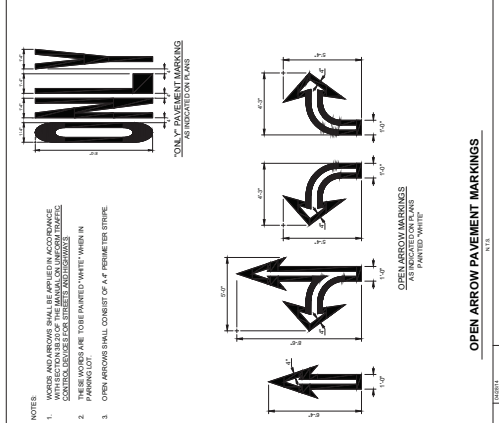

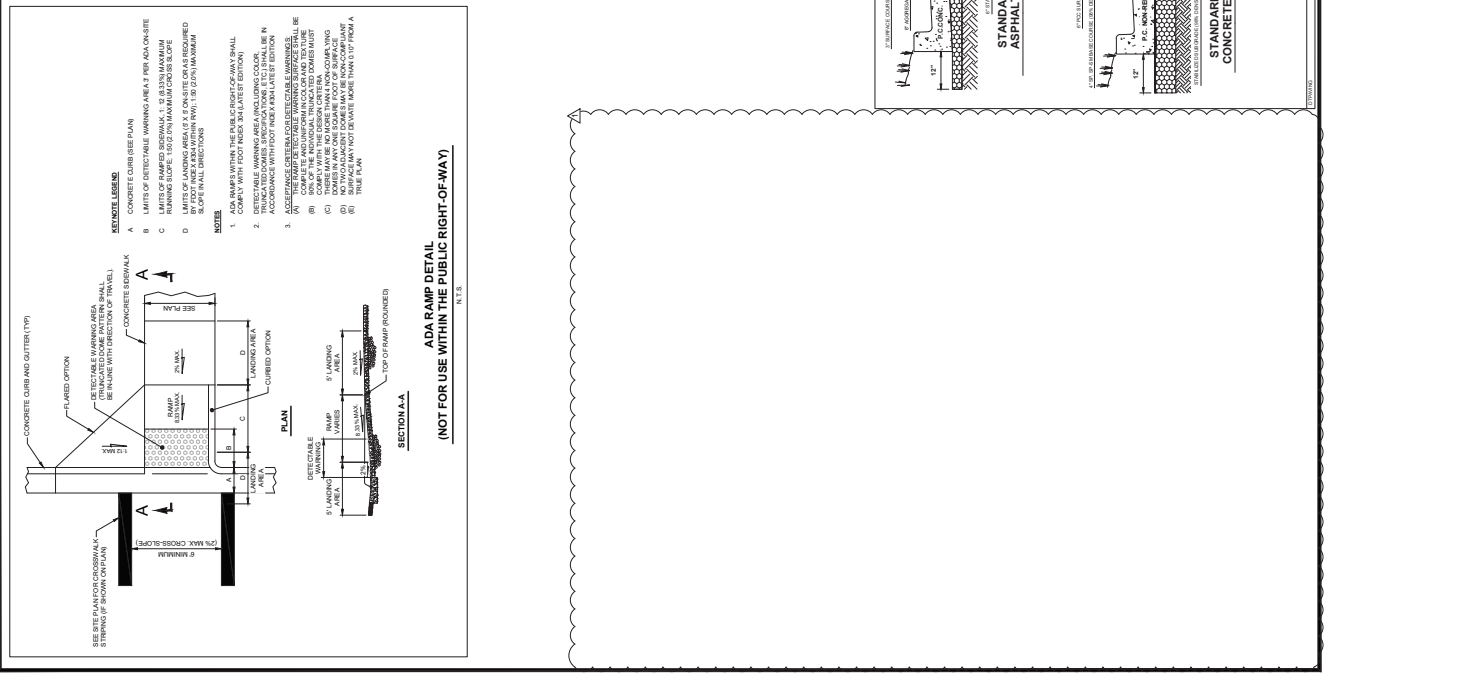
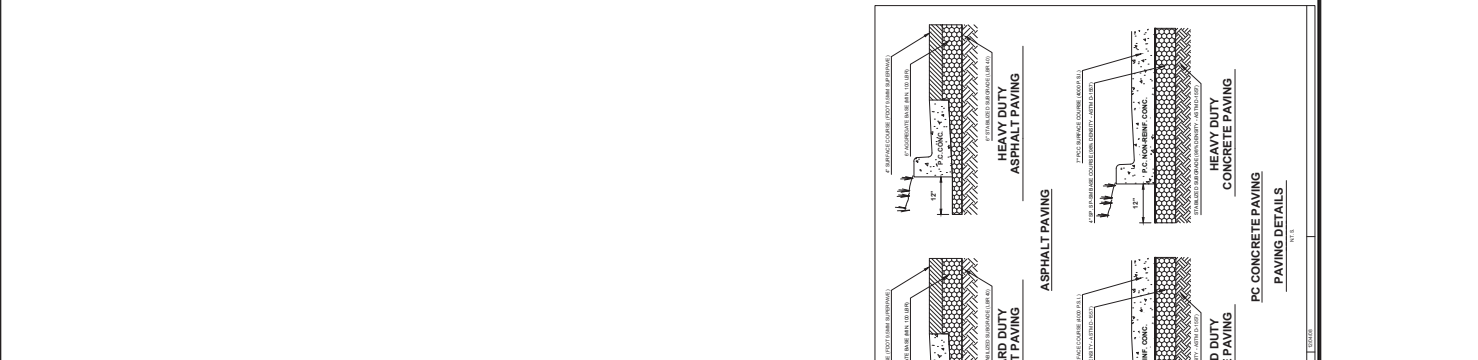
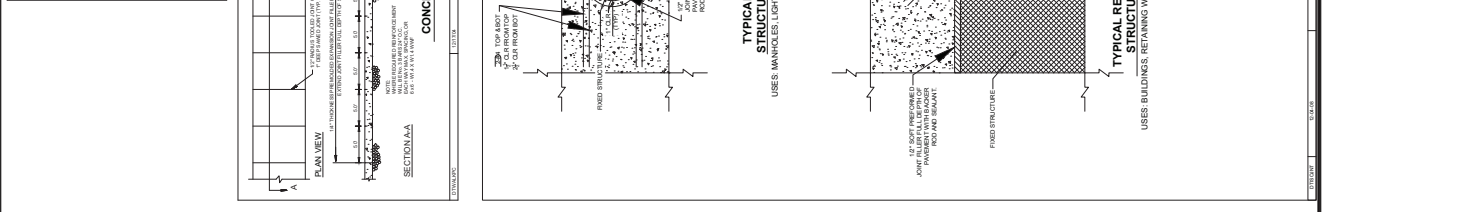
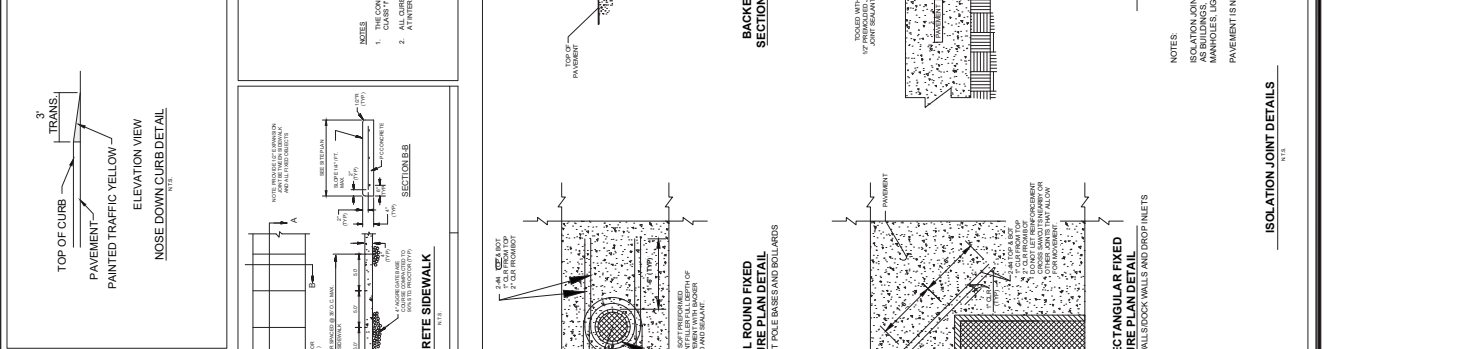
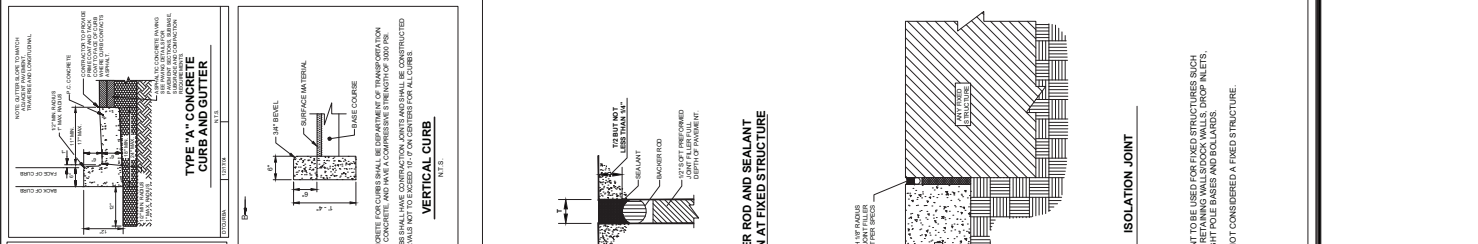
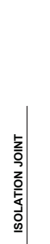
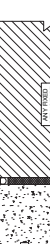
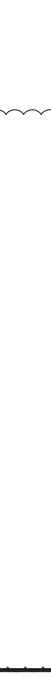
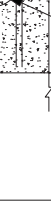
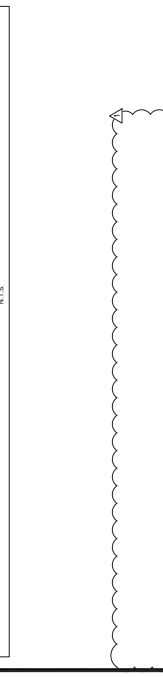
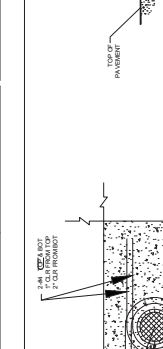
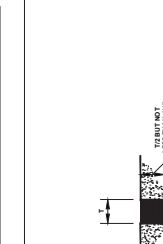
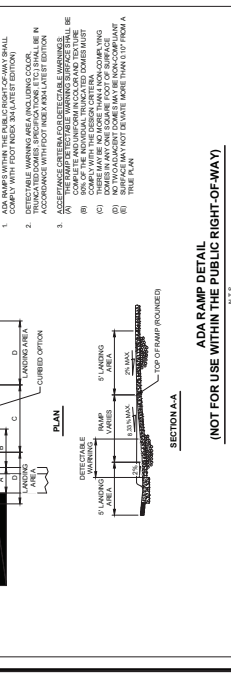
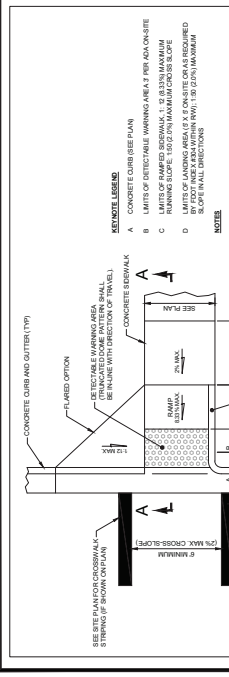
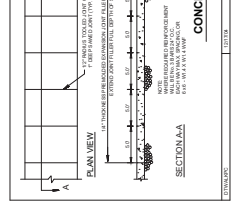
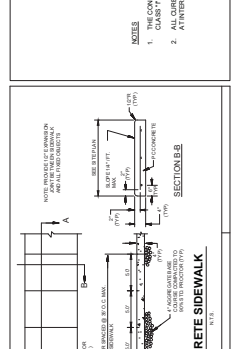
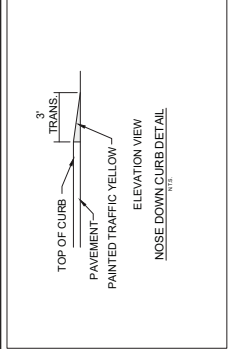
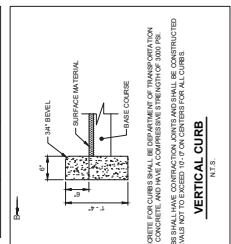
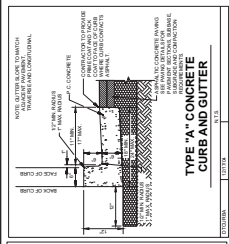

No.	Date	Revision
1		
2		
3		
4		
5		
6		
7		
8		
9		
10		

Checked: N. SHELTON
Drawn: P. SHEFFIELD
Date: 10/23/20

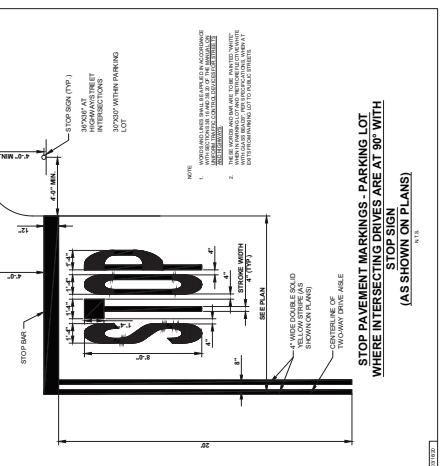
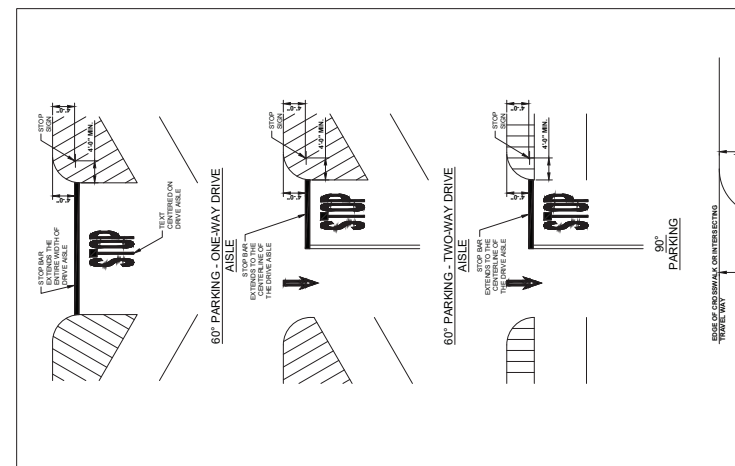
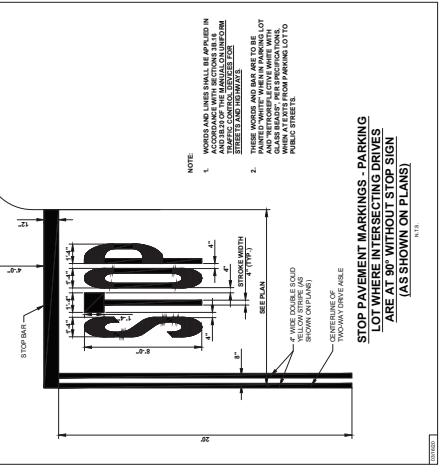
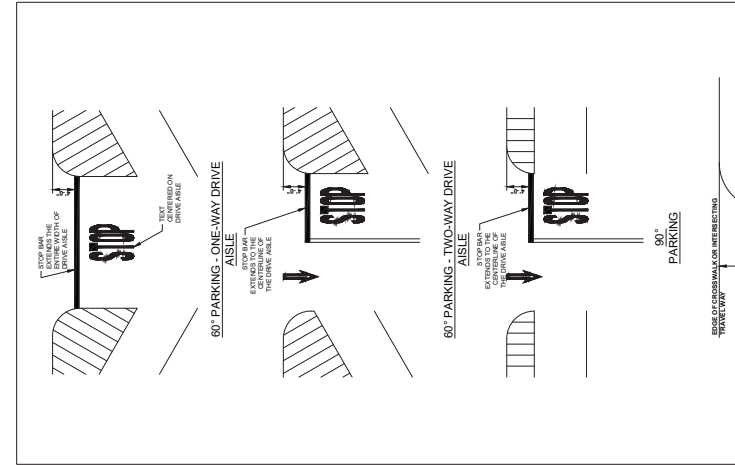
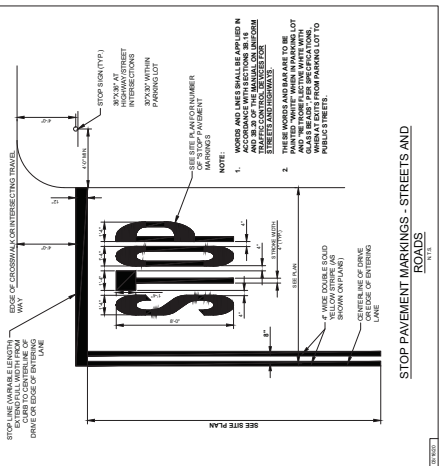
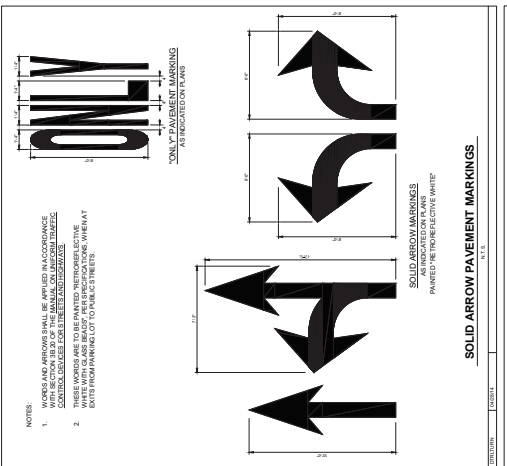
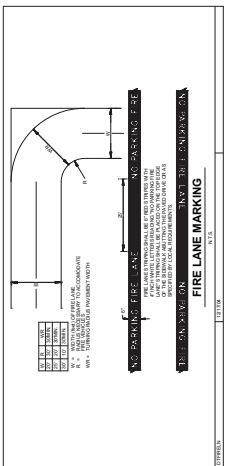

No.	Date	Revision
1		Initial Issue
2		Revised
3		Revised
4		Revised
5		Revised
6		Revised
7		Revised
8		Revised
9		Revised
10		Revised
11		Revised
12		Revised
13		Revised
14		Revised
15		Revised
16		Revised
17		Revised
18		Revised
19		Revised
20		Revised
21		Revised
22		Revised
23		Revised
24		Revised
25		Revised
26		Revised
27		Revised
28		Revised
29		Revised
30		Revised
31		Revised
32		Revised
33		Revised
34		Revised
35		Revised
36		Revised
37		Revised
38		Revised
39		Revised
40		Revised
41		Revised
42		Revised
43		Revised
44		Revised
45		Revised
46		Revised
47		Revised
48		Revised
49		Revised
50		Revised

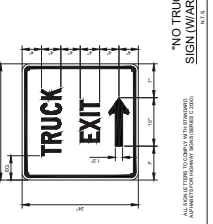
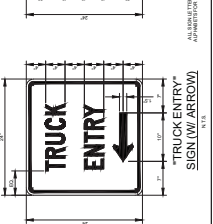
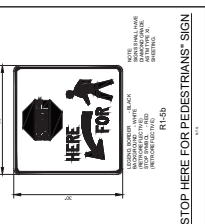
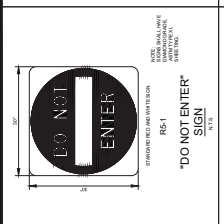
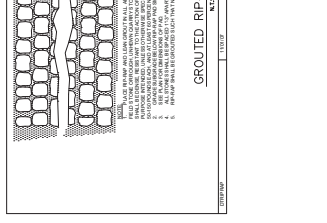
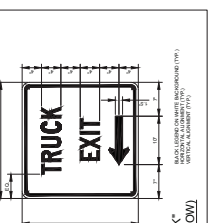
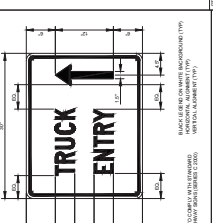
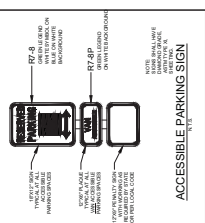
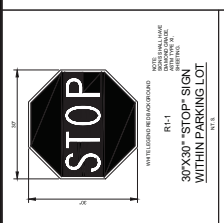
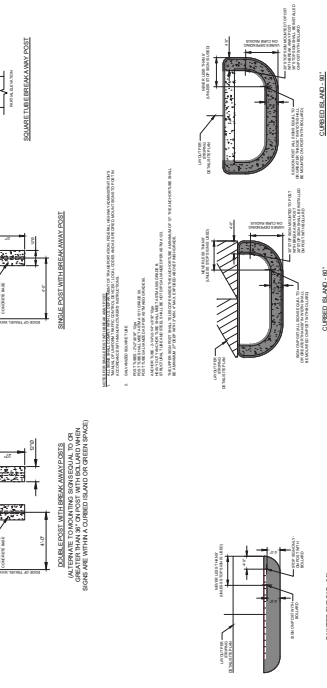
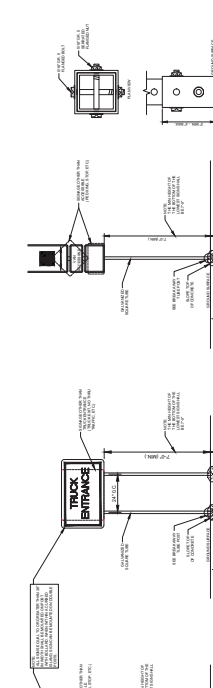
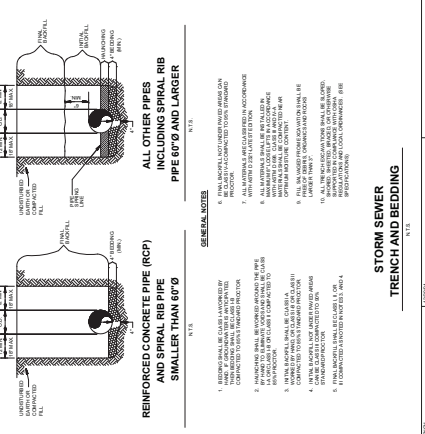
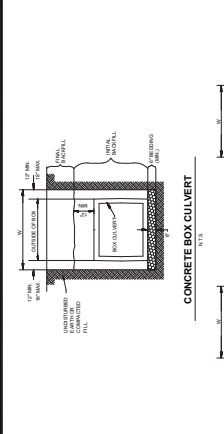
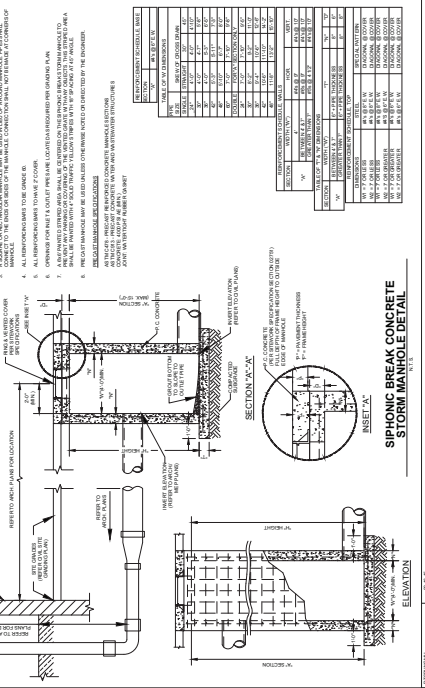
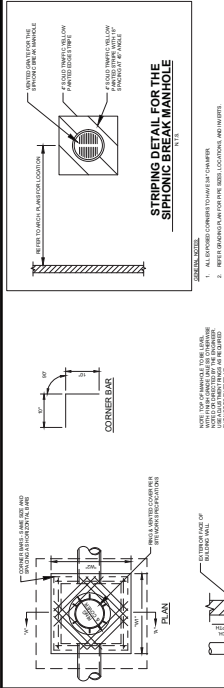



THIS SHEET IS NOT VALID FOR CONSTRUCTION UNLESS IT IS ACCOMPANIED BY THE COMPLETE SET OF PLANS.
THE USE OF THESE PLANS MAY BE SUBJECT TO LOCAL, STATE, FEDERAL, AND INTERNATIONAL REGULATIONS. THESE MUST BE CONSIDERED WHEN DETERMINING ANY REGULATORY PLANS FOR THE PURPOSE OF COLLECTING DATA.

Sheet No. **PH.1**

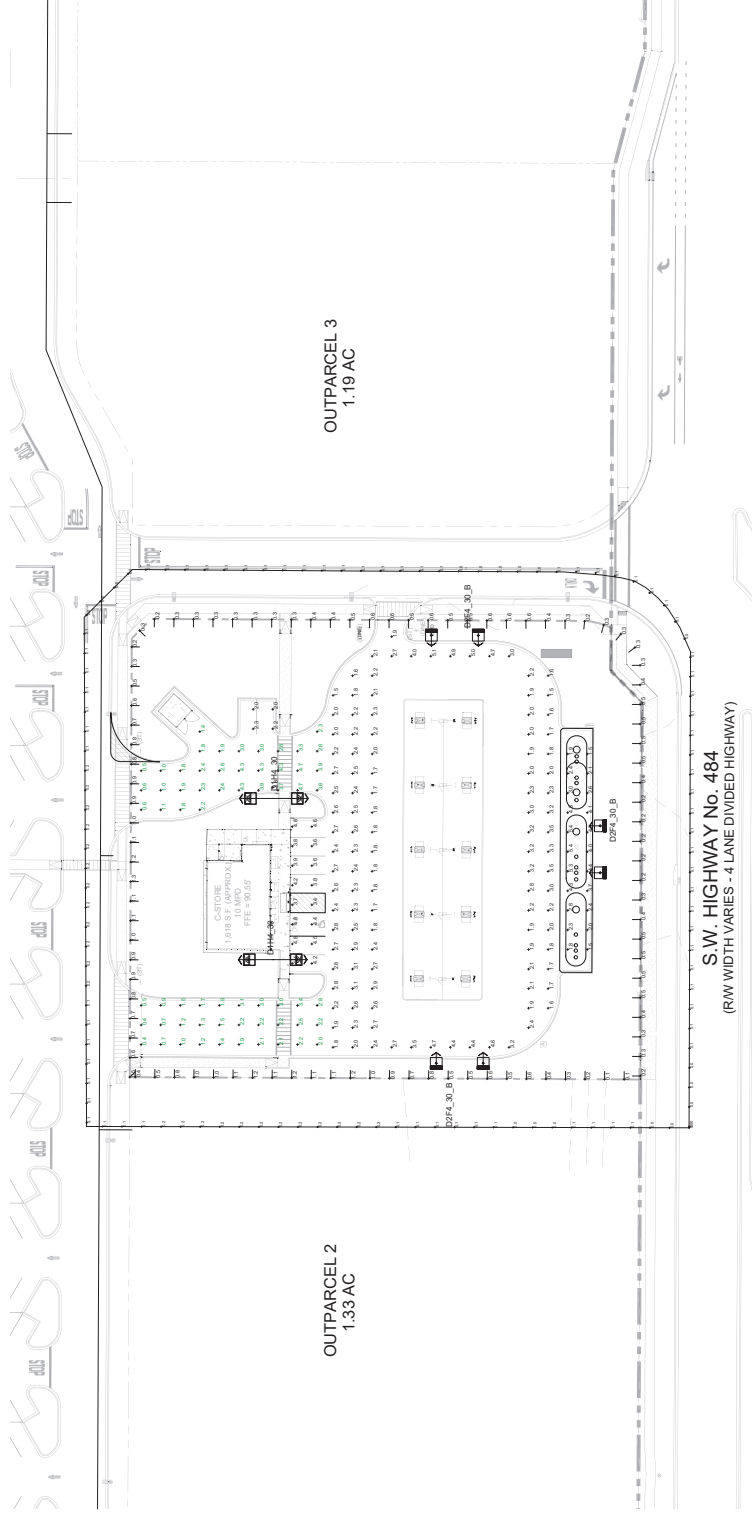
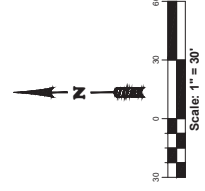

S.W. HIGHWAY No. 484
(R/W WIDTH VARIES - 4 LANE DIVIDED HIGHWAY)

Symbol	Qty	Label	Arrangement	LLF	Description	Ar. Watts	Ar. Lum. Lumens	BUG Rating
↑	3	D2F4_30_B	ROTATED OPTICS	0.837	1-EALS035F4AF750NDD1BLCKFS1 & 1-EALS035F4AF750NDD1BLCKFS2 w/ 2-ELS-EAL-RBL-BLCK 27ft pole on 3ft base	232	26800	B-1J0-G2
⊞	2	D1H4_30	Back-Back	0.837	2-EALS035H4AF750NDD1BLCKF 27ft pole on 3ft base	280	40000	B-3J0-G3

Calculation Summary Illuminance Foot-candles

Label	Avg	Max	Min	Avg/Min	Max/Min	# Pits
Fuel Area	2.63	5.4	1.5	1.75	3.60	134
Fuel Entry Drives	2.22	4.7	0.4	5.55	11.75	63
Fuel Parking	3.75	4.8	2.0	1.88	2.40	21
Spill City 25ft within at grade	0.10	0.2	0.0	N/A	N/A	116
Vert 3ft Prop. Line	0.57	1.3	0.1	5.70	15.00	98