

**Public Notification for: LAND USE AMENDMENT AND  
ZONING CHANGE**

**Marion County Growth Services Planning & Zoning (352) 438-2675**

**25-S07  
250605ZP**

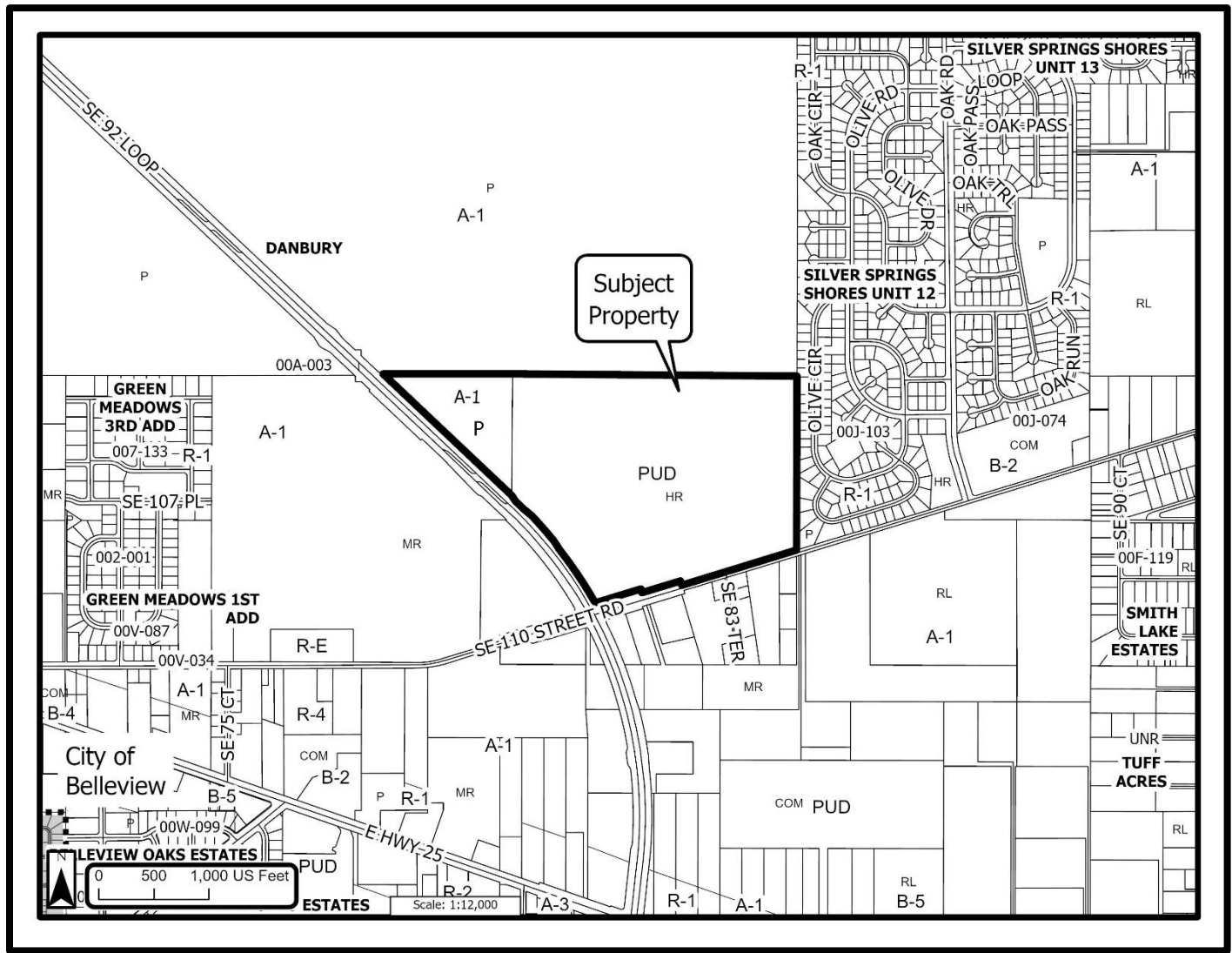

<b>First Public Hearing:</b> Planning & Zoning Commission <b>05/28/2025 @ 5:30 p.m.</b>	<b>Owner(s):</b>	Sandy Clay, LLC
	<b>Agent(s):</b>	Tillman & Associates Engineering, LLC
	<b>Location:</b>	No Address Assigned
<b>Second Public Hearing:</b> Board of County Commissioners <b>TBD</b>	<b>Parcels(s):</b>	37896+000-01 & 37896-000-00
	<b>Zone(s):</b>	A-1 (General Agriculture) & PUD (Planned Unit Development)
	<b>Acre(s):</b>	± 119.75

**Public Hearing Location:** 601 SE 25<sup>th</sup> Avenue, Ocala, FL 34471 - McPherson Governmental Campus Auditorium

**Request Description(s):**

- 1) Small-Scale Future Land Use Map Amendment from Public (P) to Medium Residential (MR) on ±15.52 Acres and
- 2) Zoning Change from General Agriculture (A-1) to Planned Unit Development (PUD) on ±15.52 Acres and to amend a previously approved PUD to be solely for detached single-family dwellings (up to 442 dwellings).

**FLUM key:** P= Public, MR= Medium Residential RL= Rural Land.

*You are receiving this notification because you own property that is located within 300' of the subject parcel(s)*  
**If you have any questions, please call (352) 438-2675**

All provided GIS data is to be considered a generalized spatial representation, which is subject to revisions. The feature boundaries are not to be used to establish legal boundaries. For specific visual information, contact the appropriate county department or agency. The information is provided as a visual representation only and is not intended to be used as a legal or official representation of legal boundaries.

