

February 28, 2025

PROJECT NAME: DELUCIA RESIDENCE POOL

PROJECT NUMBER: 2025020046

APPLICATION: DRC WAIVER REQUEST #32501

1 DEPARTMENT: FRMSH - FIRE MARSHAL REVIEW

REVIEW ITEM: LDC 2.21.1.A(1) - Major Site Plan

STATUS OF REVIEW: INFO

REMARKS: APPROVED

2 DEPARTMENT: LUCURR - LAND USE CURRENT REVIEW

REVIEW ITEM: LDC 2.21.1.A(1) - Major Site Plan

STATUS OF REVIEW: INFO

REMARKS: Defer to Stormwater.

3 DEPARTMENT: ZONE - ZONING DEPARTMENT

REVIEW ITEM: LDC 2.21.1.A(1) - Major Site Plan

STATUS OF REVIEW: INFO

REMARKS: Defer to Stormwater.

4 DEPARTMENT: ENGDRN - STORMWATER REVIEW

REVIEW ITEM: LDC 2.21.1.A(1) - Major Site Plan

STATUS OF REVIEW: INFO

REMARKS: APPROVED. The HOA/POA (O&M Entity) has provided a letter accepting the additional runoff in excess of 107 sf (design impervious) into their subdivision's Master Stormwater System. Signed letter was submitted with the waiver request.

Note: The applicant owns a 0.19-acre lot (PID 6016-020-025) in the SPRUCE CREEK SOUTH XVI subdivision. There is 2,493 sf existing impervious coverage on the site. The project proposes to add 510 sf of impervious coverage. The SPRUCE CREEK SOUTH XVI subdivision assumes 2,896 sf (35%) impervious coverage per lot. Staff recommends approval with O&M Entity's acknowledgement and acceptance of the additional runoff to their system.



**Marion County  
Board of County Commissioners**

Office of the County Engineer

412 SE 25th Ave.  
Ocala, FL 34471  
Phone: 352-671-8686  
Fax: 352-671-8687

**AR 32501**

**DEVELOPMENT REVIEW COMMITTEE WAIVER REQUEST FORM**

Date: 02/06/2025 Parcel Number(s): 6016-020-025 Permit Number: 2025013014

**A. PROJECT INFORMATION:** Fill in below as applicable:

Project Name: DELUCIA RESIDENCE POOL Commercial ☐ Residential ☒  
Subdivision Name (if applicable): SPRUCE CREEK SOUTH  
Unit N/A Block T Lot 25 Tract \_\_\_\_\_

**B. PROPERTY OWNER'S AUTHORIZATION:** The property owner's signature authorizes the applicant to act on the owner's behalf for this waiver request. The signature may be obtained by email, fax, scan, a letter from the property owner, or original signature below.

Name (print): ALFRED AND JULIANNE DELUCIA  
Signature: *Alfred Delucia*  
Mailing Address: 9382 SE 174TH LOOP City: SUMMERFIELD  
State: FL Zip Code: 34491 Phone # 706-212-8122  
Email address: N/A

**C. APPLICANT INFORMATION:** The applicant will be the point of contact during this waiver process and will receive all correspondence.

Firm Name (if applicable): YANDLE'S SPLASH TIME POOLS Contact Name: ASHLEY BROWNING  
Mailing Address: 7282 ASPEN AVE City: OCALA  
State: FL Zip Code: 34480 Phone # 352-694-5900  
Email address: SPLASHTIME0614@AOL.COM

**D. WAIVER INFORMATION:**

Section & Title of Code (be specific): 2.21.1.A Major Site Plan  
Reason/Justification for Request (be specific): SPRUCE CREEK SOUTH ALLOWS 2875 SF PER LOT, THE HOME ALREADY PUTS THE IMPERVIOUS AT 2493 SF. ADDING THE POOL WILL ADD ANOTHER 510 SF TO THE LOT. PLEASE SEE ATTACHED HOA APPROVAL FOR THE ADDITIONAL WATER RUN OFF.

**DEVELOPMENT REVIEW USE:**

Received By: Email Date Processed: 2/19/25 BM Project # 2025020046 AR # 32501

2/12/25

**ZONING USE:** Parcel of record: Yes ☐ No ☐ Eligible to apply for Family Division: Yes ☐ No ☐

Zoned: \_\_\_\_\_ ESOZ: \_\_\_\_\_ P.O.M. \_\_\_\_\_ Land Use: \_\_\_\_\_ Plat Vacation Required: Yes ☐ No ☐

Date Reviewed: \_\_\_\_\_ Verified by (print & initial): \_\_\_\_\_

Applicant Name (Owner): ALFRED AND JULIANNE DELUCIA  
Parcel ID (lot): 6016-020-025  
Site Address: 9382 SE 174TH LOOP SUMMERFIELD FL 34491  
Subdivision: Spruce Creek South  
Marion County Building Permit Application No. (if available): 2025013014  
Waiver Application Request No. (if available): TBD

SW-1

**ACKNOWLEDGEMENT AND ACCEPTANCE OF ADDITIONAL STORMWATER / LETTER OF NO OBJECTION**

The above referenced project is within the Spruce Creek South subdivision, which has a privately-maintained stormwater management system. This stormwater management system is operated and maintained by the SPRUCE CREEK DEVELOPMENT CO OF OCALA INC (name of maintenance entity). The subdivision Improvement Plans (AR# \_\_\_\_\_) on file at the County show the stormwater facilities to be sufficient to accommodate the stormwater runoff from the 100 year-24 hour storm ☒ based on 2,875 (30%) square feet impervious coverage per lot. The above referenced lot currently has 2493 square feet impervious coverage and the proposed project will add 510 square feet impervious coverage.

ALFRED / JULIANNE DELUCIA

Owner Name (Print)

Alfred Delucia 2/8/2025  
Owner Signature Date

**MASTER PERMITEE: PLEASE SELECT ONE OPTION FROM BELOW AND SIGN TO INDICATE YOUR APPROVAL**

- ☒ By signing below, I affirm that the above referenced project has been duly reviewed and HOA agrees to accept the additional stormwater runoff indicated to the permitted stormwater management system.
- ☐ By signing below, I affirm that the above referenced project has been duly reviewed by the HOA and the HOA does not accept the additional stormwater runoff indicated to the permitted stormwater management system. Construction may proceed with NO OBJECTION and it is understood that the Owner will need to construct stormwater controls on-site to address the excess impervious coverage.

POA

James Day  
Representative (Print)

POA

James Day 3/10/25  
Representative Signature Date

HOA/ POA/ DEVELOPER Contact Information:

HOA/ POA/ DEVELOPER Name: Kenneth Kirkpatrick  
Address: P.O. Box - 2495, Ocala FL 34478  
Phone: 352-482-0777  
Email: \_\_\_\_\_



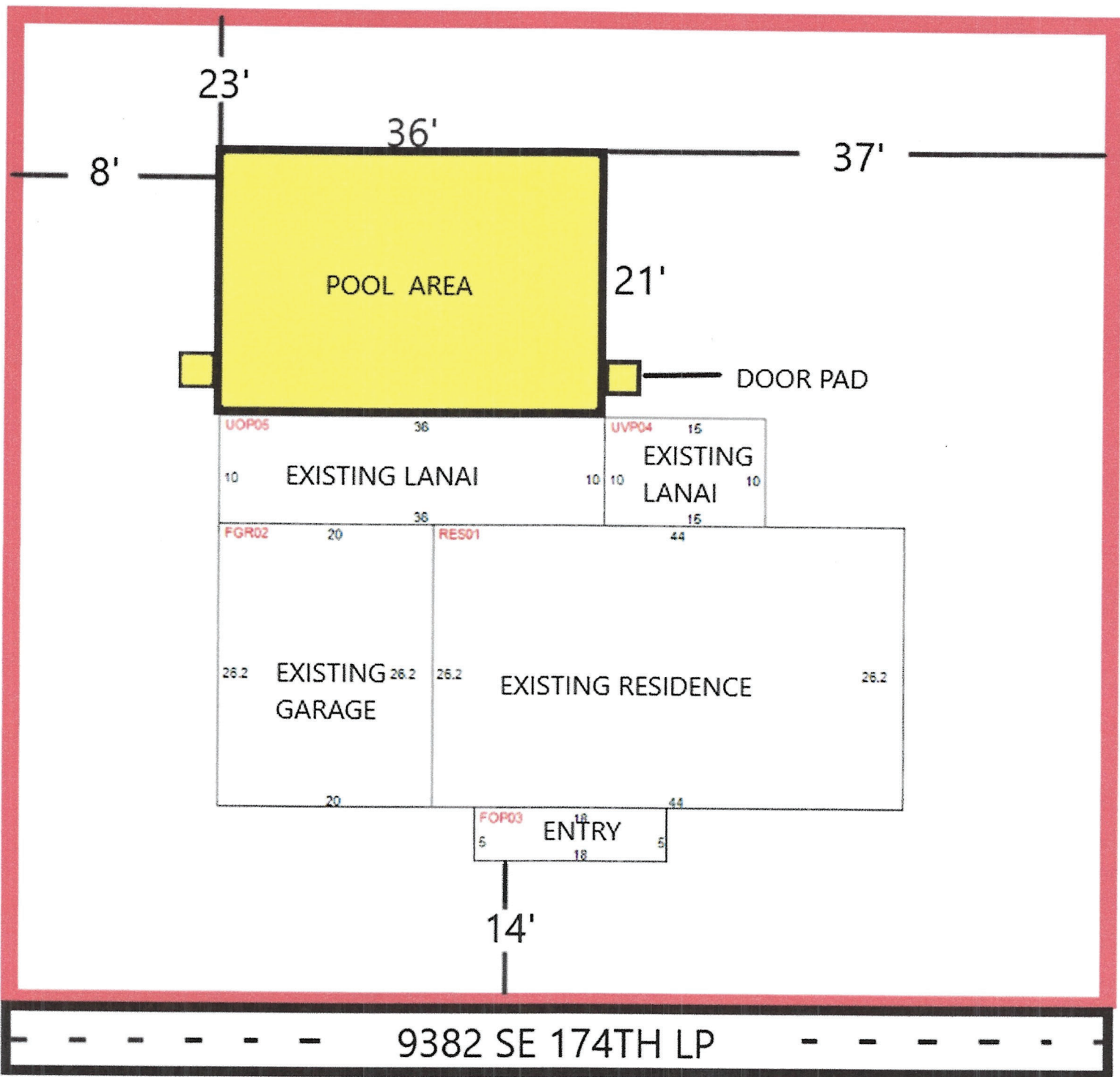

# **DELUCIA 9382 SE 174TH LOOP, SUMMERFIELD, FL 34491 706-212-8122**

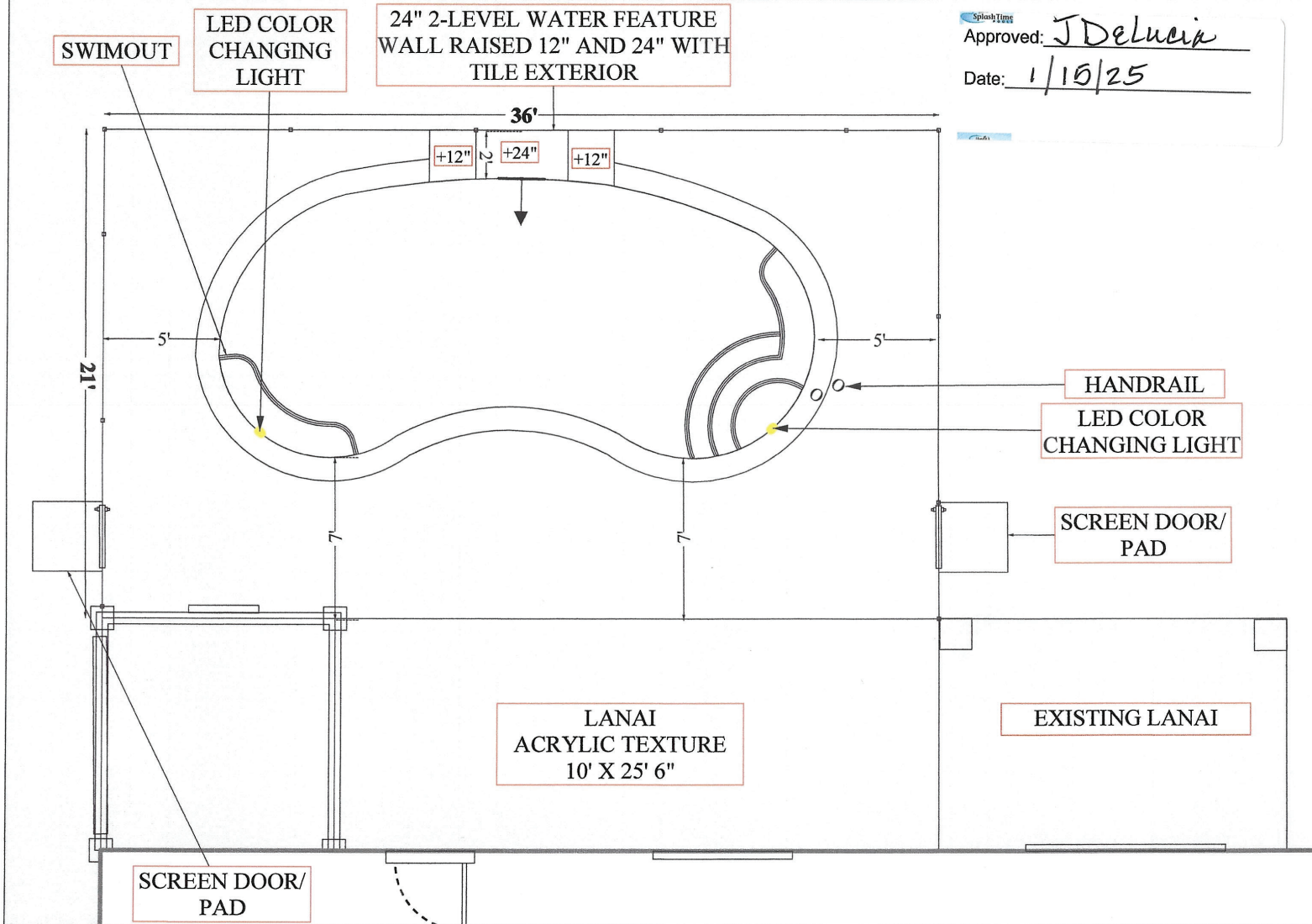

SplashTing  
Approved: J Delucia  
Date: 1/15/25

## **POOL SPECIFICATIONS**

TYPE CONSTRUCTION: **SHOTCRETE**

MODEL/SHAPE: **KIDNEY**

LENGTH: **26'**

WIDTH: **12'**

Depth: **3' - 5'**

TILE WATERLINE: **AMZ-6603**

TILE DECO:

TILE TRIM: **SAPPHIRE SMOOTH**

DECK: **3000 PSI CONCRETE**

**510 SQ FT**

CANTILEVER: **YES**

BRICK COPING:: **NO**

TOPPING: **ACRYLIC**

TOPPING S.F.: **765 SQ FT**

COLOR: **OCEAN SAND**

BORDER: **MOCCA**

EQUIPMENT:

PUMP/HP: **STA RITE VARIABLE SPEED**

FILTER: **STA RITE CARTRIDGE**

LIGHT: **PENTAIR MICROBRITE (2)**

CHLORINATOR: **INTELLICHLOR**

AUTOMATIC CLEANER: **PENTAIR DORADO**

HANDRAIL: **YES - BEIGE** ★ CONSULT WITH HOMEOWNER ON PLACEMENT

SWIMOUT: **YES**

INTERIOR FINISH: **SUPER BLUE**

SCREEN ENCLOSURE:

ROOF LINE: **MANSARD**

COLOR: **BRONZE**

DOORS: **2**

WALL HEIGHT: **8'**

MISC: **2 LEVEL - 24" WATER CURTAIN RAISED 12" AND 24" WITH TILE EXTERIOR**

**ULTRATEMP 120K HP HEATER**

**4" X 4" LOGGERHEAD TURTLE BLUE MOSAIC ON FIRST STEP (3)**

**15" X 15" LOGGERHEAD TURTLE BLUE MOSAIC IN DEEP END (1)**